

GPX 84

AC / DC - Power electronic Capacitors

CHARACTERISTICS

Rated Capacitance / Tolerance	50 ±10%	µF
Rated RMS Voltage (Urms)	450	V
Rated AC Voltage (Un _{AC})	630	V
Rated DC Voltage (Un _{DC})	850	V
Maximum Current (Imax) @50°C	45	A
<i>See diagram n. 1 on page 2, for Imax derating versus ambient temperature</i>		
Self-inductance	150	nH
Series resistance (R _S)	4,8	mΩ @1KHz
Thermal resistance (R _{th})	2,1	°C/W
Typical tan d (10E-4)	<6	(Measure @ 50Hz)

Filler material	Polyurethane Resin
Dielectric	PPM Film
Over pressure safety device	10.000 AFC - Protected

Aluminium case	
Weight	≤ 490 g

MAXIMUM RATINGS

Max. RMS voltage (30% time)	1,1xUn	V
Non-recurrent surge voltage (Us)	1600	V
Maximum peak current (I _{PK})	2	kA
Max. Voltage raise of rise (dV/dt)	40	V/µs
Maximum surge current (Is)	6	kA

TEST DATA

DC Test voltage terminal to terminal	1.5xUn _{DC} x10s	V
AC test voltage terminal to case	3kV x10 s	V - 50Hz

CLIMATIC CATEGORY

Min.operating temperature (θ _{MIN})	-40	°C
Max. amb. temperature (θ _{a-max})	+70	°C
Storage temperature	-40 +85	°C
Altitude maximum	2000m	a.s.l.

FIT	50
Expected life (Ln)	120.000 h @ Un / 70°C Hot spot

APPROVAL / STANDARDS

EN 61071-1/2

Total elongation is about 20 mm after the overpressure disconnecter release. Don't use rigid connections.

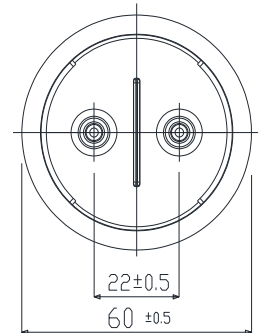
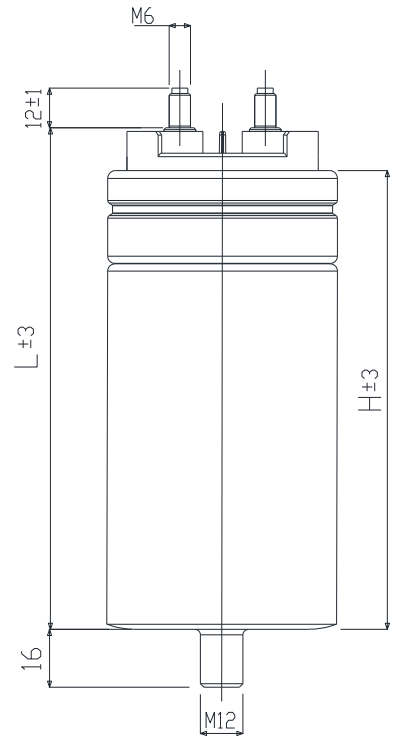

L [mm]	H [mm]
161	145

Maximum Fixing Torque for M6 terminals	3[Nm]
Fixing Stud Maximum Fixing Torque	M12 10 [Nm]

Release	Date	Description	Technician
-	02/04/2020	1 st Issue	E. P.
A	05/05/2020	Modificate quote H ed L	E. P.



DUCATI energia

CAPACITOR for

POWER ELECTRONIC
- GENERAL PURPOSE APPLICATIONS -

$C_n = 50\mu\text{F}$ $U_{rms}=450\text{ V}$

Part. Number: **416.84H.4185**

PAG. 2/2

GPX 84

AC / DC - Power electronic Capacitors

RMS working current vs Ambient temperature

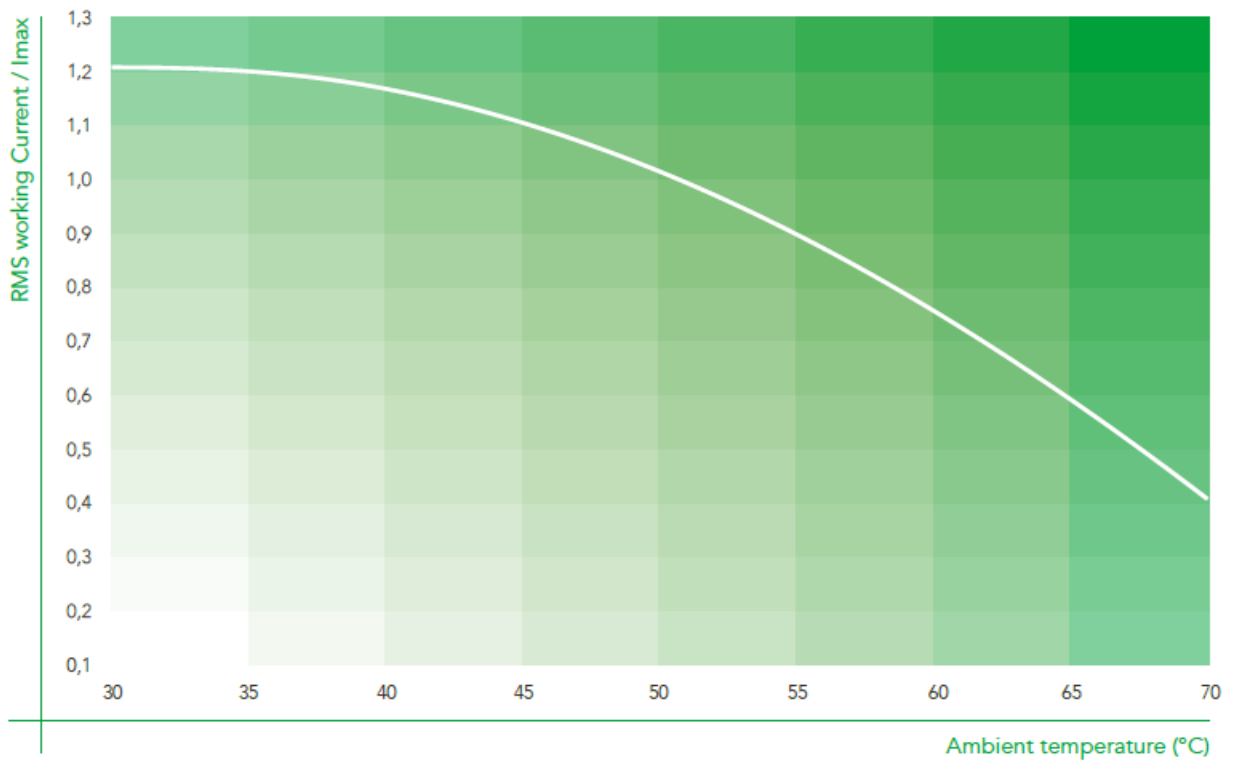

Release	Date	Description	Technician
-	02/04/2020	1 st Issue	E. P.
A	05/05/2020	Modificate quote H ed L	E. P.