

开关电源简述

◆ 关于开关电源

狭义的说，开关电源是交流或直流输入、直流输出的稳压电源；用字符AC/DC、DC/DC表示，具有体积小、效率高、输出电压稳定、使用寿命长等特点，使用日益广泛。

◆ 开关电源的选购

1、单路输出

输出电压确定后再确定功率，本公司产品功率从10W~1500W，有100多种外形，上千种产品，电压输出从3V~220VDC之间任一电压可供选择。假若需使用24V、1A的电源，可选用S-25-24，假若成本允许的话，可以保留10%~20%的功率裕量。

2、多路输出

多路输出的电源分主、次回路输出。主回路输出特性优于次回路，一般情况，输出电流大的为主回路，为保证输出负载调整率等指标，要求每路至少带一定的负载，若只使用次回路不用主回路，那么主回路一定要加载相匹配的假负载。(0.5A以上或更大)

3、客户选购开关电源时可以提供具体型号，最好的办法是提供具体参数，如输入220VAC、输出24VDC、5A。如输入是直流电压(如48VDC、110VDC、220VDC等)，请在订货时说明。

4、选购开关电源时，应当清楚使用环境，如温度、湿度、海拔高度等。

◆ 开关电源的使用

1、使用电源前先确认输入电压规格(110V/220V/380V)与将要安装使用的电源的输入电压标称值是否一致。国内使用的产品，主要输入220VAC，故而有110V/220V可供选择，一般情况下，选择开关都置于220VAC位置，请客户使用时多注意。

2、严格按照图纸接线，通电前先检查输入输出电线连接是否正确，以免损坏用户设备。

3、请注意输入输出线能否满足所要使用的功率，一般情况下，输出铜线线径是1mm²，那么通电电流为4安培，输出线线径为1.5mm²，那么通电电流能达到6安培，即线径平均方数乘以4安培，等于输出通电电流数，以此类推。假若输出电线载流量不够，那么输出电压降会很大，直接影响使用，此时若调高输出电压值会增大输出功率，容易损坏电源。

4、开关电源的防水问题

一般情况下，基板式(板式)开关电源不防水，故而不能溅到或浸泡水或油等。否则电源会出故障。如果电源安装在户外，请客户要配有防水机箱，本公司可以为用户介绍各种防水机箱(需另购，尺寸由客户提供)。防水型开关电源可以直接安装在户外。

◆ 开关电源的安装

请使用合适的螺钉，将电源固定到合适的环境中，螺钉长度应小于6mm，不能顶到电路板上，以免碰触内部元件发生导电危险。电源工作空间要有通风通道或排风设备；为保证使用的安全性和减少干扰，请确保接地线有良好的接地，接地线大于AWG1#。安装完毕后，请测量外壳与输入、输出端的绝缘电阻，以免触电。

◆ 问答题

1、使用本公司的开关电源，发现外壳带有电压，这正常吗？

答：正常。由于EMI上的要求，使得输入端与外壳由电容连接，使得外壳带有电压，对此IEC6950中有明确规范，漏电流<3.5mA，不会对人体有任何伤害，是安全的。

2、需要24V电压，可手头只有12V电源，可否使用2个12V串联？

答：可以串联使用，在某种时候，使用此方法可以降低成本。

3、可否利用S-50W作为电池充电电源使用？

答：可以。但是需防止电池电压反馈，建议于输出端串联一只二极管，但需注意二极管的散热。

4、为何电源无法正常开机？

答：可能负载是电机、灯泡或容性负载，当开机瞬间电流过大造成过载保护，遇到此点，请在选购适当大些功率或与厂方联系。



概述 Summary

- > 单组输出；功率30W
Single output: power 30W
- > 输入电压：85~264VAC 120~370VDC
Input voltage: 85~264VAC 120~370VDC

常见规格 General Specification

78 × 93 × 56mm

性能 Specification	型号 Model	DR-30-5	DR-30-12	DR-30-15	DR-30-24
直流输出电压、电流 DC output voltage, current		5V 0~3A	12V 0~2A	15V 0~2A	24V 0~1.5A
纹波及噪音 Wave and noise		80mVp-p	120mVp-p	120mVp-p	150mVp-p
进线稳定度 Inlet wire stability		±0.5%	±0.5%	±0.5%	±0.5%
负载稳定度 Load stability		±1%	±0.5%	±0.5%	±0.5%
效率 Efficiency		74%	81%	82%	83%
直流电压可调范围 Adjustable range for DC voltage		±10%	±10%	±10%	±10%
输入电压范围 Input voltage range		85~264VAC 120~370VDC 47~63Hz			
冲击电流 Impact current		冷启动电流 Cold start current 15A/115VAC 30A/230VAC			
过载保护 Overload protection		105%~160%切断输出，自动恢复 105%~160% cut off the output, automatic recovery			
过电压保护 Over voltage protection		115%~135%关闭输出，电源重启后可恢复输出 115%~135% shut down O/P voltage, re-power on to recover			
启动、上升、保持时间 Setup, rise, hold up time		800ms, 60ms, 50ms/230VAC 满载 at full load			
耐压性 Withstand voltage		输入输出间: 1.5kV 输入与外壳间: 1.5kV 输出与外壳间: 0.5kV 一分钟 I/P-O/P: 1.5kV I/P-FG: 1.5kV O/P-FG: 0.5kV 1minute			
隔离电阻 Isolation resistance		输入输出间 输入与外壳间 输出与外壳间: 500VDC/100MΩ I/P-O/P I/P-FG O/P-FG: 500VDC/100MΩ			
工作温度 Working temperature		-10°C ~ +50°C			
尺寸 Dimension		78 × 93 × 56mm			
重量 Weight		0.27kg			
包装 Packing		43 × 32 × 21.5CM/45PCS/12.5kg			

外形尺寸 Overall dimension(mm)

接线位置

- 端口 1,2: 交流输入
- 端口 3,4: 直流输出+V
- 端口 5,6: 直流输出-V

Terminal Pin No. Assignment

- Pin 1,2: AC input
- Pin 3,4: DC output+V
- Pin 5,6: DC output-V

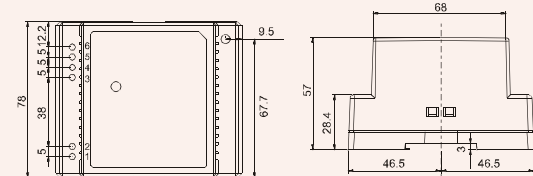

DR-45W单组输出导轨电源
DR-45W Single output DIN rail power supply

概述 Summary

- > 单组输出; 功率45W
Single output: power 45W
- > 输入电压: 85 ~ 264VAC 120 ~ 370VDC
Input voltage: 85 ~ 264VAC 120 ~ 370VDC



常见规格 General Specification

78 × 93 × 56mm

性能 Specification	型号 Model	DR-45-5	DR-45-12	DR-45-15	DR-45-24
直流输出电压、电流 DC output voltage, current		5V 0~5A	12V 0~3.5A	15V 0~2.8A	24V 0~2A
纹波及噪音 Wave and noise		80mVp-p	120mVp-p	120mVp-p	150mVp-p
进线稳定度 Inlet wire stability		± 0.5%	± 0.5%	± 0.5%	± 0.5%
负载稳定度 Load stability		± 1%	± 0.5%	± 0.5%	± 0.5%
效率 Efficiency		72%	77%	77%	80%
直流电压可调范围 Adjustable range for DC voltage		± 10%	± 10%	± 10%	± 10%
输入电压范围 Input voltage range		85 ~ 264VAC 120 ~ 370VDC 47 ~ 63Hz			
冲击电流 Impact current		冷启动电流 28A/115VAC 56A/230VAC Cold start current			
过载保护 Overload protection		105% ~ 150% 切断输出, 自动恢复 105% ~ 150% cut off the output, automatic recovery			
过电压保护 Over voltage protection		115% ~ 135% 关闭输出, 电源重启后可恢复输出 115% ~ 135% shut down O/P voltage, re-power on to recover			
启动、上升、保持时间 Setup, rise, hold up time		800ms, 60ms, 50ms/230VAC 满载 at full load			
耐压性 Withstand voltage		输入输出间: 1.5kV 输入与外壳间: 1.5kV 输出与外壳间: 0.5kV 一分钟 I/P-O/P: 1.5kV I/P-FG: 1.5kV O/P-FG: 0.5kV 1minute			
隔离电阻 Isolation resistance		输入输出间 输入与外壳间 输出与外壳间: 500VDC/100MΩ I/P-O/P I/P-FG O/P-FG: 500VDC/100MΩ			
工作温度 Working temperature		-10°C ~ +50°C			
尺寸 Dimension		78 × 93 × 56mm			
重量 Weight		0.27kg			
包装 Packing		43 × 32 × 21.5CM/45PCS/12.5kg			

外形尺寸 Overall dimension(mm)

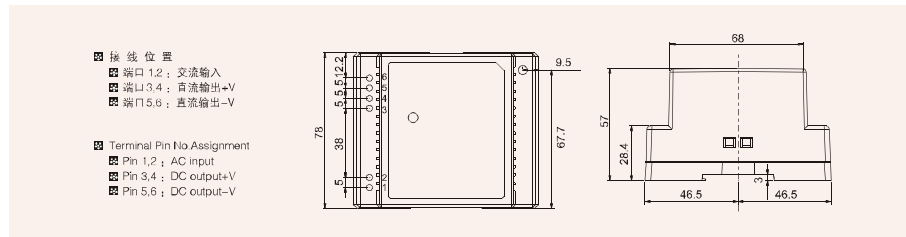

DR-60W单组输出导轨电源
DR-60W Single output DIN rail power supply

概述 Summary

- > 单组输出; 功率60W
Single output: power 60W
- > 输入电压: 85 ~ 264VAC 120 ~ 370VDC
Input voltage: 85 ~ 264VAC 120 ~ 370VDC



常见规格 General Specification

78 × 93 × 56mm

性能 Specification	型号 Model	DR-60-5	DR-60-12	DR-60-15	DR-60-24
直流输出电压、电流 DC output voltage, current		5V 0~6.5A	12V 0~4.5A	15V 0~4A	24V 0~2.5A
纹波及噪音 Wave and noise		80mVp-p	120mVp-p	120mVp-p	150mVp-p
进线稳定度 Inlet wire stability		± 0.5%	± 0.5%	± 0.5%	± 0.5%
负载稳定度 Load stability		± 1%	± 0.5%	± 0.5%	± 0.5%
效率 Efficiency		76%	82%	83%	84%
直流电压可调范围 Adjustable range for DC voltage		± 10%	± 10%	± 10%	± 10%
输入电压范围 Input voltage range		85 ~ 264VAC 120 ~ 370VDC 47 ~ 63Hz			
冲击电流 Impact current		冷启动电流 18A/115VAC 36A/230VAC Cold start current			
过载保护 Overload protection		105% ~ 160% 切断输出, 自动恢复 105% ~ 160% cut off the output, automatic recovery			
过电压保护 Over voltage protection		115% ~ 135% 关闭输出, 电源重启后可恢复输出 115% ~ 135% shut down O/P voltage, re-power on to recover			
启动、上升、保持时间 Setup, rise, hold up time		800ms, 60ms, 50ms/230VAC 满载 at full load			
耐压性 Withstand voltage		输入输出间: 1.5kV 输入与外壳间: 1.5kV 输出与外壳间: 0.5kV 一分钟 I/P-O/P: 1.5kV I/P-FG: 1.5kV O/P-FG: 0.5kV 1minute			
隔离电阻 Isolation resistance		输入输出间 输入与外壳间 输出与外壳间: 500VDC/100MΩ I/P-O/P I/P-FG O/P-FG: 500VDC/100MΩ			
工作温度 Working temperature		-10°C ~ +50°C			
尺寸 Dimension		78 × 93 × 56mm			
重量 Weight		0.3kg			
包装 Packing		43 × 32 × 21.5CM/45PCS/13.5kg			

外形尺寸 Overall dimension(mm)

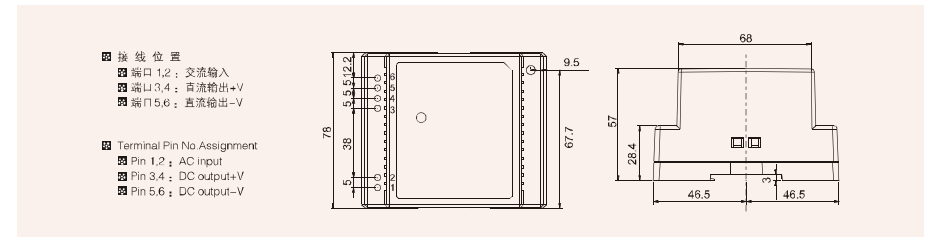

DR-75W单组输出导轨电源
DR-75W Single output DIN rail power supply

概述 Summary

- > 单组输出；功率75W
Single output: power 75W
- > 输入电压：85 ~ 264VAC 120 ~ 370VDC
Input voltage: 85 ~ 264VAC 120 ~ 370VDC



55.5 × 125.2 × 100mm

常见规格 General Specification

性能 Specification	型号 Model	DR-75-12	DR-75-15	DR-75-24	DR-75-48
直流输出电压、电流 DC output voltage, current		12V 0~6.3A	15V 0~5A	24V 0~3.2A	48V 0~1.6A
纹波及噪音 Wave and noise		100mVp-p	150mVp-p	150mVp-p	240mVp-p
进线稳定度 Inlet wire stability		±0.5%	±0.5%	±0.5%	±0.5%
负载稳定度 Load stability		±0.5%	±0.5%	±0.5%	±0.5%
效率 Efficiency		76%	80%	80%	81%
直流电压可调范围 Adjustable range for DC voltage		±10%	±10%	±10%	±10%
输入电压范围 Input voltage range		85~264VAC 120~370VDC 47~63Hz			
冲击电流 Impact current		冷启动电流 20A/115VAC 40A/230VAC Cold start current			
过载保护 Overload protection		105%~150%切断输出, 自动恢复 105%~150% cut off the output, automatic recovery			
过电压保护 Over voltage protection		121%~142%关闭输出, 电源重启后可恢复输出 121%~142% shut down O/P voltage, re-power on to recover			
启动、上升、保持时间 Setup, rise, hold up time		1000ms, 60ms, 60ms/230VAC 满载 at full load			
耐压性 Withstand voltage		输入输出间: 1.5kV 输入与外壳间: 1.5kV 输出与外壳间: 0.5kV 一分钟 I/P-O/P: 1.5kV I/P-FG: 1.5kV O/P-FG: 0.5kV 1minute			
隔离电阻 Isolation resistance		输入输出间 输入与外壳间 输出与外壳间: 500VDC/100MΩ I/P-O/P I/P-FG O/P-FG: 500VDC/100MΩ			
工作温度 Working temperature		-10°C ~ +50°C			
尺寸 Dimension		55.5 × 125.2 × 100mm			
重量 Weight		0.55kg			
包装 Packing		42 × 25 × 24CM/24PCS/13.5kg			

外形尺寸 Overall dimension(mm)

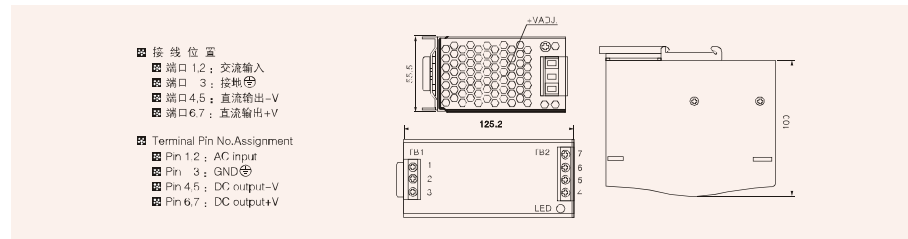

DR-120W单组输出导轨电源
DR-120W Single output DIN rail power supply

概述 Summary

- > 单组输出；功率120W
Single output: power 120W
- > 输入电压：85 ~ 264VAC 120 ~ 370VDC
Input voltage: 85 ~ 264VAC 120 ~ 370VDC



65.5 × 125.2 × 100mm

常见规格 General Specification

性能 Specification	型号 Model	DR-120-12	DR-120-15	DR-120-24	DR-120-48
直流输出电压、电流 DC output voltage, current		12V 0~10A	15V 0~8A	24V 0~5A	48V 0~2.5A
纹波及噪音 Wave and noise		85mVp-p	85mVp-p	85mVp-p	100mVp-p
进线稳定度 Inlet wire stability		±0.5%	±0.5%	±0.5%	±0.5%
负载稳定度 Load stability		±1%	±0.5%	±0.5%	±0.5%
效率 Efficiency		80%	81%	84%	85%
直流电压可调范围 Adjustable range for DC voltage		±10%	±10%	±10%	±10%
输入电压范围 Input voltage range		85~264VAC 120~370VDC 47~63Hz			
冲击电流 Impact current		冷启动电流 20A/115VAC 40A/230VAC Cold start current			
过载保护 Overload protection		105%~150%切断输出, 自动恢复 105%~150% cut off the output, automatic recovery			
过电压保护 Over voltage protection		120%~140%关闭输出, 电源重启后可恢复输出 120%~140% shut down O/P voltage, re-power on to recover			
启动、上升、保持时间 Setup, rise, hold up time		500ms, 70ms, 30ms/230VAC 满载 at full load			
耐压性 Withstand voltage		输入输出间: 1.5kV 输入与外壳间: 1.5kV 输出与外壳间: 0.5kV 一分钟 I/P-O/P: 1.5kV I/P-FG: 1.5kV O/P-FG: 0.5kV 1minute			
隔离电阻 Isolation resistance		输入输出间 输入与外壳间 输出与外壳间: 500VDC/100MΩ I/P-O/P I/P-FG O/P-FG: 500VDC/100MΩ			
工作温度 Working temperature		-10°C ~ +50°C			
尺寸 Dimension		65.5 × 125.2 × 100mm			
重量 Weight		0.8kg			
包装 Packing		45.5 × 35 × 26CM/24PCS/19.2kg			

外形尺寸 Overall dimension(mm)

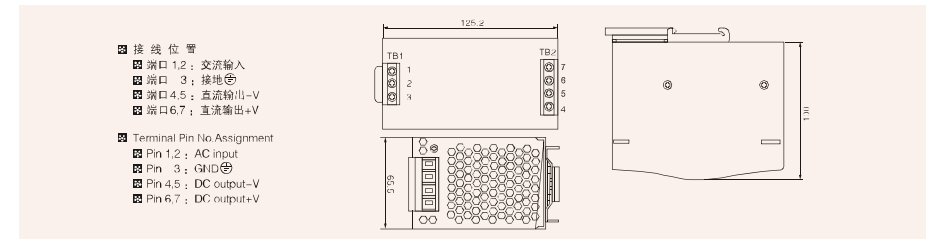

DRP-240W单组输出导轨电源
DRP-240W Single output DIN rail power supply

概述 Summary

- > 单组输出; 功率240W
Single output: power 240W
- > 输入电压: 85 ~ 264VAC 120 ~ 370VDC
Input voltage: 85 ~ 264VAC 120 ~ 370VDC



常见规格 General Specification

125.5 × 125.5 × 100mm

性能 Specification	型号 Model	DRP-240-24	DRP-240-48
直流输出电压、电流 DC output voltage, current		24V 0~10A	48V 0~5A
纹波及噪音 Wave and noise		80mVp-p	150mVp-p
进线稳定度 Inlet wire stability		± 0.5%	± 0.5%
负载稳定度 Load stability		± 1%	± 0.5%
效率 Efficiency		84%	85%
直流电压可调范围 Adjustable range for DC voltage		± 10%	± 10%
输入电压范围 Input voltage range		85 ~ 264VAC 120 ~ 370VDC 47 ~ 63Hz	
冲击电流 Impact current		冷启动电流 27A/115VAC 45A/230VAC Cold start current	
过载保护 Overload protection		105% ~ 150% 切断输出, 自动恢复 105% ~ 150% cut off the output, automatic recovery	
过电压保护 Over voltage protection		30 ~ 36V为24V型; 54 ~ 60V为48V型 30 ~ 36V for 24V model; 54 ~ 60V for 48V model	
启动、上升、保持时间 Setup, rise, hold up time		800ms, 40ms, 20ms/230VAC 满载 at full load	
耐压性 Withstand voltage		输入输出间: 1.5kV 输入与外壳间: 1.5kV 输出与外壳间: 0.5kV 一分钟 I/P-O/P: 1.5kV I/P-FG: 1.5kV O/P-FG: 0.5kV 1minute	
隔离电阻 Isolation resistance		输入输出间 输入与外壳间 输出与外壳间: 500VDC/100MΩ I/P-O/P I/P-FG O/P-FG: 500VDC/100MΩ	
工作温度 Working temperature		-10°C ~ +50°C	
尺寸 Dimension		125.5 × 125.5 × 100mm	
重量 Weight		1.2kg	
包装 Packing		41.5 × 27.5 × 25CM/12PCS/14.5kg	

外形尺寸 Overall dimension(mm)

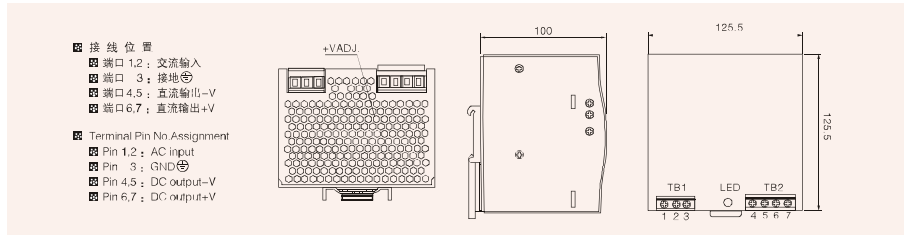

MDR-20W单组输出导轨电源
MDR-20W Single output DIN rail power supply

概述 Summary

- > 单组输出; 功率20W
Single output: power 20W
- > 输入电压: 85 ~ 264VAC 120 ~ 370VDC
Input voltage: 85 ~ 264VAC 120 ~ 370VDC



常见规格 General Specification

22.5 × 90 × 100mm

性能 Specification	型号 Model	MDR-20-5	MDR-20-12	MDR-20-15	MDR-20-24
直流输出电压、电流 DC output voltage, current		5V 0~3A	12V 0~1.67A	15V 0~1.34A	24V 0~1A
纹波及噪音 Wave and noise		80mVp-p	120mVp-p	120mVp-p	150mVp-p
进线稳定度 Inlet wire stability		± 1%	± 1%	± 1%	± 1%
负载稳定度 Load stability		± 1%	± 1%	± 1%	± 1%
效率 Efficiency		76%	80%	81%	84%
直流电压可调范围 Adjustable range for DC voltage		± 2%	± 1%	± 1%	± 1%
输入电压范围 Input voltage range		85 ~ 264VAC 120 ~ 370VDC 47 ~ 63Hz			
冲击电流 Impact current		冷启动电流 20A/115VAC 40A/230VAC Cold start current			
过载保护 Overload protection		105% ~ 160% 切断输出, 自动恢复 105% ~ 160% cut off the output, automatic recovery			
过电压保护 Over voltage protection		120% ~ 140% 关闭输出, 电源重启后可恢复输出 120% ~ 140% shut down O/P voltage, re-power on to recover			
启动、上升、保持时间 Setup, rise, hold up time		500ms, 30ms/230VAC 满载 at full load		1000ms, 30ms/115VAC 满载 at full load	
耐压性 Withstand voltage		输入输出间: 1.5kV 输入与外壳间: 1.5kV 输出与外壳间: 0.5kV 一分钟 I/P-O/P: 1.5kV I/P-FG: 1.5kV O/P-FG: 0.5kV 1minute			
隔离电阻 Isolation resistance		输入输出间 输入与外壳间 输出与外壳间: 500VDC/100MΩ I/P-O/P I/P-FG O/P-FG: 500VDC/100MΩ			
工作温度 Working temperature		-10°C ~ +50°C			
尺寸 Dimension		22.5 × 90 × 100mm			
重量 Weight		0.19kg			
包装 Packing		45.5 × 31.5 × 23CM/90PCS/18kg			

外形尺寸 Overall dimension(mm)

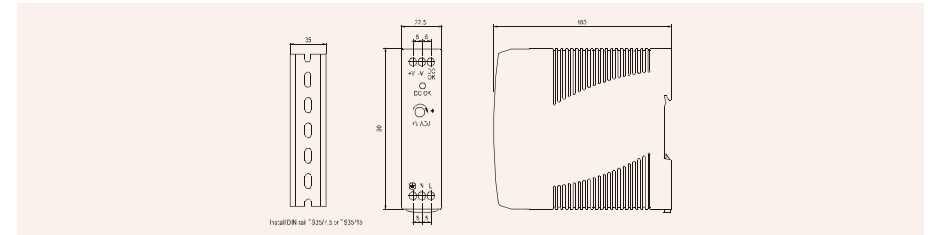

MDR-60W单组输出导轨电源
MDR-60W Single output DIN rail power supply



概述 Summary

- > 单组输出; 功率60W
Single output: power 60W
- > 输入电压: 85 ~ 264VAC 120 ~ 370VDC
Input voltage: 85 ~ 264VAC 120 ~ 370VDC

常见规格 General Specification

40 × 90 × 100mm

性能 Specification	型号 Model	MDR-60-5	MDR-60-12	MDR-60-24	MDR-60-48
直流输出电压、电流 DC output voltage, current		5V 0~10A	12V 0~5A	24V 0~2.5A	48V 0~1.25A
纹波及噪音 Wave and noise		80mVp-p	120mVp-p	150mVp-p	200mVp-p
进线稳定度 Inlet wire stability		±1%	±1%	±1%	±1%
负载稳定度 Load stability		±1.5%	±1%	±1%	±1%
效率 Efficiency		76%	80%	81%	84%
直流电压可调范围 Adjustable range for DC voltage		±2%	±1%	±1%	±1%
输入电压范围 Input voltage range		85~264VAC 120~370VDC 47~63Hz			
冲击电流 Impact current		冷启动电流 30A/115VAC 60A/230VAC Cold start current			
过载保护 Overload protection		105%~150%切断输出, 自动恢复 105%~150% cut off the output, automatic recovery			
过电压保护 Over voltage protection		120%~140%关闭输出, 电源重启后可恢复输出 120%~140% shut down O/P voltage, re-power on to recover			
启动、上升、保持时间 Setup, rise, hold up time		500ms, 30ms/230VAC 满载 at full load 500ms, 30ms/115VAC 满载 at full load			
耐压性 Withstand voltage		输入输出间: 1.5kV 输入与外壳间: 1.5kV 输出与外壳间: 0.5kV 一分钟 I/P-O/P: 1.5kV I/P-FG: 1.5kV O/P-FG: 0.5kV 1minute			
隔离电阻 Isolation resistance		输入输出间 输入与外壳间 输出与外壳间: 500VDC/100MΩ I/P-O/P I/P-FG O/P-FG: 500VDC/100MΩ			
工作温度 Working temperature		-10°C ~ +50°C			
尺寸 Dimension		40 × 90 × 100mm			
重量 Weight		0.33kg			
包装 Packing		45.5 × 32.5 × 23CM/60PCS/20kg			

外形尺寸 Overall dimension(mm)

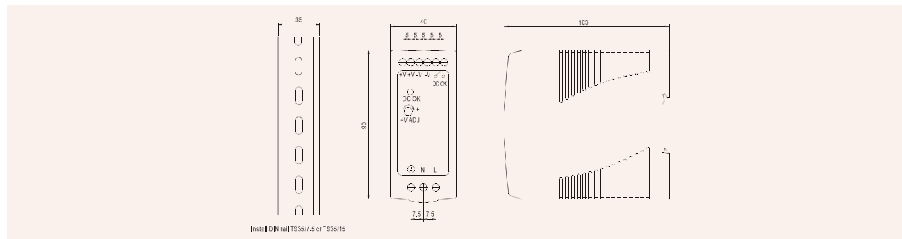

LPV-20W单组输出防水电源
LPV-20W Single output waterproof power supply



概述 Summary

- > 单组输出; 功率20W
Single output: power 20W
- > 输入电压: 85 ~ 264VAC 120 ~ 370VDC
Input voltage: 85 ~ 264VAC 120 ~ 370VDC
- > IP67

常见规格 General Specification

182 × 30 × 20mm

性能 Specification	型号 Model	LPV-20-12	LPV-20-24
直流输出电压、电流 DC output voltage, current		12V 0~1.67A	24V 0~0.84A
纹波及噪音 Wave and noise		100mVp-p	120mVp-p
进线稳定度 Inlet wire stability		±0.5%	±0.5%
负载稳定度 Load stability		±1%	±0.5%
效率 Efficiency		78%	80%
输出电压精度 Output voltage tolerance		12V ±5%	24V ±5%
输入电压范围 Input voltage range		85~264VAC 120~370VDC 47~63Hz	
冲击电流 Impact current		冷启动电流 30A/230VAC Cold start current	
过载保护 Overload protection		105%~150%切断输出, 自动恢复 105%~150% cut off the output, automatic recovery	
过电压保护 Over voltage protection		121%~142%关闭输出, 电源重启后可恢复输出 121%~142% shut down O/P voltage, re-power on to recover	
启动、上升、保持时间 Setup, rise, hold up time		800ms, 20ms, 24ms/230VAC 满载 at full load	
耐压性 Withstand voltage		输入输出间: 1.5kV 输入与外壳间: 1.5kV 输出与外壳间: 0.5kV 一分钟 I/P-O/P: 1.5kV I/P-FG: 1.5kV O/P-FG: 0.5kV 1minute	
隔离电阻 Isolation resistance		输入输出间 输入与外壳间 输出与外壳间: 500VDC/100MΩ I/P-O/P I/P-FG O/P-FG: 500VDC/100MΩ	
工作温度 Working temperature		-10°C ~ +50°C	
尺寸 Dimension		182 × 30 × 20mm	
重量 Weight		0.22kg	
包装 Packing		47 × 20 × 18.5CM/80PCS/18kg	

外形尺寸 Overall dimension(mm)

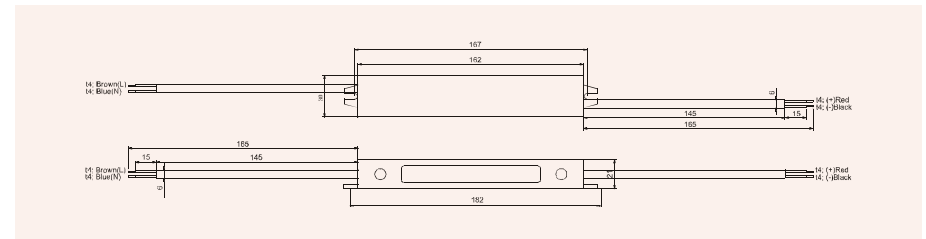

LPV-30W单组输出防水电源
LPV-30W Single output waterproof power supply

概述 Summary

- > 单组输出，功率30W
Single output: power 30W
- > 输入电压：85 ~ 264VAC 120 ~ 370VDC
Input voltage: 85 ~ 264VAC 120 ~ 370VDC
- > IP67



常见规格 General Specification

222 × 30 × 20mm

性能 Specification	型号 Model	LPV-30-12	LPV-30-24
直流输出电压、电流 DC output voltage, current		12V 0 ~ 2.5A	24V 0 ~ 1.25A
纹波及噪音 Wave and noise		100mVp-p	100mVp-p
进线稳定度 Inlet wire stability		± 0.5%	± 0.5%
负载稳定度 Load stability		± 1%	± 0.5%
效率 Efficiency		78%	80%
输出电压精度 Output voltage tolerance		12V ± 5%	24V ± 5%
输入电压范围 Input voltage range		85 ~ 264VAC 120 ~ 370VDC 47 ~ 63Hz	
冲击电流 Impact current	冷启动电流 Cold start current	30A/230VAC	
过载保护 Overload protection	105% ~ 150% 切断输出，自动恢复 105% ~ 150% cut off the output, automatic recovery		
过电压保护 Over voltage protection	121% ~ 142% 关闭输出，电源重启后可恢复输出 121% ~ 142% shut down O/P voltage, re-power on to recover		
启动、上升、保持时间 Setup, rise, hold up time	100ms, 60ms/230VAC 满载 at full load		
耐压性 Withstand voltage	输入输出间: 1.5kV 输入与外壳间: 1.5kV 输出与外壳间: 0.5kV 一分钟 I/P-O/P: 1.5kV I/P-FG: 1.5kV O/P-FG: 0.5kV 1minute		
隔离电阻 Isolation resistance	输入输出间 输入与外壳间 输出与外壳间: 500VDC/100MΩ I/P-O/P I/P-FG O/P-FG: 500VDC/100MΩ		
工作温度 Working temperature	-10°C ~ +50°C		
尺寸 Dimension	222 × 30 × 20mm		
重量 Weight	0.25kg		
包装 Packing	47 × 24 × 18.5CM/80PCS/20kg		

外形尺寸 Overall dimension(mm)

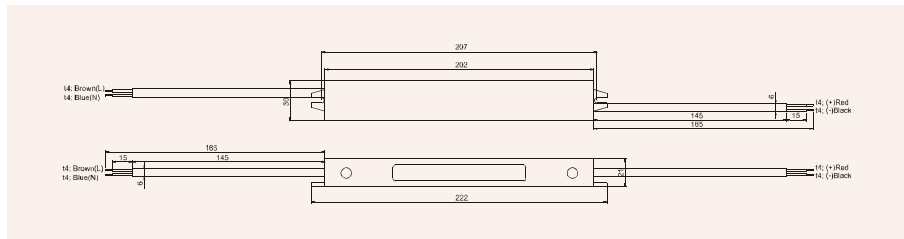

LPV-50W单组输出防水电源
LPV-50W Single output waterproof power supply

概述 Summary

- > 单组输出，功率50W
Single output: power 50W
- > 输入电压：85 ~ 264VAC 120 ~ 370VDC
Input voltage: 85 ~ 264VAC 120 ~ 370VDC
- > IP67



常见规格 General Specification

190 × 47 × 38mm

性能 Specification	型号 Model	LPV-50-12	LPV-50-24
直流输出电压、电流 DC output voltage, current		12V 0 ~ 4.2A	24V 0 ~ 2.1A
纹波及噪音 Wave and noise		100mVp-p	150mVp-p
进线稳定度 Inlet wire stability		± 0.5%	± 0.5%
负载稳定度 Load stability		± 1%	± 0.5%
效率 Efficiency		81%	83%
输出电压精度 Output voltage tolerance		12V ± 5%	24V ± 5%
输入电压范围 Input voltage range		85 ~ 264VAC 120 ~ 370VDC 47 ~ 63Hz	
冲击电流 Impact current	冷启动电流 Cold start current	30A/230VAC	
过载保护 Overload protection	105% ~ 150% 切断输出，自动恢复 105% ~ 150% cut off the output, automatic recovery		
过电压保护 Over voltage protection	121% ~ 142% 关闭输出，电源重启后可恢复输出 121% ~ 142% shut down O/P voltage, re-power on to recover		
启动、上升、保持时间 Setup, rise, hold up time	500ms, 20ms, 24ms/230VAC 满载 at full load		
耐压性 Withstand voltage	输入输出间: 1.5kV 输入与外壳间: 1.5kV 输出与外壳间: 0.5kV 一分钟 I/P-O/P: 1.5kV I/P-FG: 1.5kV O/P-FG: 0.5kV 1minute		
隔离电阻 Isolation resistance	输入输出间 输入与外壳间 输出与外壳间: 500VDC/100MΩ I/P-O/P I/P-FG O/P-FG: 500VDC/100MΩ		
工作温度 Working temperature	-10°C ~ +50°C		
尺寸 Dimension	190 × 47 × 38mm		
重量 Weight	0.6kg		
包装 Packing	44 × 20 × 19CM/24PCS/14.5kg		

外形尺寸 Overall dimension(mm)

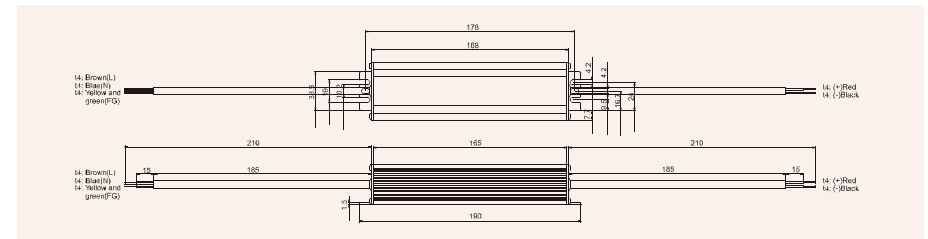

LPV-60W单组输出防水电源
LPV-60W Single output waterproof power supply

概述 Summary

- > 单组输出; 功率60W
Single output; power 60W
- > 输入电压: 180 ~ 264VAC 254 ~ 370VDC
Input voltage: 180 ~ 264VAC 254 ~ 370VDC
- > IP67



常见规格 General Specification

180 × 68 × 50mm

性能 Specification	型号 Model	LPV-60-12	LPV-60-24
直流输出电压、电流 DC output voltage, current		12V 0 ~ 5A	24V 0 ~ 2.5A
纹波及噪音 Wave and noise		100mVp-p	150mVp-p
进线稳定度 Inlet wire stability		± 0.5%	± 0.5%
负载稳定度 Load stability		± 1%	± 0.5%
效率 Efficiency		81%	83%
输出电压精度 Output voltage tolerance		12V ± 5%	24V ± 5%
输入电压范围 Input voltage range		180 ~ 264VAC 254 ~ 370VDC 47 ~ 63Hz	
冲击电流 Impact current		冷启动电流 30A/230VAC Cold start current	
过载保护 Overload protection		105% ~ 150% 切断输出, 自动恢复 105% ~ 150% cut off the output, automatic recovery	
过电压保护 Over voltage protection		121% ~ 142% 关闭输出, 电源重启后可恢复输出 121% ~ 142% shut down O/P voltage, re-power on to recover	
启动、上升、保持时间 Setup, rise, hold up time		500ms, 20ms, 24ms/230VAC 满载 at full load	
耐压性 Withstand voltage		输入输出间: 1.5kV 输入与外壳间: 1.5kV 输出与外壳间: 0.5kV 一分钟 I/P-O/P: 1.5kV I/P-FG: 1.5kV O/P-FG: 0.5kV 1minute	
隔离电阻 Isolation resistance		输入输出间 输入与外壳间 输出与外壳间: 500VDC/100MΩ I/P-O/P I/P-FG O/P-FG: 500VDC/100MΩ	
工作温度 Working temperature		-10°C ~ +50°C	
尺寸 Dimension		180 × 68 × 50mm	
重量 Weight		0.82kg	
包装 Packing		47 × 20 × 18.5CM/18PCS/15kg	

外形尺寸 Overall dimension(mm)

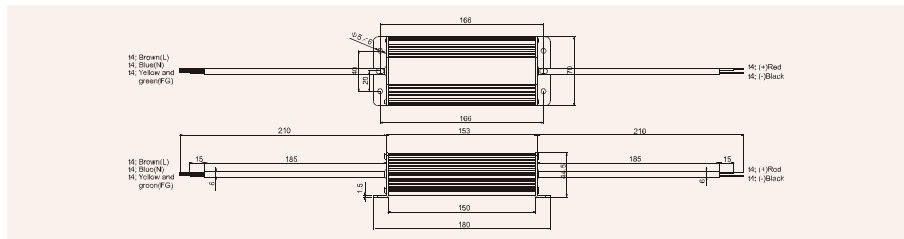

LPV-100W单组输出防水电源
LPV-100W Single output waterproof power supply

概述 Summary

- > 单组输出; 功率100W
Single output; power 100W
- > 输入电压: 180 ~ 264VAC 254 ~ 370VDC
Input voltage: 180 ~ 264VAC 254 ~ 370VDC
- > IP67



常见规格 General Specification

222 × 130 × 65mm

性能 Specification	型号 Model	LPV-100-12	LPV-100-24
直流输出电压、电流 DC output voltage, current		12V 0 ~ 8.5A	24V 0 ~ 4.5A
纹波及噪音 Wave and noise		100mVp-p	150mVp-p
进线稳定度 Inlet wire stability		± 0.5%	± 0.5%
负载稳定度 Load stability		± 1%	± 0.5%
效率 Efficiency		81%	83%
输出电压精度 Output voltage tolerance		12V ± 5%	24V ± 5%
输入电压范围 Input voltage range		180 ~ 264VAC 254 ~ 370VDC 47 ~ 63Hz	
冲击电流 Impact current		冷启动电流 30A/230VAC Cold start current	
过载保护 Overload protection		105% ~ 150% 切断输出, 自动恢复 105% ~ 150% cut off the output, automatic recovery	
过电压保护 Over voltage protection		121% ~ 142% 关闭输出, 电源重启后可恢复输出 121% ~ 142% shut down O/P voltage, re-power on to recover	
启动、上升、保持时间 Setup, rise, hold up time		100ms, 60ms/230VAC 满载 at full load	
耐压性 Withstand voltage		输入输出间: 1.5kV 输入与外壳间: 1.5kV 输出与外壳间: 0.5kV 一分钟 I/P-O/P: 1.5kV I/P-FG: 1.5kV O/P-FG: 0.5kV 1minute	
隔离电阻 Isolation resistance		输入输出间 输入与外壳间 输出与外壳间: 500VDC/100MΩ I/P-O/P I/P-FG O/P-FG: 500VDC/100MΩ	
工作温度 Working temperature		-10°C ~ +50°C	
尺寸 Dimension		222 × 130 × 65mm	
重量 Weight		1.2kg	
包装 Packing		47 × 24 × 18.5CM/18PCS/21.6kg	

外形尺寸 Overall dimension(mm)

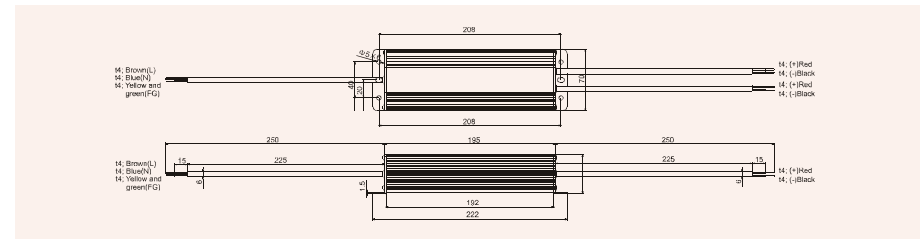

LPV-150W单组输出防水电源
LPV-150W Single output waterproof power supply

概述 Summary

- > 单组输出; 功率150W
Single output; power 150W
- > 输入电压: 180 ~ 264VAC 254 ~ 370VDC
Input voltage: 180 ~ 264VAC 254 ~ 370VDC
- > IP67



常见规格 General Specification

233 × 122 × 60mm

性能 Specification	型号 Model	LPV-150-12	LPV-150-24
直流输出电压、电流 DC output voltage, current		12V 0 ~ 12.5A	24V 0 ~ 6.5A
纹波及噪音 Wave and noise		150mVp-p	240mVp-p
进线稳定度 Inlet wire stability		± 0.5%	± 0.5%
负载稳定度 Load stability		± 1%	± 0.5%
效率 Efficiency		81%	83%
输出电压精度 Output voltage tolerance		12V ± 5%	24V ± 5%
输入电压范围 Input voltage range		180 ~ 264VAC 254 ~ 370VDC 47 ~ 63Hz	
冲击电流 Impact current		冷启动电流 30A/230VAC Cold start current	
过载保护 Overload protection		105% ~ 150% 切断输出, 自动恢复 105% ~ 150% cut off the output, automatic recovery	
过电压保护 Over voltage protection		121% ~ 142% 关闭输出, 电源重启后可恢复输出 121% ~ 142% shut down O/P voltage, re-power on to recover	
启动、上升、保持时间 Setup, rise, hold up time		1000ms, 30ms, 24ms/230VAC 满负载 at full load	
耐压性 Withstand voltage		输入输出间: 1.5kV 输入与外壳间: 1.5kV 输出与外壳间: 0.5kV 一分钟 I/P-O/P: 1.5kV I/P-FG: 1.5kV O/P-FG: 0.5kV 1minute	
隔离电阻 Isolation resistance		输入输出间 输入与外壳间 输出与外壳间: 500VDC/100MΩ I/P-O/P I/P-FG O/P-FG: 500VDC/100MΩ	
工作温度 Working temperature		-10°C ~ +50°C	
尺寸 Dimension		233 × 122 × 60mm	
重量 Weight		2.5kg	
包装 Packing		41 × 26 × 23CM/9PCS/22.5kg	

外形尺寸 Overall dimension(mm)

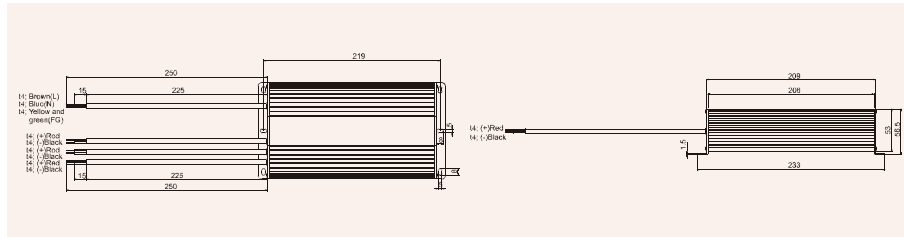

LPV-200W单组输出防水电源
LPV-200W Single output waterproof power supply

概述 Summary

- > 单组输出; 功率200W
Single output; power 200W
- > 输入电压: 180 ~ 264VAC 254 ~ 370VDC
Input voltage: 180 ~ 264VAC 254 ~ 370VDC
- > IP67



常见规格 General Specification

233 × 122 × 60mm

性能 Specification	型号 Model	LPV-200-12	LPV-200-24
直流输出电压、电流 DC output voltage, current		12V 0 ~ 16.5A	24V 0 ~ 8.3A
纹波及噪音 Wave and noise		150mVp-p	240mVp-p
进线稳定度 Inlet wire stability		± 0.5%	± 0.5%
负载稳定度 Load stability		± 1%	± 0.5%
效率 Efficiency		81%	83%
输出电压精度 Output voltage tolerance		12V ± 5%	24V ± 5%
输入电压范围 Input voltage range		180 ~ 264VAC 254 ~ 370VDC 47 ~ 63Hz	
冲击电流 Impact current		冷启动电流 30A/230VAC Cold start current	
过载保护 Overload protection		105% ~ 150% 切断输出, 自动恢复 105% ~ 150% cut off the output, automatic recovery	
过电压保护 Over voltage protection		121% ~ 142% 关闭输出, 电源重启后可恢复输出 121% ~ 142% shut down O/P voltage, re-power on to recover	
启动、上升、保持时间 Setup, rise, hold up time		1000ms, 30ms, 24ms/230VAC 满负载 at full load	
耐压性 Withstand voltage		输入输出间: 1.5kV 输入与外壳间: 1.5kV 输出与外壳间: 0.5kV 一分钟 I/P-O/P: 1.5kV I/P-FG: 1.5kV O/P-FG: 0.5kV 1minute	
隔离电阻 Isolation resistance		输入输出间 输入与外壳间 输出与外壳间: 500VDC/100MΩ I/P-O/P I/P-FG O/P-FG: 500VDC/100MΩ	
工作温度 Working temperature		-10°C ~ +50°C	
尺寸 Dimension		233 × 122 × 60mm	
重量 Weight		2.5kg	
包装 Packing		41 × 26 × 23CM/9PCS/22.5kg	

外形尺寸 Overall dimension(mm)

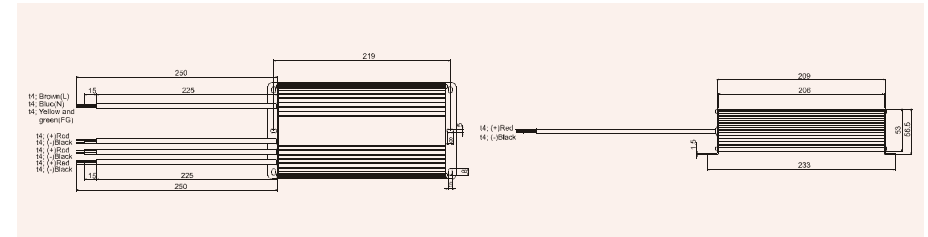

LPV-250W单组输出防水电源
LPV-250W Single output waterproof power supply

概述 Summary

- > 单组输出; 功率250W
Single output; power 250W
- > 输入电压: 180 ~ 264VAC 254 ~ 370VDC
Input voltage: 180 ~ 264VAC 254 ~ 370VDC
- > IP67



常见规格 General Specification

233 x 122 x 60mm

性能 Specification	型号 Model	LPV-250-12	LPV-250-24
直流输出电压、电流 DC output voltage, current		12V 0 ~ 20A	24V 0 ~ 10A
纹波及噪音 Wave and noise		150mVp-p	240mVp-p
进线稳定度 Inlet wire stability		± 0.5%	± 0.5%
负载稳定度 Load stability		± 1%	± 0.5%
效率 Efficiency		81%	83%
输出电压精度 Output voltage tolerance		12V ± 5%	24V ± 5%
输入电压范围 Input voltage range		180 ~ 264VAC 254 ~ 370VDC 47 ~ 63Hz	
冲击电流 Impact current		冷启动电流 30A/230VAC Cold start current	
过载保护 Overload protection		105% ~ 150% 切断输出, 自动恢复 105% ~ 150% cut off the output, automatic recovery	
过电压保护 Over voltage protection		121% ~ 142% 关闭输出, 电源重启后可恢复输出 121% ~ 142% shut down O/P voltage, re-power on to recover	
启动、上升、保持时间 Setup, rise, hold up time		1000ms, 30ms, 24ms/230VAC 满载 at full load	
耐压性 Withstand voltage		输入输出间: 1.5kV 输入与外壳间: 1.5kV 输出与外壳间: 0.5kV 一分钟 I/P-O/P: 1.5kV I/P-FG: 1.5kV O/P-FG: 0.5kV 1minute	
隔离电阻 Isolation resistance		输入输出间 输入与外壳间 输出与外壳间: 500VDC/100MΩ I/P-O/P I/P-FG O/P-FG: 500VDC/100MΩ	
工作温度 Working temperature		-10°C ~ +50°C	
尺寸 Dimension		230 x 122 x 60mm	
重量 Weight		2.5kg	
包装 Packing		41 x 26 x 23CM/9PCS/22.5kg	

外形尺寸 Overall dimension(mm)

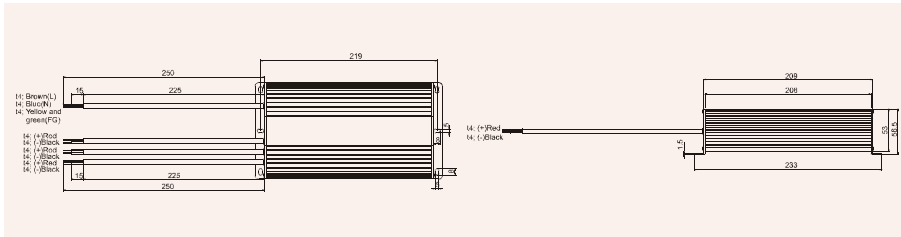

SP-100W单组输出带PFC功能电源
SP-100W Single output with PFC power supply

概述 Summary

- > 单组输出; 功率100W
Single output; power 100W
- > 输入电压: 85 ~ 264VAC 120 ~ 370VDC
Input voltage: 85 ~ 264VAC 120 ~ 370VDC
- > PF>0.96@115VAC; PF>0.93@230VAC



常见规格 General Specification

179 x 99 x 45mm

性能 Specification	型号 Model	SP-100-5	SP-100-12	SP-100-24	SP-100-48
直流输出电压、电流 DC output voltage, current		5V 0 ~ 20A	12V 0 ~ 8.5A	24V 0 ~ 4.2A	48V 0 ~ 2.1A
纹波及噪音 Wave and noise		100mVp-p	100mVp-p	150mVp-p	240mVp-p
进线稳定度 Inlet wire stability		± 0.5%	± 0.5%	± 0.5%	± 0.5%
负载稳定度 Load stability		± 1.0%	± 0.5%	± 0.5%	± 0.5%
效率 Efficiency		76%	80%	84%	82%
直流电压可调范围 Adjustable range for DC voltage		± 10%	± 10%	± 10%	± 10%
输入电压范围 Input voltage range		85 ~ 264VAC 120 ~ 370VDC 47 ~ 63Hz			
冲击电流 Impact current		冷启动电流 30A/230VAC Cold start current			
过载保护 Overload protection		105% ~ 150% 切断输出, 自动恢复 105% ~ 150% cut off the output, automatic recovery			
过电压保护 Over voltage protection		110% ~ 135% 关闭输出, 电源重启后可恢复输出 110% ~ 135% shut down O/P voltage, re-power on to recover			
启动、上升、保持时间 Setup, rise, hold up time		600ms, 30ms, 20ms/230VAC 满载 at full load			
耐压性 Withstand voltage		输入输出间: 1.5kV 输入与外壳间: 1.5kV 输出与外壳间: 0.5kV 一分钟 I/P-O/P: 1.5kV I/P-FG: 1.5kV O/P-FG: 0.5kV 1minute			
隔离电阻 Isolation resistance		输入输出间 输入与外壳间 输出与外壳间: 500VDC/100MΩ I/P-O/P I/P-FG O/P-FG: 500VDC/100MΩ			
工作温度 Working temperature		-10°C ~ +60°C			
尺寸 Dimension		179 x 99 x 45mm			
重量 Weight		0.66kg			
包装 Packing		42.5 x 28.5 x 22.6CM/20PCS/13.2kg			

外形尺寸 Overall dimension(mm)

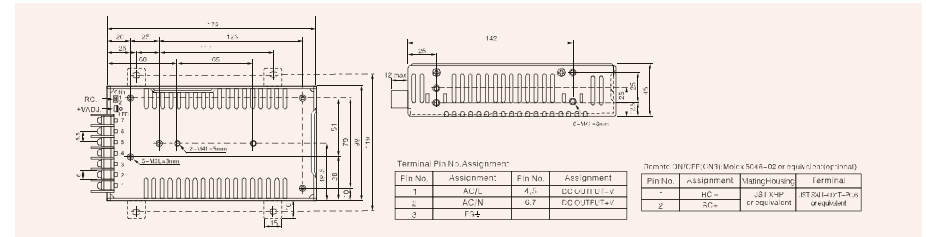

SP-150W单组输出带PFC功能电源
SP-150W Single output with PFC power supply



199 x 99 x 50mm

概述 Summary

- > 单组输出; 功率150W
Single output; power 150W
- > 输入电压: 85 ~ 264VAC 120 ~ 370VDC
Input voltage: 85 ~ 264VAC 120 ~ 370VDC
- > PF>0.96@115VAC; PF>0.93@230VAC

常见规格 General Specification

性能 Specification	型号 Model	SP-150-5	SP-150-12	SP-150-24	SP-150-48
直流输出电压、电流 DC output voltage, current		5V 0~30A	12V 0~12.5A	24V 0~6.3A	48V 0~3.2A
纹波及噪音 Wave and noise		100mVp-p	100mVp-p	150mVp-p	240mVp-p
进线稳定度 Inlet wire stability		±0.5%	±0.5%	±0.5%	±0.5%
负载稳定度 Load stability		±1%	±0.5%	±0.5%	±0.5%
效率 Efficiency		75%	80%	83%	84%
直流电压可调范围 Adjustable range for DC voltage		±10%	±10%	±10%	±10%
输入电压范围 Input voltage range		85~264VAC 120~370VDC 47~63Hz			
冲击电流 Impact current		冷启动电流 30A/230VAC Cold start current			
过载保护 Overload protection		105%~150%切断输出, 自动恢复 105%~150% cut off the output, automatic recovery			
过电压保护 Over voltage protection		110%~135%关闭输出, 电源重启后可恢复输出 110%~135% shut down O/P voltage, re-power on to recover			
启动、上升、保持时间 Setup, rise, hold up time		600ms, 30ms, 20ms/230VAC 满载 at full load			
耐压性 Withstand voltage		输入输出间: 1.5kV 输入与外壳间: 1.5kV 输出与外壳间: 0.5kV 一分钟 I/P-O/P: 1.5kV I/P-FG: 1.5kV O/P-FG: 0.5kV 1minute			
隔离电阻 Isolation resistance		输入输出间 输入与外壳间 输出与外壳间: 500VDC/100MΩ I/P-O/P I/P-FG O/P-FG: 500VDC/100MΩ			
工作温度 Working temperature		-10°C ~ +60°C			
尺寸 Dimension		199 x 99 x 50mm			
重量 Weight		0.76kg			
包装 Packing		42.5 x 28.5 x 22.6CM/20PCS/15.5kg			

外形尺寸 Overall dimension(mm)

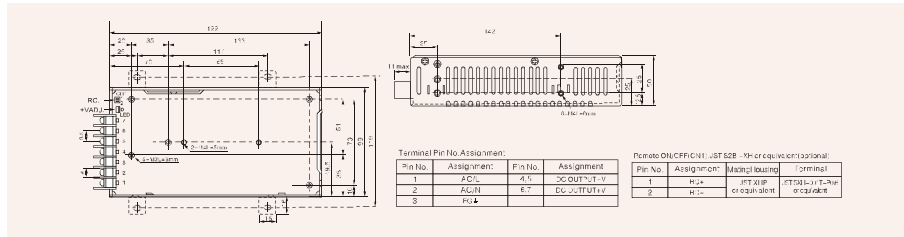

SP-200W单组输出带PFC功能电源
SP-200W Single output with PFC power supply



199 x 99 x 50mm

概述 Summary

- > 单组输出; 功率200W
Single output; power 200W
- > 输入电压: 85 ~ 264VAC 120 ~ 370VDC
Input voltage: 85 ~ 264VAC 120 ~ 370VDC
- > PF>0.96@115VAC; PF>0.93@230VAC

常见规格 General Specification

性能 Specification	型号 Model	SP-200-5	SP-200-12	SP-200-24	SP-200-48
直流输出电压、电流 DC output voltage, current		5V 0~40A	12V 0~16.7A	24V 0~8.4A	48V 0~4.2A
纹波及噪音 Wave and noise		100mVp-p	100mVp-p	150mVp-p	240±0.5%
进线稳定度 Inlet wire stability		±0.5%	±0.5%	±0.5%	±0.5%
负载稳定度 Load stability		±1%	±0.5%	±0.5%	±0.5%
效率 Efficiency		75%	79%	83%	84%
直流电压可调范围 Adjustable range for DC voltage		±10%	±10%	±10%	±10%
输入电压范围 Input voltage range		85~264VAC 120~370VDC 47~63Hz			
冲击电流 Impact current		冷启动电流 40A/230VAC Cold start current			
过载保护 Overload protection		105%~150%切断输出, 自动恢复 105%~150% cut off the output, automatic recovery			
过电压保护 Over voltage protection		110%~135%关闭输出, 电源重启后可恢复输出 110%~135% shut down O/P voltage, re-power on to recover			
启动、上升、保持时间 Setup, rise, hold up time		600ms, 30ms, 20ms/230VAC 满载 at full load			
耐压性 Withstand voltage		输入输出间: 1.5kV 输入与外壳间: 1.5kV 输出与外壳间: 0.5kV 一分钟 I/P-O/P: 1.5kV I/P-FG: 1.5kV O/P-FG: 0.5kV 1minute			
隔离电阻 Isolation resistance		输入输出间 输入与外壳间 输出与外壳间: 500VDC/100MΩ I/P-O/P I/P-FG O/P-FG: 500VDC/100MΩ			
工作温度 Working temperature		-10°C ~ +60°C			
尺寸 Dimension		199 x 99 x 50mm			
重量 Weight		0.85kg			
包装 Packing		42.5 x 28.5 x 22.6CM/20PCS/17kg			

外形尺寸 Overall dimension(mm)

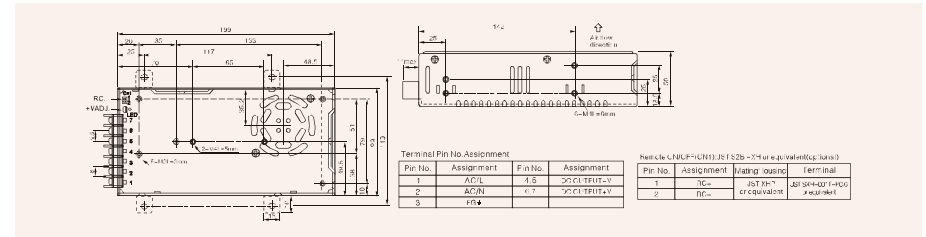

SP-320W单组输出带PFC功能电源
SP-320W Single output with PFC power supply



概述 Summary

- > 单组输出, 功率320W
Single output: power 320W
- > 输入电压: 85 ~ 264VAC 120 ~ 370VDC
Input voltage: 85 ~ 264VAC 120 ~ 370VDC
- > PF>0.96@115VAC;PF>0.93@230VAC

常见规格 General Specification

215 × 115 × 50mm

性能 Specification	型号 Model	SP-320-5	SP-320-12	SP-320-24	SP-320-48
直流输出电压、电流 DC output voltage, current		5V 0 ~ 55A	12V 0 ~ 25A	24V 0 ~ 13A	48V 0 ~ 6.7A
纹波及噪音 Wave and noise		100mVp-p	100mVp-p	150mVp-p	150mVp-p
进线稳定度 Inlet wire stability		± 0.5%	± 0.3%	± 0.2%	± 0.2%
负载稳定度 Load stability		± 1.0%	± 0.5%	± 0.5%	± 0.5%
效率 Efficiency		79%	86%	87%	89%
直流电压可调范围 Adjustable range for DC voltage		± 10%	± 10%	± 10%	± 10%
输入电压范围 Input voltage range		85 ~ 264VAC 120 ~ 370VDC 47 ~ 63Hz			
冲击电流 Impact current		冷启动电流 20A/115VAC 30A/230VAC Cold start current			
过载保护 Overload protection		105% ~ 150% 切断输出, 自动恢复 105% ~ 150% cut off the output, automatic recovery			
过电压保护 Over voltage protection		110% ~ 135% 关闭输出, 电源重启后可恢复输出 110% ~ 135% shut down O/P voltage, re-power on to recover			
启动、上升、保持时间 Setup, rise, hold up time		800ms, 50ms, 16ms/230VAC 满载 at full load 2500ms, 50ms, 16ms/115VAC 满载 at full load			
耐压性 Withstand voltage		输入输出间: 1.5kV 输入与外壳间: 1.5kV 输出与外壳间: 0.5kV 一分钟 I/P-O/P: 1.5kV I/P-FG: 1.5kV O/P-FG: 0.5kV 1minute			
隔离电阻 Isolation resistance		输入输出间 输入与外壳间 输出与外壳间: 500VDC/100MΩ I/P-O/P I/P-FG O/P-FG: 500VDC/100MΩ			
工作温度 Working temperature		-10°C ~ +60°C			
尺寸 Dimension		215 × 115 × 50mm			
重量 Weight		1.1kg			
包装 Packing		48 × 31.5 × 26CM/20PCS/22kg			

外形尺寸 Overall dimension(mm)

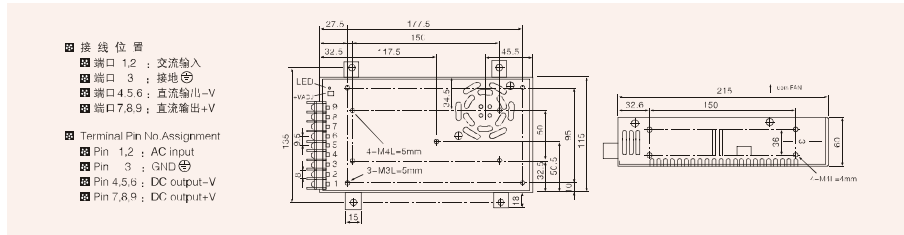

SP-500W单组输出带PFC功能电源
SP-500W Single output with PFC power supply



概述 Summary

- > 单组输出, 功率500W
Single output: power 500W
- > 输入电压: 85 ~ 264VAC 120 ~ 370VDC
Input voltage: 85 ~ 264VAC 120 ~ 370VDC
- > PF>0.96@115VAC;PF>0.93@230VAC

常见规格 General Specification

185 × 120 × 93mm

性能 Specification	型号 Model	SP-500-12	SP-500-15	SP-500-24	SP-500-48
直流输出电压、电流 DC output voltage, current		12V 0 ~ 40A	15V 0 ~ 32A	24V 0 ~ 20A	48V 0 ~ 10A
纹波及噪音 Wave and noise		240mVp-p	240mVp-p	240mVp-p	300mVp-p
进线稳定度 Inlet wire stability		± 0.5%	± 0.5%	± 0.5%	± 0.5%
负载稳定度 Load stability		± 0.5%	± 0.5%	± 0.5%	± 0.5%
效率 Efficiency		84%	84%	85.5%	87%
直流电压可调范围 Adjustable range for DC voltage		± 10%	± 10%	± 10%	± 10%
输入电压范围 Input voltage range		85 ~ 264VAC 120 ~ 370VDC 47 ~ 63Hz			
冲击电流 Impact current		冷启动电流 18A/115VAC 32A/230VAC Cold start current			
过载保护 Overload protection		105% ~ 135% 切断输出, 自动恢复 105% ~ 135% cut off the output, automatic recovery			
过电压保护 Over voltage protection		115% ~ 140% 关闭输出, 电源重启后可恢复输出 115% ~ 140% shut down O/P voltage, re-power on to recover			
启动、上升、保持时间 Setup, rise, hold up time		1500ms, 50ms, 20ms/230VAC 满载 at full load			
耐压性 Withstand voltage		输入输出间: 1.5kV 输入与外壳间: 1.5kV 输出与外壳间: 0.5kV 一分钟 I/P-O/P: 1.5kV I/P-FG: 1.5kV O/P-FG: 0.5kV 1minute			
隔离电阻 Isolation resistance		输入输出间 输入与外壳间 输出与外壳间: 500VDC/100MΩ I/P-O/P I/P-FG O/P-FG: 500VDC/100MΩ			
工作温度 Working temperature		-10°C ~ +50°C			
尺寸 Dimension		185 × 120 × 93mm			
重量 Weight		1.8kg			
包装 Packing		40 × 26 × 22CM/8PCS/14.5kg			

外形尺寸 Overall dimension(mm)

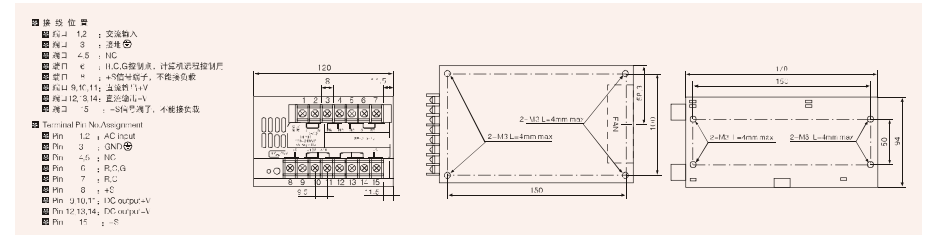

MSF-10W单组输出超薄电源
MSF-10W Single output ultrathin power supply

概述 Summary

- > 单组输出; 功率10W
Single output: power 10W
- > 输入电压: 85 ~ 264VAC 120 ~ 370VDC
Input voltage: 85 ~ 264VAC 120 ~ 370VDC



常见规格 General Specification

78 × 48 × 21mm

性能 Specification	型号 Model	MSF-10-5	MSF-10-12	MSF-10-15	MSF-10-24
直流输出电压、电流 DC output voltage, current		5V 0~2A	12V 0~1A	15V 0~0.8A	24V 0~0.5A
纹波及噪音 Wave and noise		50mVp-p	50mVp-p	50mVp-p	50mVp-p
进线稳定度 Inlet wire stability		± 0.5%	± 0.5%	± 0.5%	± 0.5%
负载稳定度 Load stability		± 1%	± 0.5%	± 0.5%	± 0.5%
效率 Efficiency		68%	71%	72%	75%
直流电压可调范围 Adjustable range for DC voltage		± 10%	± 10%	± 10%	± 10%
输入电压范围 Input voltage range		85 ~ 264VAC 120 ~ 370VDC 47 ~ 63Hz			
冲击电流 Impact current		冷启动电流 Cold start current 30A/230VAC			
过载保护 Overload protection		105% ~ 135% 切断输出, 自动恢复 105% ~ 135% cut off the output, automatic recovery			
过电压保护 Over voltage protection					
启动、上升、保持时间 Setup, rise, hold up time		200ms, 50ms, 20ms/230VAC 满负载 at full load			
耐压性 Withstand voltage		输入输出间: 1.5kV 输入与外壳间: 1.5kV 输出与外壳间: 0.5kV 一分钟 I/P-O/P: 1.5kV I/P-FG: 1.5kV O/P-FG: 0.5kV 1minute			
隔离电阻 Isolation resistance		输入输出间 输入与外壳间 输出与外壳间: 500VDC/100MΩ I/P-O/P I/P-FG O/P-FG: 500VDC/100MΩ			
工作温度 Working temperature		-10°C ~ +50°C			
尺寸 Dimension		78 × 48 × 21mm			
重量 Weight		0.15kg			
包装 Packing		24.5 × 17.5 × 26.5CM/100PCS/15kg			

外形尺寸 Overall dimension(mm)

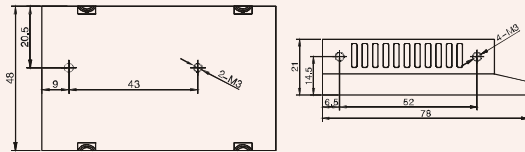

MSF-20W单组输出超薄电源
MSF-20W Single output ultrathin power supply

概述 Summary

- > 单组输出; 功率20W
Single output: power 20W
- > 输入电压: 85 ~ 264VAC 120 ~ 370VDC
Input voltage: 85 ~ 264VAC 120 ~ 370VDC



常见规格 General Specification

97 × 58 × 25mm

性能 Specification	型号 Model	MSF-20-5	MSF-20-12	MSF-20-15	MSF-20-24
直流输出电压、电流 DC output voltage, current		5V 0~4A	12V 0~2A	15V 0~1.6A	24V 0~1A
纹波及噪音 Wave and noise		50mVp-p	50mVp-p	50mVp-p	50mVp-p
进线稳定度 Inlet wire stability		± 0.5%	± 0.5%	± 0.5%	± 0.5%
负载稳定度 Load stability		± 1%	± 0.5%	± 0.5%	± 0.5%
效率 Efficiency		68%	71%	72%	75%
直流电压可调范围 Adjustable range for DC voltage		± 10%	± 10%	± 10%	± 10%
输入电压范围 Input voltage range		85 ~ 264VAC 120 ~ 370VDC 47 ~ 63Hz			
冲击电流 Impact current		冷启动电流 Cold start current 30A/230VAC			
过载保护 Overload protection		105% ~ 135% 切断输出, 自动恢复 105% ~ 135% cut off the output, automatic recovery			
过电压保护 Over voltage protection					
启动、上升、保持时间 Setup, rise, hold up time		200ms, 50ms, 20ms/230VAC 满负载 at full load			
耐压性 Withstand voltage		输入输出间: 1.5kV 输入与外壳间: 1.5kV 输出与外壳间: 0.5kV 一分钟 I/P-O/P: 1.5kV I/P-FG: 1.5kV O/P-FG: 0.5kV 1minute			
隔离电阻 Isolation resistance		输入输出间 输入与外壳间 输出与外壳间: 500VDC/100MΩ I/P-O/P I/P-FG O/P-FG: 500VDC/100MΩ			
工作温度 Working temperature		-10°C ~ +50°C			
尺寸 Dimension		97 × 58 × 25mm			
重量 Weight		0.19kg			
包装 Packing		28.5 × 21.6 × 32CM/100PCS/19kg			

外形尺寸 Overall dimension(mm)

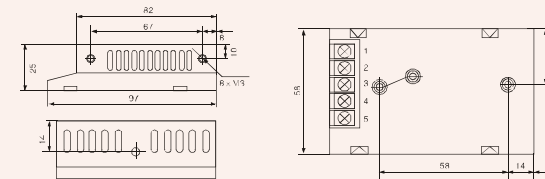

MS-15W单组输出小体积电源
MS-15W Single output mini-size power supply

概述 Summary

- > 单组输出，功率15W
Single output: power 15W
- > 输入电压：85 ~ 264VAC 120 ~ 370VDC
Input voltage: 85 ~ 264VAC 120 ~ 370VDC



常见规格 General Specification

84 x 58 x 38mm

性能 Specification	型号 Model	MS-15-5	MS-15-12	MS-15-15	MS-15-24
直流输出电压、电流 DC output voltage, current		5V 0~3A	12V 0~1.3A	15V 0~1A	24V 0~0.7A
纹波及噪音 Wave and noise		60mVp-p	80mVp-p	100mVp-p	100mVp-p
进线稳定度 Inlet wire stability		± 0.5%	± 0.5%	± 0.5%	± 0.5%
负载稳定度 Load stability		± 0.5%	± 0.5%	± 0.5%	± 0.5%
效率 Efficiency		68%	71%	72%	75%
直流电压可调范围 Adjustable range for DC voltage		± 10%	± 10%	± 10%	± 10%
输入电压范围 Input voltage range		85 ~ 264VAC 120 ~ 370VDC 47 ~ 63Hz			
冲击电流 Impact current		冷启动电流 30A/230VAC Cold start current			
过载保护 Overload protection		105% ~ 135% 切断输出, 自动恢复 105% ~ 135% cut off the output, automatic recovery			
过电压保护 Over voltage protection					
启动、上升、保持时间 Setup, rise, hold up time		200ms, 50ms, 20ms/230VAC 满载 at full load			
耐压性 Withstand voltage		输入输出间: 1.5kV 输入与外壳间: 1.5kV 输出与外壳间: 0.5kV 一分钟 I/P-O/P: 1.5kV I/P-FG: 1.5kV O/P-FG: 0.5kV 1minute			
隔离电阻 Isolation resistance		输入输出间 输入与外壳间 输出与外壳间: 500VDC/100MΩ I/P-O/P I/P-FG O/P-FG: 500VDC/100MΩ			
工作温度 Working temperature		-10°C ~ +50°C			
尺寸 Dimension		84 x 58 x 38mm			
重量 Weight		0.21kg			
包装 Packing		38 x 35 x 24CM/100PCS/21kg			

外形尺寸 Overall dimension(mm)

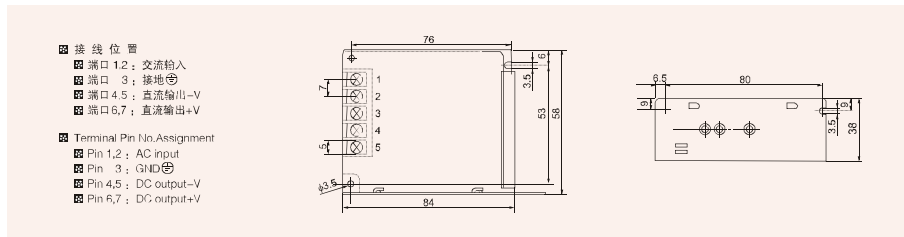

S-15W单组输出电源
S-15W Single output power supply

概述 Summary

- > 单组输出，功率15W
Single output: power 15W
- > 输入电压：90 ~ 132VAC/180 ~ 264VAC 由开关切换
Input voltage: 90 ~ 132VAC/180 ~ 264VAC by switch



常见规格 General Specification

98 x 97 x 35mm

性能 Specification	型号 Model	S-15-5	S-15-12	S-15-15	S-15-24
直流输出电压、电流 DC output voltage, current		5V 0~3A	12V 0~1.3A	15V 0~1A	24V 0~0.7A
纹波及噪音 Wave and noise		50mVp-p	50mVp-p	75mVp-p	100mVp-p
进线稳定度 Inlet wire stability		± 0.5%	± 0.5%	± 0.5%	± 0.5%
负载稳定度 Load stability		± 1%	± 0.5%	± 0.5%	± 0.5%
效率 Efficiency		65%	68%	70%	72%
直流电压可调范围 Adjustable range for DC voltage		± 10%	± 10%	± 10%	± 10%
输入电压范围 Input voltage range		90 ~ 132VAC/180 ~ 264VAC 由开关切换 254 ~ 370VDC 47 ~ 63Hz 90 ~ 132VAC/180 ~ 264VAC by switch 254 ~ 370VDC 47 ~ 63Hz			
冲击电流 Impact current		冷启动电流 15A/115VAC 30A/230VAC Cold start current			
过载保护 Overload protection		105% ~ 150% 切断输出, 自动恢复 105% ~ 150% cut off the output, automatic recovery			
过电压保护 Over voltage protection					
启动、上升、保持时间 Setup, rise, hold up time		200ms, 100ms, 30ms/230VAC 满载 at full load			
耐压性 Withstand voltage		输入输出间: 1.5kV 输入与外壳间: 1.5kV 输出与外壳间: 0.5kV 一分钟 I/P-O/P: 1.5kV I/P-FG: 1.5kV O/P-FG: 0.5kV 1minute			
隔离电阻 Isolation resistance		输入输出间 输入与外壳间 输出与外壳间: 500VDC/100MΩ I/P-O/P I/P-FG O/P-FG: 500VDC/100MΩ			
工作温度 Working temperature		-10°C ~ +50°C			
尺寸 Dimension		98 x 97 x 35mm			
重量 Weight		0.3kg			
包装 Packing		43 x 32.5 x 24CM/60PCS/18kg			

外形尺寸 Overall dimension(mm)

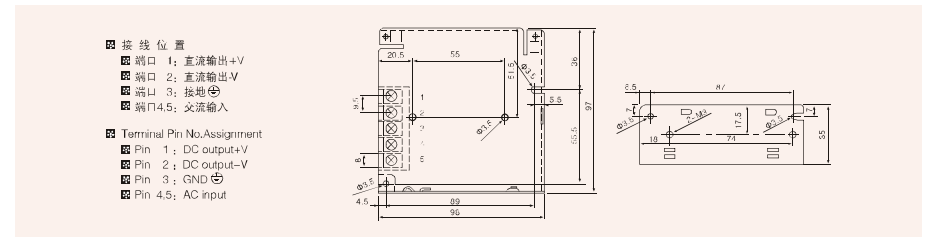

MS-25W单组输出小体积电源
MS-25W Single output mini-size power supply

概述 Summary

- > 单组输出，功率25W
Single output: power 25W
- > 输入电压：85 ~ 264VAC 120 ~ 370VDC
Input voltage: 85 ~ 264VAC 120 ~ 370VDC



常见规格 General Specification

84 × 58 × 38mm

性能 Specification	型号 Model	MS-25-5	MS-25-12	MS-25-15	MS-25-24
直流输出电压、电流 DC output voltage, current		5V 0~5A	12V 0~2.1A	15V 0~1.4A	24V 0~1.1A
纹波及噪音 Wave and noise		60mVp-p	80mVp-p	100mVp-p	100mVp-p
进线稳定度 Inlet wire stability		± 0.5%	± 0.5%	± 0.5%	± 0.5%
负载稳定度 Load stability		± 0.5%	± 0.5%	± 0.5%	± 0.5%
效率 Efficiency		70%	75%	76%	78%
直流电压可调范围 Adjustable range for DC voltage		± 10%	± 10%	± 10%	± 10%
输入电压范围 Input voltage range		85 ~ 264VAC 120 ~ 370VDC 47 ~ 63Hz			
冲击电流 Impact current		冷启动电流 30A/230VAC Cold start current			
过载保护 Overload protection		105% ~ 135% 切断输出，自动恢复 105% ~ 135% cut off the output, automatic recovery			
过电压保护 Over voltage protection					
启动、上升、保持时间 Setup, rise, hold up time		200ms, 50ms, 20ms/230VAC 满载 at full load			
耐压性 Withstand voltage		输入输出间: 1.5kV 输入与外壳间: 1.5kV 输出与外壳间: 0.5kV 一分钟 I/P-O/P: 1.5kV I/P-FG: 1.5kV O/P-FG: 0.5kV 1minute			
隔离电阻 Isolation resistance		输入输出间 输入与外壳间 输出与外壳间: 500VDC/100MΩ I/P-O/P I/P-FG O/P-FG: 500VDC/100MΩ			
工作温度 Working temperature		-10°C ~ +50°C			
尺寸 Dimension		84 × 58 × 38mm			
重量 Weight		0.21kg			
包装 Packing		38 × 35 × 24CM/100PCS/21kg			

外形尺寸 Overall dimension(mm)

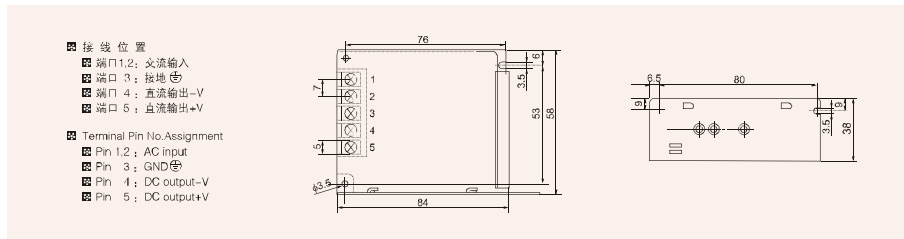

S-25W单组输出电源
S-25W Single output power supply

概述 Summary

- > 单组输出，功率25W
Single output: power 25W
- > 输入电压：90 ~ 132VAC/180 ~ 264VAC 由开关切换
Input voltage: 90 ~ 132VAC/180 ~ 264VAC by switch



常见规格 General Specification

98 × 97 × 35mm

性能 Specification	型号 Model	S-25-5	S-25-12	S-25-15	S-25-24
直流输出电压、电流 DC output voltage, current		5V 0~5A	12V 0~2.1A	15V 0~1.67A	24V 0~1.1A
纹波及噪音 Wave and noise		50mVp-p	50mVp-p	75mVp-p	100mVp-p
进线稳定度 Inlet wire stability		± 0.5%	± 0.5%	± 0.5%	± 0.5%
负载稳定度 Load stability		± 1%	± 0.5%	± 0.5%	± 0.5%
效率 Efficiency		65%	68%	70%	72%
直流电压可调范围 Adjustable range for DC voltage		± 10%	± 10%	± 10%	± 10%
输入电压范围 Input voltage range		90 ~ 132VAC/180 ~ 264VAC 由开关切换 254 ~ 370VDC 47 ~ 63Hz 90 ~ 132VAC/180 ~ 264VAC by switch 254 ~ 370VDC 47 ~ 63Hz			
冲击电流 Impact current		冷启动电流 15A/115VAC 30A/230VAC Cold start current			
过载保护 Overload protection		105% ~ 150% 切断输出，自动恢复 105% ~ 150% cut off the output, automatic recovery			
过电压保护 Over voltage protection					
启动、上升、保持时间 Setup, rise, hold up time		200ms, 100ms, 30ms/230VAC 满载 at full load			
耐压性 Withstand voltage		输入输出间: 1.5kV 输入与外壳间: 1.5kV 输出与外壳间: 0.5kV 一分钟 I/P-O/P: 1.5kV I/P-FG: 1.5kV O/P-FG: 0.5kV 1minute			
隔离电阻 Isolation resistance		输入输出间 输入与外壳间 输出与外壳间: 500VDC/100MΩ I/P-O/P I/P-FG O/P-FG: 500VDC/100MΩ			
工作温度 Working temperature		-10°C ~ +50°C			
尺寸 Dimension		98 × 97 × 35mm			
重量 Weight		0.3kg			
包装 Packing		43 × 32.5 × 24CM/60PCS/18kg			

外形尺寸 Overall dimension(mm)

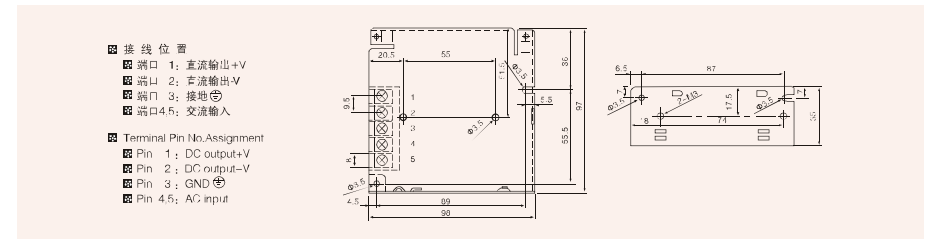

MS-35W单组输出小体积电源
MS-35W Single output mini-size power supply

概述 Summary

- > 单组输出，功率35W
Single output: power 35W
- > 输入电压：85 ~ 264VAC 120 ~ 370VDC
Input voltage: 85 ~ 264VAC 120 ~ 370VDC



常见规格 General Specification

84 × 58 × 38mm

性能 Specification	型号 Model	MS-35-5	MS-35-12	MS-35-15	MS-35-24
直流输出电压、电流 DC output voltage, current		5V 0~6A	12V 0~3A	15V 0~2.4A	24V 0~1.5A
纹波及噪音 Wave and noise		60mVp-p	80mVp-p	100mVp-p	100mVp-p
进线稳定度 Inlet wire stability		±1%	±0.5%	±0.5%	±0.5%
负载稳定度 Load stability		±1%	±0.5%	±0.5%	±0.5%
效率 Efficiency		77%	81%	83%	84%
直流电压可调范围 Adjustable range for DC voltage		±10%	±10%	±10%	±10%
输入电压范围 Input voltage range		85 ~ 264VAC 120 ~ 370VDC 47 ~ 63Hz			
冲击电流 Impact current		冷启动电流 30A/230VAC Cold start current			
过载保护 Overload protection		105% ~ 150% 切断输出, 自动恢复 105% ~ 150% cut off the output, automatic recovery			
过电压保护 Over voltage protection		115% ~ 135% 关闭输出, 电源重启后可恢复输出 115% ~ 135% shut down O/P voltage, re-power on to recover			
启动、上升、保持时间 Setup, rise, hold up time		300ms, 50ms, 80ms/230VAC 满负载 at full load			
耐压性 Withstand voltage		输入输出间: 1.5kV 输入与外壳间: 1.5kV 输出与外壳间: 0.5kV 一分钟 I/P-O/P: 1.5kV I/P-FG: 1.5kV O/P-FG: 0.5kV 1minute			
隔离电阻 Isolation resistance		输入输出间 输入与外壳间 输出与外壳间: 500VDC/100MΩ I/P-O/P I/P-FG O/P-FG: 500VDC/100MΩ			
工作温度 Working temperature		-10°C ~ +50°C			
尺寸 Dimension		84 × 58 × 38mm			
重量 Weight		0.22kg			
包装 Packing		38 × 35 × 24CM/100PCS/22kg			

外形尺寸 Overall dimension(mm)

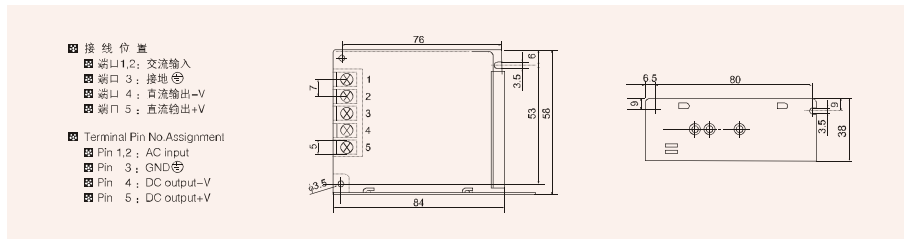

S-35W单组输出电源
S-35W Single output power supply

概述 Summary

- > 单组输出，功率35W
Single output: power 35W
- > 输入电压：90 ~ 132VAC/180 ~ 264VAC 由开关切换
Input voltage: 90 ~ 132VAC/180 ~ 264VAC by switch



常见规格 General Specification

129 × 98 × 38mm

性能 Specification	型号 Model	S-35-5	S-35-12	S-35-15	S-35-24
直流输出电压、电流 DC output voltage, current		5V 0~7A	12V 0~3A	15V 0~2.4A	24V 0~1.5A
纹波及噪音 Wave and noise		70mVp-p	100mVp-p	100mVp-p	100mVp-p
进线稳定度 Inlet wire stability		±0.5%	±0.5%	±0.5%	±0.5%
负载稳定度 Load stability		±1%	±0.5%	±0.5%	±0.5%
效率 Efficiency		70%	76%	78%	78%
直流电压可调范围 Adjustable range for DC voltage		±10%	±10%	±10%	±10%
输入电压范围 Input voltage range		90 ~ 132VAC/180 ~ 264VAC 由开关切换 254 ~ 370VDC 47 ~ 63Hz 90 ~ 132VAC/180 ~ 264VAC by switch 254 ~ 370VDC 47 ~ 63Hz			
冲击电流 Impact current		冷启动电流 18A/115VAC 36A/230VAC Cold start current			
过载保护 Overload protection		105% ~ 150% 切断输出, 自动恢复 105% ~ 150% cut off the output, automatic recovery			
过电压保护 Over voltage protection					
启动、上升、保持时间 Setup, rise, hold up time		200ms, 100ms, 30ms/230VAC 满负载 at full load			
耐压性 Withstand voltage		输入输出间: 1.5kV 输入与外壳间: 1.5kV 输出与外壳间: 0.5kV 一分钟 I/P-O/P: 1.5kV I/P-FG: 1.5kV O/P-FG: 0.5kV 1minute			
隔离电阻 Isolation resistance		输入输出间 输入与外壳间 输出与外壳间: 500VDC/100MΩ I/P-O/P I/P-FG O/P-FG: 500VDC/100MΩ			
工作温度 Working temperature		-10°C ~ +50°C			
尺寸 Dimension		129 × 98 × 38mm			
重量 Weight		0.4kg			
包装 Packing		43 × 32.5 × 24CM/45PCS/18kg			

外形尺寸 Overall dimension(mm)

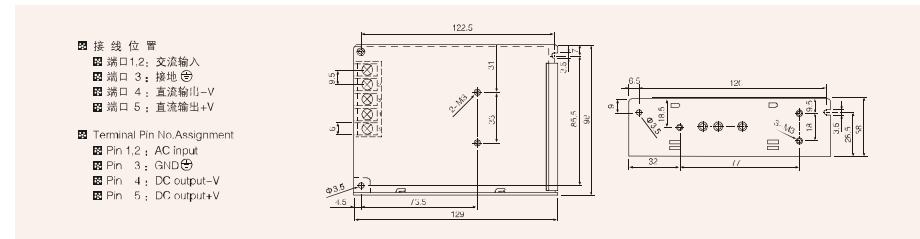

MS-50W单组输出小体积电源
MS-50W Single output mini-size power supply

概述 Summary

- > 单组输出; 功率50W
Single output: power 50W
- > 输入电压: 85 ~ 264VAC 120 ~ 370VDC
Input voltage: 85 ~ 264VAC 120 ~ 370VDC



常见规格 General Specification

111 × 78 × 36mm

性能 Specification	型号 Model	MS-50-5	MS-50-12	MS-50-15	MS-50-24
直流输出电压、电流 DC output voltage, current		5V 0 ~ 10A	12V 0 ~ 4.2A	15V 0 ~ 3.4A	24V 0 ~ 2.1A
纹波及噪音 Wave and noise		75mVp-p	100mVp-p	100mVp-p	100mVp-p
进线稳定度 Inlet wire stability		± 0.5%	± 0.5%	± 0.5%	± 0.5%
负载稳定度 Load stability		± 1%	± 0.5%	± 0.5%	± 0.5%
效率 Efficiency		80%	82%	82%	84%
直流电压可调范围 Adjustable range for DC voltage		± 10%	± 10%	± 10%	± 10%
输入电压范围 Input voltage range		85 ~ 264VAC 120 ~ 370VDC 47 ~ 63Hz			
冲击电流 Impact current		冷启动电流 18A/115VAC 36A/230VAC Cold start current			
过载保护 Overload protection		105% ~ 150% 切断输出, 自动恢复 105% ~ 150% cut off the output, automatic recovery			
过电压保护 Over voltage protection		115% ~ 135% 关闭输出, 电源重启后可恢复输出 115% ~ 135% shut down O/P voltage, re-power on to recover			
启动、上升、保持时间 Setup, rise, hold up time		300ms, 50ms, 60ms/230VAC 满载 at full load			
耐压性 Withstand voltage		输入输出间: 1.5kV 输入与外壳间: 1.5kV 输出与外壳间: 0.5kV 一分钟 I/P-O/P: 1.5kV I/P-FG: 1.5kV O/P-FG: 0.5kV 1minute			
隔离电阻 Isolation resistance		输入输出间 输入与外壳间 输出与外壳间: 500VDC/100MΩ I/P-O/P I/P-FG O/P-FG: 500VDC/100MΩ			
工作温度 Working temperature		-10°C ~ +50°C			
尺寸 Dimension		111 × 78 × 36mm			
重量 Weight		0.27kg			
包装 Packing		42 × 35 × 25CM/80PCS/21kg			

外形尺寸 Overall dimension(mm)

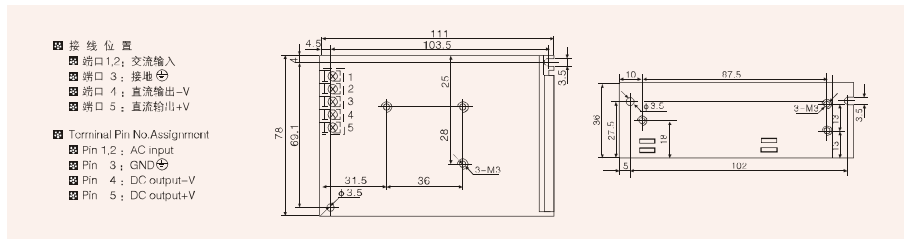

S-50W单组输出电源
S-50W Single output power supply

概述 Summary

- > 单组输出; 功率50W
Single output: power 50W
- > 输入电压: 90 ~ 132VAC/180 ~ 264VAC 由开关切换
Input voltage: 90 ~ 132VAC/180 ~ 264VAC by switch



常见规格 General Specification

159 × 98 × 38mm

性能 Specification	型号 Model	S-50-5	S-50-12	S-50-15	S-50-24
直流输出电压、电流 DC output voltage, current		5V 0 ~ 10A	12V 0 ~ 4.2A	15V 0 ~ 3.4A	24V 0 ~ 2.1A
纹波及噪音 Wave and noise		75mVp-p	100mVp-p	100mVp-p	100mVp-p
进线稳定度 Inlet wire stability		± 0.5%	± 0.5%	± 0.5%	± 0.5%
负载稳定度 Load stability		± 1%	± 0.5%	± 0.5%	± 0.5%
效率 Efficiency		71%	78%	78%	82%
直流电压可调范围 Adjustable range for DC voltage		± 10%	± 10%	± 10%	± 10%
输入电压范围 Input voltage range		90 ~ 132VAC/180 ~ 264VAC 由开关切换 254 ~ 370VDC 47 ~ 63Hz 90 ~ 132VAC/180 ~ 264VAC by switch 254 ~ 370VDC 47 ~ 63Hz			
冲击电流 Impact current		冷启动电流 18A/115VAC 36A/230VAC Cold start current			
过载保护 Overload protection		105% ~ 150% 切断输出, 自动恢复 105% ~ 150% cut off the output, automatic recovery			
过电压保护 Over voltage protection					
启动、上升、保持时间 Setup, rise, hold up time		200ms, 100ms, 20ms/230VAC 满载 at full load			
耐压性 Withstand voltage		输入输出间: 1.5kV 输入与外壳间: 1.5kV 输出与外壳间: 0.5kV 一分钟 I/P-O/P: 1.5kV I/P-FG: 1.5kV O/P-FG: 0.5kV 1minute			
隔离电阻 Isolation resistance		输入输出间 输入与外壳间 输出与外壳间: 500VDC/100MΩ I/P-O/P I/P-FG O/P-FG: 500VDC/100MΩ			
工作温度 Working temperature		-10°C ~ +50°C			
尺寸 Dimension		159 × 98 × 38mm			
重量 Weight		0.5kg			
包装 Packing		34 × 32 × 24CM/30PCS/15kg			

外形尺寸 Overall dimension(mm)

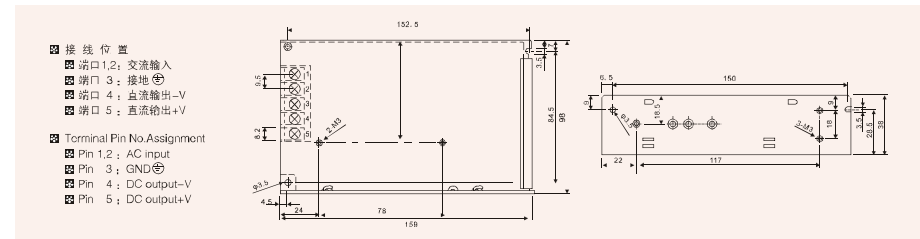

MS-60W单组输出小体积电源
MS-60W Single output mini-size power supply

概述 Summary

- > 单组输出，功率60W
Single output: power 60W
- > 输入电压：85 ~ 264VAC 120 ~ 370VDC
Input voltage: 85 ~ 264VAC 120 ~ 370VDC



111 × 78 × 36mm

常见规格 General Specification

性能 Specification	型号 Model	MS-60-5	MS-60-12	MS-60-15	MS-60-24
直流输出电压、电流 DC output voltage, current		5V 0 ~ 12A	12V 0 ~ 5A	15V 0 ~ 4A	24V 0 ~ 2.5A
纹波及噪音 Wave and noise		75mVp-p	100mVp-p	100mVp-p	100mVp-p
进线稳定度 Inlet wire stability		± 0.5%	± 0.5%	± 0.5%	± 0.5%
负载稳定度 Load stability		± 1%	± 0.5%	± 0.5%	± 0.5%
效率 Efficiency		80%	82%	82%	84%
直流电压可调范围 Adjustable range for DC voltage		± 10%	± 10%	± 10%	± 10%
输入电压范围 Input voltage range		85 ~ 264VAC 120 ~ 370VDC 47 ~ 63Hz			
冲击电流 Impact current		冷启动电流 15A/115VAC 30A/230VAC Cold start current			
过载保护 Overload protection		105% ~ 150% 切断输出，自动恢复 105% ~ 150% cut off the output, automatic recovery			
过电压保护 Over voltage protection					
启动、上升、保持时间 Setup, rise, hold up time		200ms, 100ms, 20ms/230VAC 满载 at full load			
耐压性 Withstand voltage		输入输出间: 1.5kV 输入与外壳间: 1.5kV 输出与外壳间: 0.5kV 一分钟 I/P-O/P: 1.5kV I/P-FG: 1.5kV O/P-FG: 0.5kV 1minute			
隔离电阻 Isolation resistance		输入输出间 输入与外壳间 输出与外壳间: 500VDC/100MΩ I/P-O/P I/P-FG O/P-FG: 500VDC/100MΩ			
工作温度 Working temperature		-10°C ~ +50°C			
尺寸 Dimension		111 × 78 × 36mm			
重量 Weight		0.27kg			
包装 Packing		42 × 35 × 25CM/80PCS/21kg			

外形尺寸 Overall dimension(mm)

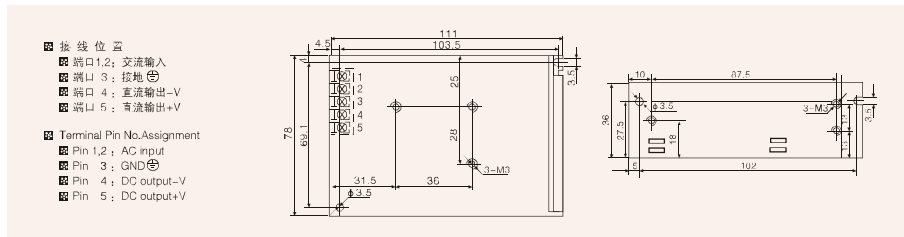

S-60W单组输出电源
S-60W Single output power supply

概述 Summary

- > 单组输出，功率60W
Single output: power 60W
- > 输入电压：90 ~ 132VAC/180 ~ 264VAC 由开关切换
Input voltage: 90 ~ 132VAC/180 ~ 264VAC by switch



159 × 98 × 38mm

常见规格 General Specification

性能 Specification	型号 Model	S-60-5	S-60-12	S-60-15	S-60-24
直流输出电压、电流 DC output voltage, current		5V 0 ~ 12A	12V 0 ~ 5A	15V 0 ~ 4A	24V 0 ~ 2.5A
纹波及噪音 Wave and noise		75mVp-p	100mVp-p	100mVp-p	100mVp-p
进线稳定度 Inlet wire stability		± 0.5%	± 0.5%	± 0.5%	± 0.5%
负载稳定度 Load stability		± 1%	± 0.5%	± 0.5%	± 0.5%
效率 Efficiency		72%	78%	79%	82%
直流电压可调范围 Adjustable range for DC voltage		± 10%	± 10%	± 10%	± 10%
输入电压范围 Input voltage range		90 ~ 132VAC/180 ~ 264VAC 由开关切换 254 ~ 370VDC 47 ~ 63Hz 90 ~ 132VAC/180 ~ 264VAC by switch 254 ~ 370VDC 47 ~ 63Hz			
冲击电流 Impact current		冷启动电流 15A/115VAC 30A/230VAC Cold start current			
过载保护 Overload protection		105% ~ 150% 切断输出，自动恢复 105% ~ 150% cut off the output, automatic recovery			
过电压保护 Over voltage protection					
启动、上升、保持时间 Setup, rise, hold up time		200ms, 100ms, 20ms/230VAC 满载 at full load			
耐压性 Withstand voltage		输入输出间: 1.5kV 输入与外壳间: 1.5kV 输出与外壳间: 0.5kV 一分钟 I/P-O/P: 1.5kV I/P-FG: 1.5kV O/P-FG: 0.5kV 1minute			
隔离电阻 Isolation resistance		输入输出间 输入与外壳间 输出与外壳间: 500VDC/100MΩ I/P-O/P I/P-FG O/P-FG: 500VDC/100MΩ			
工作温度 Working temperature		-10°C ~ +50°C			
尺寸 Dimension		159 × 98 × 38mm			
重量 Weight		0.5kg			
包装 Packing		34 × 32 × 24CM/30PCS/15kg			

外形尺寸 Overall dimension(mm)

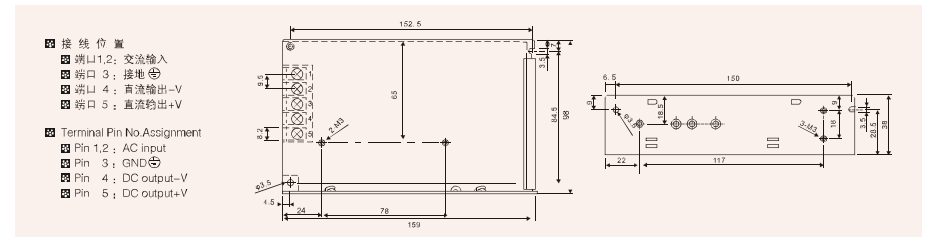

S-75W单组输出电源
S-75W Single output power supply

概述 Summary

- > 单组输出，功率75W
Single output: power 75W
- > 输入电压：90 ~ 132VAC/180 ~ 264VAC 由开关切换
Input voltage: 90 ~ 132VAC/180 ~ 264VAC by switch



常见规格 General Specification

159 x 98 x 38mm

性能 Specification	型号 Model	S-75-12	S-75-15	S-75-24	S-75-48
直流输出电压、电流 DC output voltage, current		12V 0~6A	15V 0~5A	24V 0~3.2A	48V 0~1.5A
纹波及噪音 Wave and noise		100mVp-p	100mVp-p	120mVp-p	150mVp-p
进线稳定度 Inlet wire stability		± 0.5%	± 0.5%	± 0.5%	± 0.5%
负载稳定度 Load stability		± 0.5%	± 0.5%	± 0.5%	± 0.5%
效率 Efficiency		78%	79%	82%	83%
直流电压可调范围 Adjustable range for DC voltage		± 10%	± 10%	± 10%	± 10%
输入电压范围 Input voltage range		90 ~ 132VAC/180 ~ 264VAC 由开关切换 254 ~ 370VDC 47 ~ 63Hz 90 ~ 132VAC/180 ~ 264VAC by switch 254 ~ 370VDC 47 ~ 63Hz			
冲击电流 Impact current	冷启动电流 Cold start current	15A/115VAC 30A/230VAC			
过载保护 Overload protection		105% ~ 150% 切断输出, 自动恢复 105% ~ 150% cut off the output, automatic recovery			
过电压保护 Over voltage protection					
启动、上升、保持时间 Setup, rise, hold up time		200ms, 50ms, 20ms/230VAC 满负载 at full load			
耐压性 Withstand voltage		输入输出间: 1.5kV 输入与外壳间: 1.5kV 输出与外壳间: 0.5kV 一分钟 I/P-O/P: 1.5kV I/P-FG: 1.5kV O/P-FG: 0.5kV 1minute			
隔离电阻 Isolation resistance		输入输出间 输入与外壳间 输出与外壳间: 500VDC/100MΩ I/P-O/P I/P-FG O/P-FG: 500VDC/100MΩ			
工作温度 Working temperature		-10°C ~ +50°C			
尺寸 Dimension		159 x 96 x 38mm			
重量 Weight		0.55kg			
包装 Packing		34 x 32 x 24CM/30PCS/16.5kg			

外形尺寸 Overall dimension(mm)

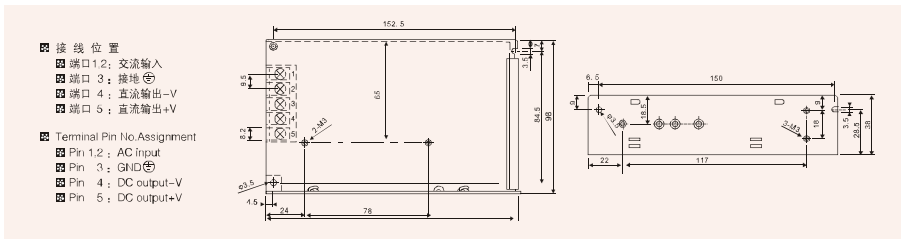

MS-100W单组输出小体积电源
MS-100W Single output mini-size power supply

概述 Summary

- > 单组输出，功率100W
Single output: power 100W
- > 输入电压：90 ~ 132VAC/180 ~ 264VAC 由开关切换
Input voltage: 90 ~ 132VAC/180 ~ 264VAC by switch



常见规格 General Specification

159 x 98 x 38mm

性能 Specification	型号 Model	MS-100-5	MS-100-12	MS-100-15	MS-100-24
直流输出电压、电流 DC output voltage, current		5V 0 ~ 20A	12V 0 ~ 8.5A	15V 0 ~ 7A	24V 0 ~ 4.5A
纹波及噪音 Wave and noise		100mVp-p	120mVp-p	120mVp-p	150mVp-p
进线稳定度 Inlet wire stability		± 0.5%	± 0.5%	± 0.5%	± 0.5%
负载稳定度 Load stability		± 0.5%	± 0.5%	± 0.5%	± 0.5%
效率 Efficiency		80%	83%	84%	86%
直流电压可调范围 Adjustable range for DC voltage		± 10%	± 10%	± 10%	± 10%
输入电压范围 Input voltage range		90 ~ 132VAC/180 ~ 264VAC 由开关切换 254 ~ 370VDC 47 ~ 63Hz 90 ~ 132VAC/180 ~ 264VAC by switch 254 ~ 370VDC 47 ~ 63Hz			
冲击电流 Impact current	冷启动电流 Cold start current	15A/115VAC 30A/230VAC			
过载保护 Overload protection		105% ~ 150% 切断输出, 自动恢复 105% ~ 150% cut off the output, automatic recovery			
过电压保护 Over voltage protection		115% ~ 135% 关闭输出, 电源重启后可恢复输出 115% ~ 135% shut down O/P voltage, re-power on to recover			
启动、上升、保持时间 Setup, rise, hold up time		200ms, 50ms, 20ms/230VAC 满负载 at full load			
耐压性 Withstand voltage		输入输出间: 1.5kV 输入与外壳间: 1.5kV 输出与外壳间: 0.5kV 一分钟 I/P-O/P: 1.5kV I/P-FG: 1.5kV O/P-FG: 0.5kV 1minute			
隔离电阻 Isolation resistance		输入输出间 输入与外壳间 输出与外壳间: 500VDC/100MΩ I/P-O/P I/P-FG O/P-FG: 500VDC/100MΩ			
工作温度 Working temperature		-10°C ~ +50°C			
尺寸 Dimension		159 x 96 x 38mm			
重量 Weight		0.55kg			
包装 Packing		34 x 32 x 24CM/30PCS/16.5kg			

外形尺寸 Overall dimension(mm)

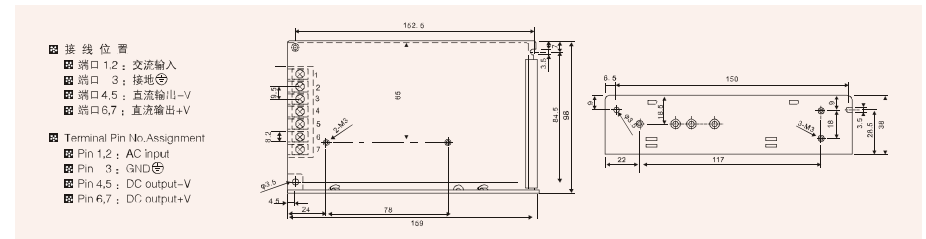

S-100W单组输出电源
S-100W Single output power supply

概述 Summary

- > 单组输出，功率100W
Single output: power 100W
- > 输入电压：90 ~ 132VAC/180 ~ 264VAC 由开关切换
Input voltage: 90 ~ 132VAC/180 ~ 264VAC by switch



常见规格 General Specification

199 × 98 × 38mm

性能 Specification	型号 Model	S-100-5	S-100-12	S-100-18	S-100-24	S-100-36	S-100-48
直流输出电压、电流 DC output voltage, current		5V 0~20A	12V 0~8.5A	18V 0~5.5A	24V 0~4.5A	36V 0~3A	48V 0~2.1A
纹波及噪音 Wave and noise		75mVp-p	100mVp-p	100mVp-p	100mVp-p	100mVp-p	100mVp-p
进线稳定度 Inlet wire stability		±0.5%	±0.3%	±0.2%	±0.2%	±0.2%	±0.2%
负载稳定度 Load stability		±0.5%	±0.3%	±0.2%	±0.2%	±0.2%	±0.2%
效率 Efficiency		78%	81%	84%	84%	84%	84%
直流电压可调范围 Adjustable range for DC voltage		±10%	±10%	±10%	±10%	±10%	±10%
输入电压范围 Input voltage range		90 ~ 132VAC/180 ~ 264VAC 由开关切换 254 ~ 370VDC 47 ~ 63Hz 90 ~ 132VAC/180 ~ 264VAC by switch 254 ~ 370VDC 47 ~ 63Hz					
冲击电流 Impact current		冷启动电流 Cold start current 30A/115VAC 60A/230VAC					
过载保护 Overload protection		105% ~ 150% 切断输出，自动恢复 105% ~ 150% cut off the output, automatic recovery					
过电压保护 Over voltage protection							
启动、上升、保持时间 Setup, rise, hold up time		200ms, 50ms, 20ms/230VAC 满载 at full load					
耐压性 Withstand voltage		输入输出间: 1.5kV 输入与外壳间: 1.5kV 输出与外壳间: 0.5kV 一分钟 I/P-O/P: 1.5kV I/P-FG: 1.5kV O/P-FG: 0.5kV 1minute					
隔离电阻 Isolation resistance		输入输出间 输入与外壳间 输出与外壳间: 500VDC/100MΩ I/P-O/P I/P-FG O/P-FG: 500VDC/100MΩ					
工作温度 Working temperature		-10°C ~ +50°C					
尺寸 Dimension		199 × 98 × 38mm					
重量 Weight		0.6kg					
包装 Packing		43 × 32.5 × 24CM/30PCS/18kg					

外形尺寸 Overall dimension(mm)

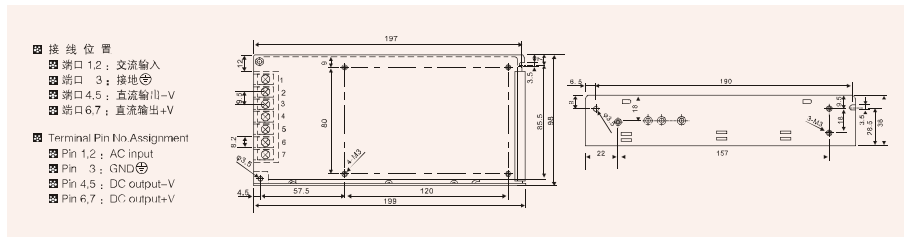

S-120W单组输出电源
S-120W Single output power supply

概述 Summary

- > 单组输出，功率120W
Single output: power 120W
- > 输入电压：90 ~ 132VAC/180 ~ 264VAC 由开关切换
Input voltage: 90 ~ 132VAC/180 ~ 264VAC by switch



常见规格 General Specification

199 × 98 × 38mm

性能 Specification	型号 Model	S-120-12	S-120-15	S-120-18	S-120-24	S-120-36	S-120-48
直流输出电压、电流 DC output voltage, current		12V 0~10A	15V 0~8A	18V 0~6.7A	24V 0~5A	36V 0~3.3A	48V 0~2.5A
纹波及噪音 Wave and noise		100mVp-p	100mVp-p	100mVp-p	100mVp-p	100mVp-p	100mVp-p
进线稳定度 Inlet wire stability		±0.3%	±0.3%	±0.2%	±0.2%	±0.2%	±0.2%
负载稳定度 Load stability		±0.3%	±0.3%	±0.2%	±0.2%	±0.2%	±0.2%
效率 Efficiency		81%	82%	84%	84%	84%	84%
直流电压可调范围 Adjustable range for DC voltage		±10%	±10%	±10%	±10%	±10%	±10%
输入电压范围 Input voltage range		90 ~ 132VAC/180 ~ 264VAC 由开关切换 254 ~ 370VDC 47 ~ 63Hz 90 ~ 132VAC/180 ~ 264VAC by switch 254 ~ 370VDC 47 ~ 63Hz					
冲击电流 Impact current		冷启动电流 Cold start current 30A/115VAC 60A/230VAC					
过载保护 Overload protection		105% ~ 150% 切断输出，自动恢复 105% ~ 150% cut off the output, automatic recovery					
过电压保护 Over voltage protection		115% ~ 135% 关闭输出，电源重启后可恢复输出 115% ~ 135% shut down O/P voltage, re-power on to recover					
启动、上升、保持时间 Setup, rise, hold up time		200ms, 50ms, 20ms/230VAC 满载 at full load					
耐压性 Withstand voltage		输入输出间: 1.5kV 输入与外壳间: 1.5kV 输出与外壳间: 0.5kV 一分钟 I/P-O/P: 1.5kV I/P-FG: 1.5kV O/P-FG: 0.5kV 1minute					
隔离电阻 Isolation resistance		输入输出间 输入与外壳间 输出与外壳间: 500VDC/100MΩ I/P-O/P I/P-FG O/P-FG: 500VDC/100MΩ					
工作温度 Working temperature		-10°C ~ +50°C					
尺寸 Dimension		199 × 98 × 38mm					
重量 Weight		0.6kg					
包装 Packing		43 × 32.5 × 24CM/30PCS/18kg					

外形尺寸 Overall dimension(mm)

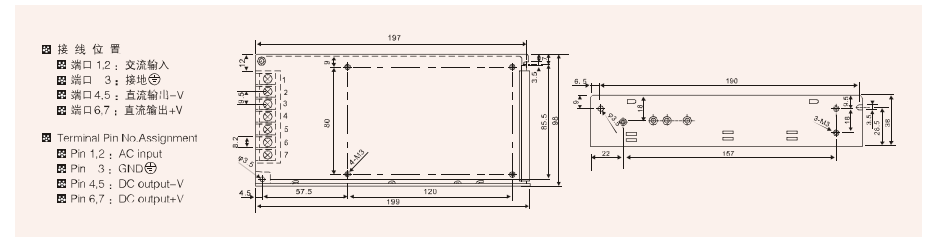

S-145W单组输出电源
S-145W Single output power supply

概述 Summary

- > 单组输出，功率145W
Single output: power 145W
- > 输入电压：90 ~ 132VAC/180 ~ 264VAC 由开关切换
Input voltage: 90 ~ 132VAC/180 ~ 264VAC by switch



常见规格 General Specification

199 x 98 x 38mm

性能 Specification	型号 Model	S-145-5	S-145-12	S-145-18	S-145-24	S-145-36	S-145-48
直流输出电压、电流 DC output voltage, current		5V 0 ~ 25A	12V 0 ~ 12A	18V 0 ~ 8A	24V 0 ~ 6A	36V 0 ~ 4A	48V 0 ~ 3A
纹波及噪音 Wave and noise		100mVp-p	100mVp-p	100mVp-p	100mVp-p	100mVp-p	100mVp-p
进线稳定度 Inlet wire stability		±0.5%	±0.3%	±0.3%	±0.2%	±0.2%	±0.2%
负载稳定度 Load stability		±0.5%	±0.3%	±0.3%	±0.2%	±0.2%	±0.2%
效率 Efficiency		70%	80.5%	80.5%	83.5%	83.5%	83.5%
直流电压可调范围 Adjustable range for DC voltage		±10%	±10%	±10%	±10%	±10%	±10%
输入电压范围 Input voltage range		90 ~ 132VAC/180 ~ 264VAC 由开关切换 254 ~ 370VDC 47 ~ 63Hz 90 ~ 132VAC/180 ~ 264VAC by switch 254 ~ 370VDC 47 ~ 63Hz					
冲击电流 Impact current		冷启动电流 Cold start current 35A/115VAC 60A/230VAC					
过载保护 Overload protection		105% ~ 150% 切断输出，自动恢复 105% ~ 150% cut off the output, automatic recovery					
过电压保护 Over voltage protection		115% ~ 150% 关闭输出，电源重启后可恢复输出 115% ~ 150% shut down O/P voltage, re-power on to recover					
启动、上升、保持时间 Setup, rise, hold up time		100ms, 50ms, 20ms/230VAC 满负载 at full load					
耐压性 Withstand voltage		输入输出间: 1.5kV 输入与外壳间: 1.5kV 输出与外壳间: 0.5kV 一分钟 I/P-O/P: 1.5kV I/P-FG: 1.5kV O/P-FG: 0.5kV 1minute					
隔离电阻 Isolation resistance		输入输出间 输入与外壳间 输出与外壳间: 500VDC/100MΩ I/P-O/P I/P-FG O/P-FG: 500VDC/100MΩ					
工作温度 Working temperature		-10°C ~ +50°C					
尺寸 Dimension		199 x 98 x 38mm					
重量 Weight		0.7kg					
包装 Packing		43 x 32.5 x 24CM/30PCS/2.1kg					

外形尺寸 Overall dimension(mm)

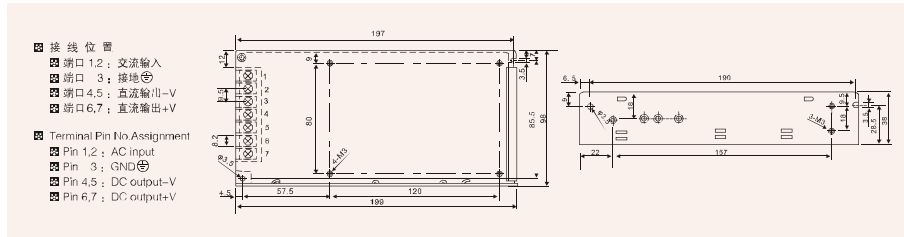

MS-150W单组输出小体积电源
MS-150W Single output mini-size power supply

概述 Summary

- > 单组输出，功率150W
Single output: power 150W
- > 输入电压：90 ~ 132VAC/180 ~ 264VAC 由开关切换
Input voltage: 90 ~ 132VAC/180 ~ 264VAC by switch



常见规格 General Specification

159 x 98 x 38mm

性能 Specification	型号 Model	MS-150-12	MS-150-15	MS-150-24	MS-150-27	MS-150-36	MS-150-48
直流输出电压、电流 DC output voltage, current		12V 0 ~ 12.5A	15V 0 ~ 10A	24V 0 ~ 6.5A	27V 0 ~ 5.5A	36V 0 ~ 4.17A	48V 0 ~ 3.13A
纹波及噪音 Wave and noise		100mVp-p	100mVp-p	100mVp-p	100mVp-p	100mVp-p	100mVp-p
进线稳定度 Inlet wire stability		±0.5%	±0.5%	±0.5%	±0.5%	±0.5%	±0.5%
负载稳定度 Load stability		±0.5%	±0.5%	±0.5%	±0.5%	±0.5%	±0.5%
效率 Efficiency		83%	84%	86%	86%	86%	86%
直流电压可调范围 Adjustable range for DC voltage		±10%	±10%	±10%	±10%	±10%	±10%
输入电压范围 Input voltage range		90 ~ 132VAC/180 ~ 264VAC 由开关切换 254 ~ 370VDC 47 ~ 63Hz 90 ~ 132VAC/180 ~ 264VAC by switch 254 ~ 370VDC 47 ~ 63Hz					
冲击电流 Impact current		冷启动电流 Cold start current 15A/115VAC 30A/230VAC					
过载保护 Overload protection		105% ~ 150% 切断输出，自动恢复 105% ~ 150% cut off the output, automatic recovery					
过电压保护 Over voltage protection		115% ~ 150% 关闭输出，电源重启后可恢复输出 115% ~ 150% shut down O/P voltage, re-power on to recover					
启动、上升、保持时间 Setup, rise, hold up time		200ms, 50ms, 20ms/230VAC 满负载 at full load					
耐压性 Withstand voltage		输入输出间: 1.5kV 输入与外壳间: 1.5kV 输出与外壳间: 0.5kV 一分钟 I/P-O/P: 1.5kV I/P-FG: 1.5kV O/P-FG: 0.5kV 1minute					
隔离电阻 Isolation resistance		输入输出间 输入与外壳间 输出与外壳间: 500VDC/100MΩ I/P-O/P I/P-FG O/P-FG: 500VDC/100MΩ					
工作温度 Working temperature		-10°C ~ +50°C					
尺寸 Dimension		159 x 98 x 38mm					
重量 Weight		0.55kg					
包装 Packing		34 x 32 x 24CM/30PCS/16.5kg					

外形尺寸 Overall dimension(mm)

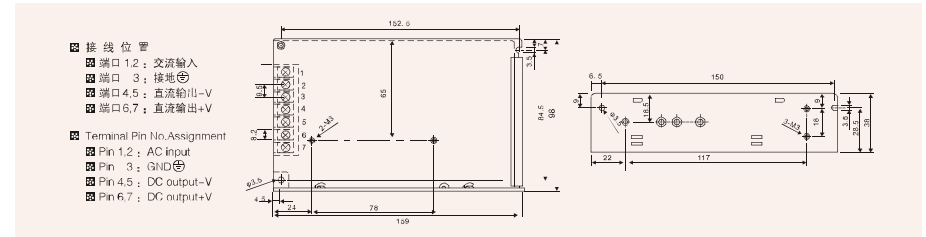

S-150W单组输出电源
S-150W Single output power supply

概述 Summary

- > 单组输出，功率150W
Single output: power 150W
- > 输入电压：90 ~ 132VAC/180 ~ 264VAC 由开关切换
Input voltage: 90 ~ 132VAC/180 ~ 264VAC by switch



199 x 110 x 50mm

常见规格 General Specification

性能 Specification	型号 Model	S-150-5	S-150-12	S-150-15	S-150-24	S-150-36	S-150-48
直流输出电压、电流 DC output voltage, current		5V 0~30A	12V 0~12.5A	15V 0~10A	24V 0~6.5A	36V 0~4.17A	48V 0~3.13A
纹波及噪音 Wave and noise		150mVp-p	180mVp-p	180mVp-p	240mVp-p	240mVp-p	240mVp-p
进线稳定度 Inlet wire stability		±0.5%	±0.3%	±0.3%	±0.2%	±0.2%	±0.2%
负载稳定度 Load stability		±0.8%	±0.3%	±0.3%	±0.2%	±0.2%	±0.2%
效率 Efficiency		78%	82%	84%	85%	86%	87%
直流电压可调范围 Adjustable range for DC voltage		±10%	±10%	±10%	±10%	±10%	±10%
输入电压范围 Input voltage range		90 ~ 132VAC/180 ~ 264VAC 由开关切换 254 ~ 370VDC 47 ~ 63Hz 90 ~ 132VAC/180 ~ 264VAC by switch 254 ~ 370VDC 47 ~ 63Hz					
冲击电流 Impact current		冷启动电流 Cold start current 35A/230VAC					
过载保护 Overload protection		105% ~ 150% 切断输出，自动恢复 105% ~ 150% cut off the output, automatic recovery					
过电压保护 Over voltage protection		115% ~ 135% 关闭输出，电源重启后可恢复输出 115% ~ 135% shut down O/P voltage, re-power on to recover					
启动、上升、保持时间 Setup, rise, hold up time		100ms, 50ms, 20ms/230VAC 满负载 at full load					
耐压性 Withstand voltage		输入输出间：1.5kV 输入与外壳间：1.5kV 输出与外壳间：0.5kV 一分钟 I/P-O/P: 1.5kV I/P-FG: 1.5kV O/P-FG: 0.5kV 1minute					
隔离电阻 Isolation resistance		输入输出间 输入与外壳间 输出与外壳间：500VDC/100MΩ I/P-O/P I/P-FG O/P-FG: 500VDC/100MΩ					
工作温度 Working temperature		-10°C ~ +50°C					
尺寸 Dimension		199 x 110 x 50mm					
重量 Weight		0.85kg					
包装 Packing		42 x 31.5 x 26CM/20PCS/17kg					

外形尺寸 Overall dimension(mm)

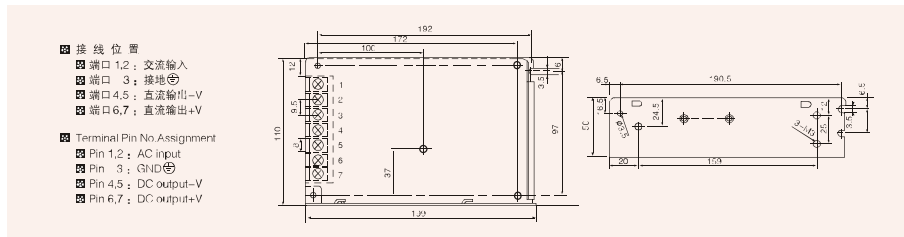

S-200W单组输出电源
S-200W Single output power supply

概述 Summary

- > 单组输出，功率200W
Single output: power 200W
- > 输入电压：90 ~ 132VAC或180 ~ 264VAC
Input voltage: 90 ~ 132VAC or 180 ~ 264VAC



199 x 110 x 50mm

常见规格 General Specification

性能 Specification	型号 Model	S-200-5	S-200-12	S-200-15	S-200-24	S-200-36	S-200-48
直流输出电压、电流 DC output voltage, current		5V 0~40A	12V 0~16.5A	15V 0~13.3A	24V 0~8.5A	36V 0~5.5A	48V 0~4.2A
纹波及噪音 Wave and noise		150mVp-p	150mVp-p	180mVp-p	180mVp-p	200mVp-p	200mVp-p
进线稳定度 Inlet wire stability		±0.5%	±0.5%	±0.5%	±0.5%	±0.5%	±0.5%
负载稳定度 Load stability		±1%	±0.5%	±0.5%	±0.5%	±0.5%	±0.5%
效率 Efficiency		79%	82%	83%	63%	86%	86%
直流电压可调范围 Adjustable range for DC voltage		±10%	±10%	±10%	±10%	±10%	±10%
输入电压范围 Input voltage range		90 ~ 132VAC或180 ~ 264VAC 90 ~ 132VAC or 180 ~ 264VAC					
冲击电流 Impact current		冷启动电流 Cold start current 15A/115VAC 30A/230VAC					
过载保护 Overload protection		105% ~ 201% 切断输出，自动恢复 105% ~ 201% cut off the output, automatic recovery					
过电压保护 Over voltage protection							
启动、上升、保持时间 Setup, rise, hold up time		200ms, 50ms, 20ms/230VAC 满负载 at full load					
耐压性 Withstand voltage		输入输出间：1.5kV 输入与外壳间：1.5kV 输出与外壳间：0.5kV 一分钟 I/P-O/P: 1.5kV I/P-FG: 1.5kV O/P-FG: 0.5kV 1minute					
隔离电阻 Isolation resistance		输入输出间 输入与外壳间 输出与外壳间：500VDC/100MΩ I/P-O/P I/P-FG O/P-FG: 500VDC/100MΩ					
工作温度 Working temperature		-10°C ~ +50°C					
尺寸 Dimension		199 x 110 x 50mm					
重量 Weight		0.9kg					
包装 Packing		42 x 31.5 x 26CM/20PCS/18kg					

外形尺寸 Overall dimension(mm)

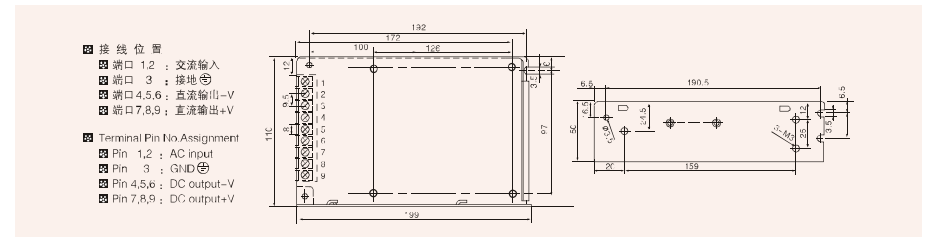

S-201W单组输出电源
S-201W Single output power supply

概述 Summary

- > 单组输出，功率200W
Single output: power 200W
- > 输入电压：90 ~ 132VAC/180 ~ 264VAC 由开关切换
Input voltage: 90 ~ 132VAC/180 ~ 264VAC by switch



常见规格 General Specification

215 x 115 x 50mm

性能 Specification	型号 Model	S-201-5	S-201-12	S-201-15	S-201-24	S-201-36	S-201-48
直流输出电压、电流 DC output voltage, current		5V 0~40A	12V 0~16.5A	15V 0~13.4A	24V 0~8.3A	36V 0~5.5A	48V 0~4.2A
纹波及噪音 Wave and noise		150mVp-p	150mVp-p	150mVp-p	150mVp-p	240mVp-p	240mVp-p
进线稳定度 Inlet wire stability		±0.5%	±0.5%	±0.5%	±0.5%	±0.5%	±0.5%
负载稳定度 Load stability		±1%	±0.5%	±0.5%	±0.5%	±0.5%	±0.5%
效率 Efficiency		74%	80%	80%	83%	84%	84%
直流电压可调范围 Adjustable range for DC voltage		±10%	±10%	±10%	±10%	±10%	±10%
输入电压范围 Input voltage range		90 ~ 132VAC/180 ~ 264VAC 由开关切换 254 ~ 370VDC 47 ~ 63Hz 90 ~ 132VAC/180 ~ 264VAC by switch 254 ~ 370VDC 47 ~ 63Hz					
冲击电流 Impact current		冷启动电流 Cold start current 25A/115VAC 50A/230VAC					
过载保护 Overload protection		105% ~ 135% 切断输出，自动恢复 105% ~ 135% cut off the output, automatic recovery					
过电压保护 Over voltage protection		115% ~ 145% 关闭输出，电源重启后可恢复输出 115% ~ 145% shut down O/P voltage, re-power on to recover					
启动、上升、保持时间 Setup, rise, hold up time		200ms, 100ms, 20ms/230VAC 满负载 at full load					
耐压性 Withstand voltage		输入输出间：1.5kV 输入与外壳间：1.5kV 输出与外壳间：0.5kV 一分钟 I/P-O/P: 1.5kV I/P-FG: 1.5kV O/P-FG: 0.5kV 1minute					
隔离电阻 Isolation resistance		输入输出间 输入与外壳间 输出与外壳间：500VDC/100MΩ I/P-O/P I/P-FG O/P-FG: 500VDC/100MΩ					
工作温度 Working temperature		-10°C ~ +50°C					
尺寸 Dimension		215 x 115 x 50mm					
重量 Weight		0.9kg					
包装 Packing		45.5 x 31.5 x 26CM/20PCS/18kg					

外形尺寸 Overall dimension(mm)

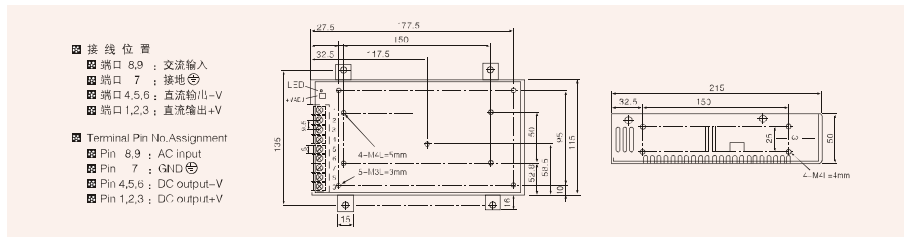

S-250W单组输出电源
S-250W Single output power supply

概述 Summary

- > 单组输出，功率250W
Single output: power 250W
- > 输入电压：90 ~ 132VAC/180 ~ 264VAC 由开关切换
Input voltage: 90 ~ 132VAC/180 ~ 264VAC by switch



常见规格 General Specification

215 x 115 x 50mm

性能 Specification	型号 Model	S-250-5	S-250-12	S-250-15	S-250-24	S-250-36	S-250-48
直流输出电压、电流 DC output voltage, current		5V 0~45A	12V 0~20A	15V 0~16A	24V 0~10A	36V 0~6.7A	48V 0~5A
纹波及噪音 Wave and noise		150mVp-p	150mVp-p	150mVp-p	150mVp-p	200mVp-p	240mVp-p
进线稳定度 Inlet wire stability		±2%	±1%	±1%	±1%	±1%	±1%
负载稳定度 Load stability		±2%	±1%	±1%	±1%	±1%	±1%
效率 Efficiency		74%	79%	79%	81.5%	84%	84%
直流电压可调范围 Adjustable range for DC voltage		±10%	±10%	±10%	±10%	±10%	±10%
输入电压范围 Input voltage range		90 ~ 132VAC/180 ~ 264VAC 由开关切换 254 ~ 370VDC 47 ~ 63Hz 90 ~ 132VAC/180 ~ 264VAC by switch 254 ~ 370VDC 47 ~ 63Hz					
冲击电流 Impact current		冷启动电流 Cold start current 25A/115VAC 50A/230VAC					
过载保护 Overload protection		105% ~ 135% 切断输出，自动恢复 105% ~ 135% cut off the output, automatic recovery					
过电压保护 Over voltage protection		115% ~ 150% 关闭输出，电源重启后可恢复输出 115% ~ 150% shut down O/P voltage, re-power on to recover					
启动、上升、保持时间 Setup, rise, hold up time		200ms, 50ms, 16ms/230VAC 满负载 at full load					
耐压性 Withstand voltage		输入输出间：1.5kV 输入与外壳间：1.5kV 输出与外壳间：0.5kV 一分钟 I/P-O/P: 1.5kV I/P-FG: 1.5kV O/P-FG: 0.5kV 1minute					
隔离电阻 Isolation resistance		输入输出间 输入与外壳间 输出与外壳间：500VDC/100MΩ I/P-O/P I/P-FG O/P-FG: 500VDC/100MΩ					
工作温度 Working temperature		-10°C ~ +50°C					
尺寸 Dimension		215 x 115 x 50mm					
重量 Weight		0.95kg					
包装 Packing		45.5 x 31.5 x 26CM/20PCS/19kg					

外形尺寸 Overall dimension(mm)

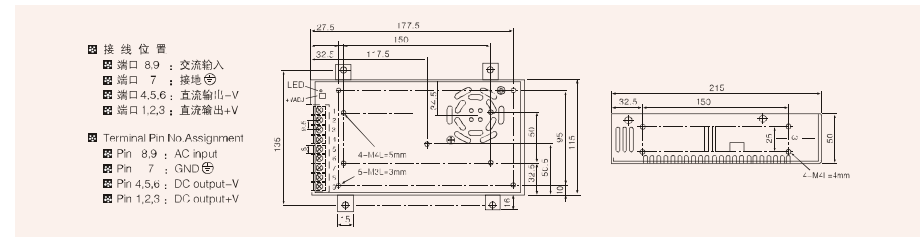

S-350W单组输出电源
S-350W Single output power supply

概述 Summary

- > 单组输出，功率350W
Single output: power 350W
- > 输入电压：90 ~ 132VAC/180 ~ 264VAC 由开关切换
Input voltage: 90 ~ 132VAC/180 ~ 264VAC by switch



常见规格 General Specification

215 × 115 × 50mm

性能 Specification	型号 Model	S-350-5	S-350-9	S-350-12	S-350-15	S-350-18	S-350-24
直流输出电压、电流 DC output voltage, current		5V 0~50A	9V 0~38A	12V 0~29A	15V 0~23.3A	18V 0~19.4A	24V 0~14.6A
纹波及噪音 Wave and noise		150mVp-p	150mVp-p	150mVp-p	150mVp-p	150mVp-p	150mVp-p
进线稳定度 Inlet wire stability		±0.5%	±0.5%	±0.5%	±0.5%	±0.5%	±0.5%
负载稳定度 Load stability		±0.5%	±0.5%	±0.5%	±0.5%	±0.5%	±0.5%
效率 Efficiency		73%	78%	83%	83%	84%	85%
直流电压可调范围 Adjustable range for DC voltage		±10%	±10%	±10%	±10%	±10%	±10%
输入电压范围 Input voltage range		90 ~ 132VAC/180 ~ 264VAC 由开关切换 254 ~ 370VDC 47 ~ 63Hz 90 ~ 132VAC/180 ~ 264VAC by switch 254 ~ 370VDC 47 ~ 63Hz					
冲击电流 Impact current		冷启动电流 Cold start current 25A/115VAC 50A/230VAC					
过载保护 Overload protection		105% ~ 135% 切断输出，自动恢复 105% ~ 135% cut off the output, automatic recovery					
过电压保护 Over voltage protection		115% ~ 150% 关闭输出，电源重启后可恢复输出 115% ~ 150% shut down O/P voltage, re-power on to recover					
启动、上升、保持时间 Setup, rise, hold up time		200ms, 50ms, 20ms/230VAC 满负载 at full load					
耐压性 Withstand voltage		输入输出间: 1.5kV 输入与外壳间: 1.5kV 输出与外壳间: 0.5kV 一分钟 I/P-O/P: 1.5kV I/P-FG: 1.5kV O/P-FG: 0.5kV 1minute					
隔离电阻 Isolation resistance		输入输出间 输入与外壳间 输出与外壳间: 500VDC/100MΩ I/P-O/P I/P-FG O/P-FG: 500VDC/100MΩ					
工作温度 Working temperature		-10°C ~ +50°C					
尺寸 Dimension		215 × 115 × 50mm					
重量 Weight		1kg					
包装 Packing		45.5 × 31.5 × 26CM/20PCS/20kg					

外形尺寸 Overall dimension(mm)

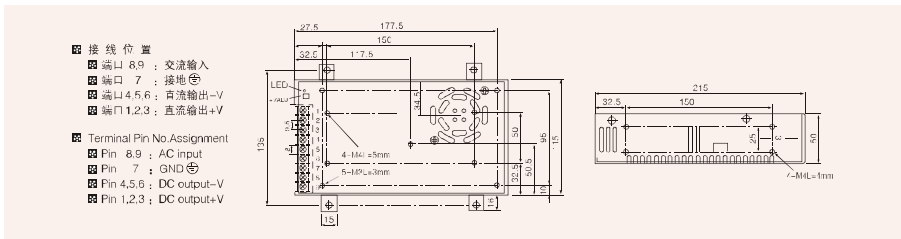

S-350W单组输出电源
S-350W Single output power supply

概述 Summary

- > 单组输出，功率350W
Single output: power 350W
- > 输入电压：90 ~ 132VAC/180 ~ 264VAC 由开关切换
Input voltage: 90 ~ 132VAC/180 ~ 264VAC by switch



常见规格 General Specification

215 × 115 × 50mm

性能 Specification	型号 Model	S-350-27	S-350-36	S-350-48	S-350-60	S-350-70	S-350-110
直流输出电压、电流 DC output voltage, current		27V 0~13A	36V 0~9.7A	48V 0~7.3A	60V 0~6A	70V 0~5A	110V 0~3.2A
纹波及噪音 Wave and noise		150mVp-p	150mVp-p	150mVp-p	200mVp-p	200mVp-p	240mVp-p
进线稳定度 Inlet wire stability		±0.5%	±0.5%	±0.5%	±0.5%	±0.5%	±0.5%
负载稳定度 Load stability		±0.5%	±0.5%	±0.5%	±0.5%	±0.5%	±0.5%
效率 Efficiency		85%	85%	86%	86%	86%	86%
直流电压可调范围 Adjustable range for DC voltage		±10%	±10%	±10%	±10%	±10%	±10%
输入电压范围 Input voltage range		90 ~ 132VAC/180 ~ 264VAC 由开关切换 254 ~ 370VDC 47 ~ 63Hz 90 ~ 132VAC/180 ~ 264VAC by switch 254 ~ 370VDC 47 ~ 63Hz					
冲击电流 Impact current		冷启动电流 Cold start current 25A/115VAC 50A/230VAC					
过载保护 Overload protection		105% ~ 135% 切断输出，自动恢复 105% ~ 135% cut off the output, automatic recovery					
过电压保护 Over voltage protection		115% ~ 150% 关闭输出，电源重启后可恢复输出 115% ~ 150% shut down O/P voltage, re-power on to recover					
启动、上升、保持时间 Setup, rise, hold up time		200ms, 50ms, 20ms/230VAC 满负载 at full load					
耐压性 Withstand voltage		输入输出间: 1.5kV 输入与外壳间: 1.5kV 输出与外壳间: 0.5kV 一分钟 I/P-O/P: 1.5kV I/P-FG: 1.5kV O/P-FG: 0.5kV 1minute					
隔离电阻 Isolation resistance		输入输出间 输入与外壳间 输出与外壳间: 500VDC/100MΩ I/P-O/P I/P-FG O/P-FG: 500VDC/100MΩ					
工作温度 Working temperature		-10°C ~ +50°C					
尺寸 Dimension		215 × 115 × 50mm					
重量 Weight		1kg					
包装 Packing		45.5 × 31.5 × 26CM/20PCS/20kg					

外形尺寸 Overall dimension(mm)

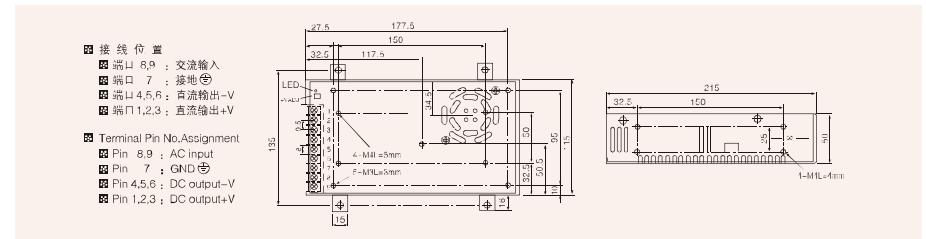

S-400W单组输出电源
S-400W Single output power supply

概述 Summary

- > 单组输出，功率400W
Single output: power 400W
- > 输入电压：90 ~ 132VAC/180 ~ 264VAC 由开关切换
Input voltage: 90 ~ 132VAC/180 ~ 264VAC by switch



215 × 115 × 50mm

常见规格 General Specification

性能 Specification	型号 Model	S-400-5	S-400-12	S-400-24	S-400-48
直流输出电压、电流 DC output voltage, current		5V 0 ~ 60A	12V 0 ~ 33A	24V 0 ~ 16.5A	48V 0 ~ 8.3A
纹波及噪音 Wave and noise		100mVp-p	150mVp-p	150mVp-p	200mVp-p
进线稳定度 Inlet wire stability		± 0.5%	± 0.5%	± 0.5%	± 0.5%
负载稳定度 Load stability		± 1%	± 0.5%	± 0.5%	± 0.5%
效率 Efficiency		73%	74%	81%	83%
直流电压可调范围 Adjustable range for DC voltage		± 10%	± 10%	± 10%	± 10%
输入电压范围 Input voltage range		90 ~ 132VAC/180 ~ 264VAC 由开关切换 254 ~ 370VDC 47 ~ 63Hz 90 ~ 132VAC/180 ~ 264VAC by switch 254 ~ 370VDC 47 ~ 63Hz			
冲击电流 Impact current	冷启动电流 Cold start current	25A/115VAC 50A/230VAC			
过载保护 Overload protection		105% ~ 135% 切断输出，自动恢复 105% ~ 135% cut off the output, automatic recovery			
过电压保护 Over voltage protection		115% ~ 150% 关闭输出，电源重启后可恢复输出 115% ~ 150% shut down O/P voltage, re-power on to recover			
启动、上升、保持时间 Setup, rise, hold up time		200ms, 50ms, 20ms/230VAC 满载 at full load			
耐压性 Withstand voltage		输入输出间: 1.5kV 输入与外壳间: 1.5kV 输出与外壳间: 0.5kV 一分钟 I/P-O/P: 1.5kV I/P-FG: 1.5kV O/P-FG: 0.5kV 1minute			
隔离电阻 Isolation resistance		输入输出间 输入与外壳间 输出与外壳间: 500VDC/100MΩ I/P-O/P I/P-FG O/P-FG: 500VDC/100MΩ			
工作温度 Working temperature		-10°C ~ +50°C			
尺寸 Dimension		215 × 115 × 50mm			
重量 Weight		1.1kg			
包装 Packing		45.5 × 31.5 × 26CM/20PCS/22kg			

外形尺寸 Overall dimension(mm)

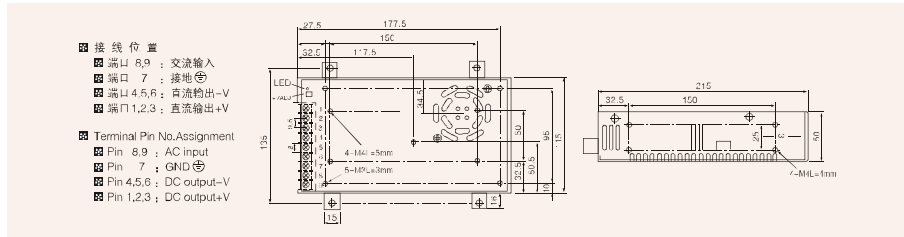

S-500W单组输出电源
S-500W Single output power supply

概述 Summary

- > 单组输出，功率500W
Single output: power 500W
- > 输入电压：90 ~ 132VAC/180 ~ 264VAC 由开关切换
Input voltage: 90 ~ 132VAC/180 ~ 264VAC by switch



238 × 124 × 65mm

常见规格 General Specification

性能 Specification	型号 Model	S-500-12	S-500-24	S-500-36	S-500-48
直流输出电压、电流 DC output voltage, current		12V 0 ~ 40A	24V 0 ~ 20A	36V 0 ~ 14A	48V 0 ~ 10A
纹波及噪音 Wave and noise		100mVp-p	150mVp-p	150mVp-p	150mVp-p
进线稳定度 Inlet wire stability		± 0.5%	± 0.5%	± 0.5%	± 0.5%
负载稳定度 Load stability		± 0.5%	± 0.5%	± 0.5%	± 0.5%
效率 Efficiency		83%	85%	86%	87%
直流电压可调范围 Adjustable range for DC voltage		± 10%	± 10%	± 10%	± 10%
输入电压范围 Input voltage range		90 ~ 132VAC/180 ~ 264VAC 由开关切换 254 ~ 370VDC 47 ~ 63Hz 90 ~ 132VAC/180 ~ 264VAC by switch 254 ~ 370VDC 47 ~ 63Hz			
冲击电流 Impact current	冷启动电流 Cold start current	25A/115VAC 50A/230VAC			
过载保护 Overload protection		105% ~ 300% 切断输出，自动恢复 105% ~ 300% cut off the output, automatic recovery			
过电压保护 Over voltage protection		115% ~ 140% 关闭输出，电源重启后可恢复输出 115% ~ 140% shut down O/P voltage, re-power on to recover			
启动、上升、保持时间 Setup, rise, hold up time		800ms, 20ms, 36ms/230VAC 满载 at full load			
耐压性 Withstand voltage		输入输出间: 1.5kV 输入与外壳间: 1.5kV 输出与外壳间: 0.5kV 一分钟 I/P-O/P: 1.5kV I/P-FG: 1.5kV O/P-FG: 0.5kV 1minute			
隔离电阻 Isolation resistance		输入输出间 输入与外壳间 输出与外壳间: 500VDC/100MΩ I/P-O/P I/P-FG O/P-FG: 500VDC/100MΩ			
工作温度 Working temperature		-10°C ~ +50°C			
尺寸 Dimension		238 × 124 × 65mm			
重量 Weight		1.35kg			
包装 Packing		44 × 26 × 27CM/12PCS/16.2kg			

外形尺寸 Overall dimension(mm)

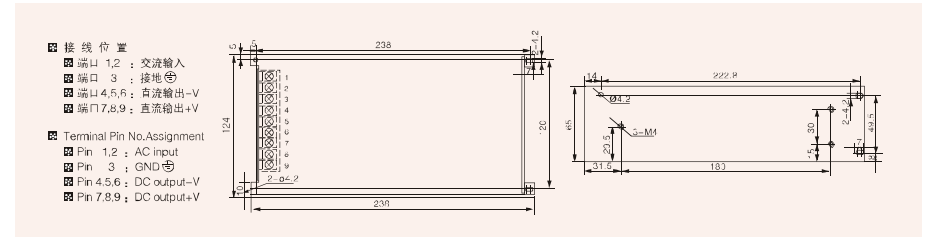

S-600W单组输出电源
S-600W Single output power supply

概述 Summary

- > 单组输出; 功率600W
Single output: power 600W
- > 输入电压: 90 ~ 132VAC/180 ~ 264VAC 由开关切换
Input voltage: 90 ~ 132VAC/180 ~ 264VAC by switch



常见规格 General Specification

238 × 124 × 65mm

性能 Specification	型号 Model	S-600-12	S-600-24	S-600-36	S-600-48
直流输出电压、电流 DC output voltage, current		12V 0~50A	24V 0~25A	36V 0~16.7A	48V 0~12.5A
纹波及噪音 Wave and noise		100mVp-p	150mVp-p	150mVp-p	150mVp-p
进线稳定度 Inlet wire stability		±0.5%	±0.5%	±0.5%	±0.5%
负载稳定度 Load stability		±0.5%	±0.5%	±0.5%	±0.5%
效率 Efficiency		83%	85%	86%	87%
直流电压可调范围 Adjustable range for DC voltage		±10%	±10%	±10%	±10%
输入电压范围 Input voltage range		90 ~ 132VAC/180 ~ 264VAC 由开关切换 254 ~ 370VDC 47 ~ 63Hz 90 ~ 132VAC/180 ~ 264VAC by switch 254 ~ 370VDC 47 ~ 63Hz			
冲击电流 Impact current	冷启动电流 Cold start current	25A/115VAC 50A/230VAC			
过载保护 Overload protection		105% ~ 300% 切断输出, 自动恢复 105% ~ 300% cut off the output, automatic recovery			
过电压保护 Over voltage protection		115% ~ 140% 关闭输出, 电源重启后可恢复输出 115% ~ 140% shut down O/P voltage, re-power on to recover			
启动、上升、保持时间 Setup, rise, hold up time		800ms, 20ms, 36ms/230VAC 满载 at full load			
耐压性 Withstand voltage		输入输出间: 1.5kV 输入与外壳间: 1.5kV 输出与外壳间: 0.5kV 一分钟 I/P-O/P: 1.5kV I/P-FG: 1.5kV O/P-FG: 0.5kV 1minute			
隔离电阻 Isolation resistance		输入输出间 输入与外壳间 输出与外壳间: 500VDC/100MΩ I/P-O/P I/P-FG O/P-FG: 500VDC/100MΩ			
工作温度 Working temperature		-10°C ~ +50°C			
尺寸 Dimension		238 × 124 × 65mm			
重量 Weight		1.5kg			
包装 Packing		44 × 26 × 27CM/12PCS/16kg			

外形尺寸 Overall dimension(mm)

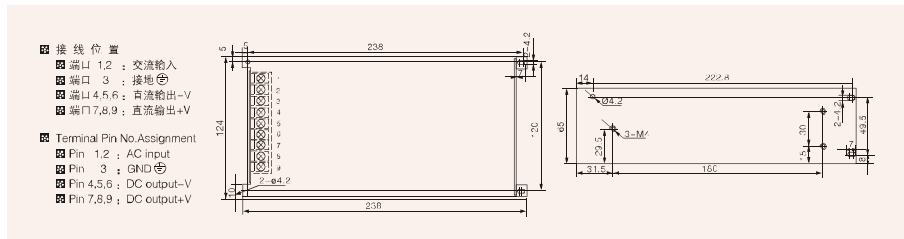

SE-600W单组输出电源
SE-600W Single output power supply

概述 Summary

- > 单组输出; 功率600W
Single output: power 600W
- > 输入电压: 90 ~ 132VAC/180 ~ 264VAC 由开关切换
Input voltage: 90 ~ 132VAC/180 ~ 264VAC by switch



常见规格 General Specification

247 × 127 × 63.5mm

性能 Specification	型号 Model	SE-600-5	SE-600-12	SE-600-24	SE-600-48
直流输出电压、电流 DC output voltage, current		5V 0~100A	12V 0~50A	24V 0~25A	48V 0~12.5A
纹波及噪音 Wave and noise		150mVp-p	150mVp-p	150mVp-p	180mVp-p
进线稳定度 Inlet wire stability		±0.5%	±0.5%	±0.5%	±0.5%
负载稳定度 Load stability		±1%	±0.5%	±0.5%	±0.5%
效率 Efficiency		78%	83%	87%	88%
直流电压可调范围 Adjustable range for DC voltage		±10%	±10%	±10%	±10%
输入电压范围 Input voltage range		90 ~ 132VAC/180 ~ 264VAC 由开关切换 254 ~ 370VDC 47 ~ 63Hz 90 ~ 132VAC/180 ~ 264VAC by switch 254 ~ 370VDC 47 ~ 63Hz			
冲击电流 Impact current	冷启动电流 Cold start current	30A/115VAC 50A/230VAC			
过载保护 Overload protection		105% ~ 150% 切断输出, 自动恢复 105% ~ 150% cut off the output, automatic recovery			
过电压保护 Over voltage protection		120% ~ 140% 关闭输出, 电源重启后可恢复输出 120% ~ 140% shut down O/P voltage, re-power on to recover			
启动、上升、保持时间 Setup, rise, hold up time		1000ms, 50ms, 16ms/230VAC 满载 at full load			
耐压性 Withstand voltage		输入输出间: 1.5kV 输入与外壳间: 1.5kV 输出与外壳间: 0.5kV 一分钟 I/P-O/P: 1.5kV I/P-FG: 1.5kV O/P-FG: 0.5kV 1minute			
隔离电阻 Isolation resistance		输入输出间 输入与外壳间 输出与外壳间: 500VDC/100MΩ I/P-O/P I/P-FG O/P-FG: 500VDC/100MΩ			
工作温度 Working temperature		-10°C ~ +50°C			
尺寸 Dimension		247 × 127 × 63.5mm			
重量 Weight		2.17kg			
包装 Packing		37.5 × 31 × 25.5CM/6PCS/13.5kg			

外形尺寸 Overall dimension(mm)

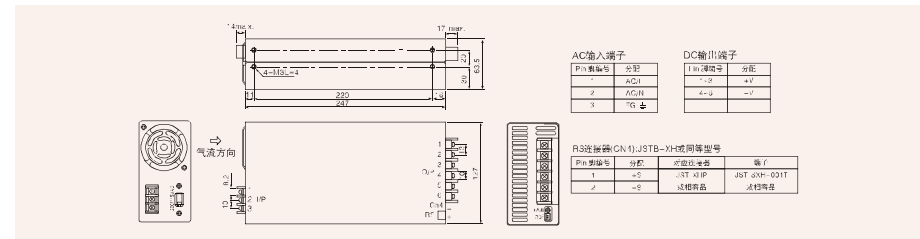

SCN-600W单组输出可并联电源
SCN-600W Single output in parallel power supply



概述 Summary

- > 单组输出：功率600W
Single output: power 600W
- > 输入电压：90 ~ 132VAC/180 ~ 264VAC 由开关切换
Input voltage: 90 ~ 132VAC/180 ~ 264VAC by switch

常见规格 General Specification

291 × 132 × 68mm

性能 Specification	型号 Model	SCN-600-12	SCN-600-24	SCN-600-36	SCN-600-48
直流输出电压、电流 DC output voltage, current		12V 0~50A	24V 0~25A	36V 0~16.7A	48V 0~12.5A
纹波及噪音 Wave and noise		150mVp-p	150mVp-p	150mVp-p	150mVp-p
进线稳定度 Inlet wire stability		± 0.5%	± 0.5%	± 0.5%	± 0.5%
负载稳定度 Load stability		± 0.5%	± 0.5%	± 0.5%	± 0.5%
效率 Efficiency		80%	85%	86%	87%
直流电压可调范围 Adjustable range for DC voltage		± 10%	± 10%	± 10%	± 10%
输入电压范围 Input voltage range		90 ~ 132VAC/180 ~ 264VAC 由开关切换 254 ~ 370VDC 47 ~ 63Hz 90 ~ 132VAC/180 ~ 264VAC by switch 254 ~ 370VDC 47 ~ 63Hz			
冲击电流 Impact current	冷启动电流 Cold start current	45A/230VAC			
过载保护 Overload protection	105% ~ 135% 切断输出, 自动恢复 105% ~ 135% cut off the output, automatic recovery				
过电压保护 Over voltage protection	115% ~ 140% 关闭输出, 电源重启后可恢复输出 115% ~ 140% shut down O/P voltage, re-power on to recover				
启动、上升、保持时间 Setup, rise, hold up time	2000ms, 50ms, 20ms/230VAC 满负载 at full load				
耐压性 Withstand voltage	输入输出间: 1.5kV 输入与外壳间: 1.5kV 输出与外壳间: 0.5kV 一分钟 I/P-O/P: 1.5kV I/P-FG: 1.5kV O/P-FG: 0.5kV 1minute				
隔离电阻 Isolation resistance	输入输出间 输入与外壳间 输出与外壳间: 500VDC/100MΩ I/P-O/P I/P-FG O/P-FG: 500VDC/100MΩ				
工作温度 Working temperature	-10°C ~ +50°C				
尺寸 Dimension	291 × 132 × 68mm				
重量 Weight	2.5kg				
包装 Packing	37.5 × 31 × 25.5CM/6PCS/15kg				

外形尺寸 Overall dimension(mm)

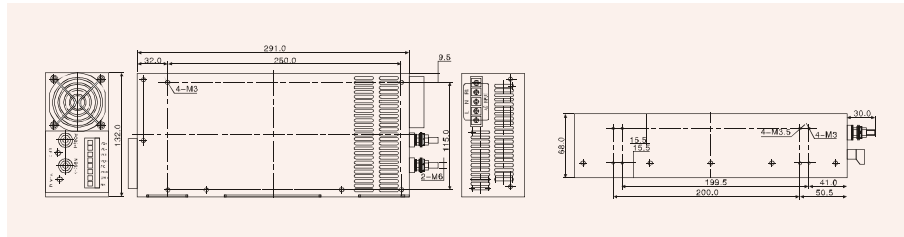

SCN-800W单组输出可并联电源
SCN-800W Single output in parallel power supply



概述 Summary

- > 单组输出：功率800W
Single output: power 800W
- > 输入电压：90 ~ 132VAC/180 ~ 264VAC 由开关切换
Input voltage: 90 ~ 132VAC/180 ~ 264VAC by switch

常见规格 General Specification

291 × 132 × 68mm

性能 Specification	型号 Model	SCN-800-12	SCN-800-24	SCN-800-36	SCN-800-48
直流输出电压、电流 DC output voltage, current		12V 0~66A	24V 0~33A	36V 0~22A	48V 0~17A
纹波及噪音 Wave and noise		150mVp-p	180mVp-p	180mVp-p	240mVp-p
进线稳定度 Inlet wire stability		± 0.5%	± 0.5%	± 0.5%	± 0.5%
负载稳定度 Load stability		± 0.5%	± 0.5%	± 0.5%	± 0.5%
效率 Efficiency		80%	85%	85%	87%
直流电压可调范围 Adjustable range for DC voltage		± 10%	± 10%	± 10%	± 10%
输入电压范围 Input voltage range		90 ~ 132VAC/180 ~ 264VAC 由开关切换 254 ~ 370VDC 47 ~ 63Hz 90 ~ 132VAC/180 ~ 264VAC by switch 254 ~ 370VDC 47 ~ 63Hz			
冲击电流 Impact current	冷启动电流 Cold start current	45A/230VAC			
过载保护 Overload protection	105% ~ 135% 切断输出, 自动恢复 105% ~ 135% cut off the output, automatic recovery				
过电压保护 Over voltage protection	115% ~ 140% 关闭输出, 电源重启后可恢复输出 115% ~ 140% shut down O/P voltage, re-power on to recover				
启动、上升、保持时间 Setup, rise, hold up time	2000ms, 50ms, 20ms/230VAC 满负载 at full load				
耐压性 Withstand voltage	输入输出间: 1.5kV 输入与外壳间: 1.5kV 输出与外壳间: 0.5kV 一分钟 I/P-O/P: 1.5kV I/P-FG: 1.5kV O/P-FG: 0.5kV 1minute				
隔离电阻 Isolation resistance	输入输出间 输入与外壳间 输出与外壳间: 500VDC/100MΩ I/P-O/P I/P-FG O/P-FG: 500VDC/100MΩ				
工作温度 Working temperature	-10°C ~ +50°C				
尺寸 Dimension	291 × 132 × 68mm				
重量 Weight	2.65kg				
包装 Packing	37.5 × 31 × 25.5CM/6PCS/16kg				

外形尺寸 Overall dimension(mm)

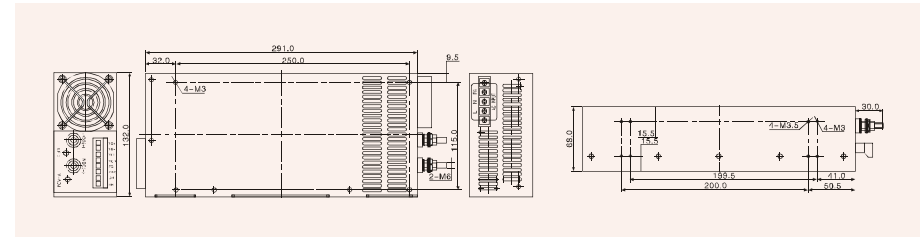

SCN-1000W单组输出可并联电源
SCN-1000W Single output in parallel power supply



概述 Summary

- > 单组输出，功率1000W
Single output: power 1000W
- > 输入电压：90 ~ 132VAC/180 ~ 264VAC 由开关切换
Input voltage: 90 ~ 132VAC/180 ~ 264VAC by switch

常见规格 General Specification

291 × 132 × 68mm

性能 Specification	型号 Model	SCN-1000-12	SCN-1000-24	SCN-1000-36	SCN-1000-48
直流输出电压、电流 DC output voltage, current		12V 0~80A	24V 0~42A	36V 0~28A	48V 0~21A
纹波及噪音 Wave and noise		150mVp-p	150mVp-p	150mVp-p	150mVp-p
进线稳定度 Inlet wire stability		± 0.5%	± 0.5%	± 0.5%	± 0.5%
负载稳定度 Load stability		± 0.5%	± 0.5%	± 0.5%	± 0.5%
效率 Efficiency		80%	85%	86%	87%
直流电压可调范围 Adjustable range for DC voltage		± 10%	± 10%	± 10%	± 10%
输入电压范围 Input voltage range		90 ~ 132VAC/180 ~ 264VAC 由开关切换 254 ~ 370VDC 47 ~ 63Hz 90 ~ 132VAC/180 ~ 264VAC by switch 254 ~ 370VDC 47 ~ 63Hz			
冲击电流 Impact current	冷启动电流 Cold start current	45A/230VAC			
过载保护 Overload protection	105% ~ 135% 切断输出，自动恢复 105% ~ 135% cut off the output, automatic recovery				
过电压保护 Over voltage protection	115% ~ 140% 关闭输出，电源重启后可恢复输出 115% ~ 140% shut down O/P voltage, re-power on to recover				
启动、上升、保持时间 Setup, rise, hold up time	2000ms, 50ms, 20ms/230VAC 满载 at full load				
耐压性 Withstand voltage	输入输出间: 1.5kV 输入与外壳间: 1.5kV 输出与外壳间: 0.5kV 一分钟 I/P-O/P: 1.5kV I/P-FG: 1.5kV O/P-FG: 0.5kV 1minute				
隔离电阻 Isolation resistance	输入输出间 输入与外壳间 输出与外壳间: 500VDC/100MΩ I/P-O/P I/P-FG O/P-FG: 500VDC/100MΩ				
工作温度 Working temperature	-10°C ~ +50°C				
尺寸 Dimension	291 × 132 × 68mm				
重量 Weight	2.65kg				
包装 Packing	37.5 × 31 × 25.5CM/6PCS/16kg				

外形尺寸 Overall dimension(mm)

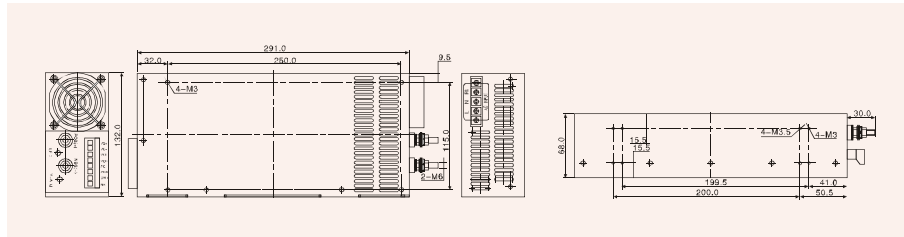

SCN-1500W单组输出可并联电源
SCN-1500W Single output in parallel power supply



概述 Summary

- > 单组输出，功率1500W
Single output: power 1500W
- > 输入电压：90 ~ 132VAC或180 ~ 264VAC
Input voltage: 90 ~ 132VAC or 180 ~ 264VAC

常见规格 General Specification

291 × 132 × 136mm

性能 Specification	型号 Model	SCN-1500-12	SCN-1500-24	SCN-1500-36	SCN-1500-48
直流输出电压、电流 DC output voltage, current		12V 0~125A	24V 0~62.5A	36V 0~41A	48V 0~32A
纹波及噪音 Wave and noise		120mVp-p	200mVp-p	200mVp-p	240mVp-p
进线稳定度 Inlet wire stability		± 0.5%	± 0.5%	± 0.5%	± 0.5%
负载稳定度 Load stability		± 0.5%	± 0.5%	± 0.5%	± 0.5%
效率 Efficiency		80%	85%	86%	87%
直流电压可调范围 Adjustable range for DC voltage		± 10%	± 10%	± 10%	± 10%
输入电压范围 Input voltage range		90 ~ 132VAC 或 180 ~ 264VAC 90 ~ 132VAC or 180 ~ 264VAC			
冲击电流 Impact current	冷启动电流 Cold start current	45A/230VAC			
过载保护 Overload protection	105% ~ 135% 切断输出，自动恢复 105% ~ 135% cut off the output, automatic recovery				
过电压保护 Over voltage protection	115% ~ 140% 关闭输出，电源重启后可恢复输出 115% ~ 140% shut down O/P voltage, re-power on to recover				
启动、上升、保持时间 Setup, rise, hold up time	2000ms, 50ms, 20ms/230VAC 满载 at full load				
耐压性 Withstand voltage	输入输出间: 1.5kV 输入与外壳间: 1.5kV 输出与外壳间: 0.5kV 一分钟 I/P-O/P: 1.5kV I/P-FG: 1.5kV O/P-FG: 0.5kV 1minute				
隔离电阻 Isolation resistance	输入输出间 输入与外壳间 输出与外壳间: 500VDC/100MΩ I/P-O/P I/P-FG O/P-FG: 500VDC/100MΩ				
工作温度 Working temperature	-10°C ~ +50°C				
尺寸 Dimension	291 × 132 × 136mm				
重量 Weight	5.3kg				
包装 Packing	38 × 37.5 × 21CM/2PCS/11kg				

外形尺寸 Overall dimension(mm)

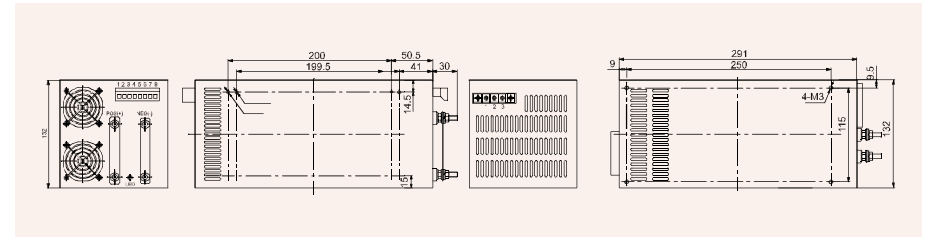

D-30W双组输出电源
D-30W Dual output power supply

概述 Summary

- > 双组输出; 功率30W
Dual output: power 30W
- > 输入电压: 90 ~ 132VAC/180 ~ 264VAC 由开关切换
Input voltage: 90 ~ 132VAC/180 ~ 264VAC by switch



129 x 98 x 38mm

常见规格 General Specification

性能 Specification	型号 Model	D-30A		D-30B		D-30C		D-30F	
		CH1主回路	CH2次回路	CH1主回路	CH2次回路	CH1主回路	CH2次回路	CH1主回路	CH2次回路
直流输出电压、电流 DC output voltage, current		5V 0~4A	12V 0~1A	5V 0~2A	24V 0~1A	12V 0.5~1.5A	-12V 0.2~10A	12V 0.3~1A	24V 0.3~1A
纹波及噪音 Wave and noise		50mVp-p	100mVp-p	50mVp-p	100mVp-p	100mVp-p	100mVp-p	100mVp-p	120mVp-p
进线稳定度 Inlet wire stability		±0.5%	±1%	±0.5%	±1%	±0.5%	±1%	±0.5%	±1%
负载稳定度 Load stability		±0.5%	±4%	±0.5%	±4%	±0.5%	±1%	±0.5%	±4%
效率 Efficiency		72%		74%		74%		75%	
直流电压可调范围 Adjustable range for DC voltage		CH1: ±10%	CH2: ±5%	CH1: ±10%	CH2: ±5%	CH1: ±10%	CH2: ±5%	CH1: ±10%	CH2: ±5%
输入电压范围 Input voltage range		90 ~ 132VAC/180 ~ 264VAC 由开关切换 254 ~ 370VDC 47 ~ 63Hz 90 ~ 132VAC/180 ~ 264VAC by switch 254 ~ 370VDC 47 ~ 63Hz							
冲击电流 Impact current		冷启动电流 Cold start current 18A/115VAC 36A/230VAC							
过载保护 Overload protection		105% ~ 150% 切断输出, 自动恢复 105% ~ 150% cut off the output, automatic recovery							
过电压保护 Over voltage protection									
启动、上升、保持时间 Setup, rise, hold up time		200ms, 50ms, 30ms/230VAC 满负载 at full load							
耐压性 Withstand voltage		输入输出间: 1.5kV 输入与外壳间: 1.5kV 输出与外壳间: 0.5kV 一分钟 I/P-O/P: 1.5kV I/P-FG: 1.5kV O/P-FG: 0.5kV 1minute							
隔离电阻 Isolation resistance		输入输出间 输入与外壳间 输出与外壳间: 500VDC/100MΩ I/P-O/P I/P-FG O/P-FG: 500VDC/100MΩ							
工作温度 Working temperature		-10°C ~ +50°C							
尺寸 Dimension		129 x 98 x 38mm							
重量 Weight		0.4kg							
包装 Packing		43 x 32.5 x 24CM/45PCS/18kg							

外形尺寸 Overall dimension(mm)

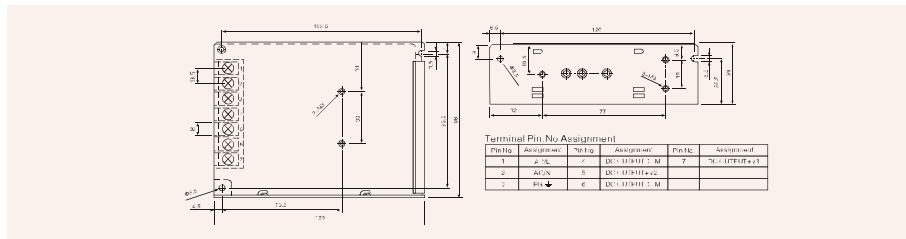

D-50W双组输出电源
D-50W Dual output power supply

概述 Summary

- > 双组输出; 功率50W
Dual output: power 50W
- > 输入电压: 90 ~ 132VAC/180 ~ 264VAC 由开关切换
Input voltage: 90 ~ 132VAC/180 ~ 264VAC by switch



159 x 98 x 38mm

常见规格 General Specification

性能 Specification	型号 Model	D-50A		D-50B		D-50C		D-50F	
		CH1主回路	CH2次回路	CH1主回路	CH2次回路	CH1主回路	CH2次回路	CH1主回路	CH2次回路
直流输出电压、电流 DC output voltage, current		5V 0~6A	12V 0~2A	5V 0~6A	24V 0~1A	12V 1~2A	-12V 0.3~2A	12V 1~2A	24V 0.2~1A
纹波及噪音 Wave and noise		50mVp-p	80mVp-p	50mVp-p	100mVp-p	100mVp-p	100mVp-p	100mVp-p	120mVp-p
进线稳定度 Inlet wire stability		±0.5%	±1%	±0.5%	±1%	±1%	±1%	±1%	±1%
负载稳定度 Load stability		±0.5%	±4%	±0.5%	±1%	±0.5%	±5%	±0.5%	±8%
效率 Efficiency		73%		73%		73%		73%	
直流电压可调范围 Adjustable range for DC voltage		CH1: ±10%	CH2: ±5%	CH1: ±10%	CH2: ±5%	CH1: ±10%	CH2: ±10%	CH1: ±10%	CH2: ±10%
输入电压范围 Input voltage range		90 ~ 132VAC/180 ~ 264VAC 由开关切换 254 ~ 370VDC 47 ~ 63Hz 90 ~ 132VAC/180 ~ 264VAC by switch 254 ~ 370VDC 47 ~ 63Hz							
冲击电流 Impact current		冷启动电流 Cold start current 18A/115VAC 36A/230VAC							
过载保护 Overload protection		105% ~ 150% 切断输出, 自动恢复 105% ~ 150% cut off the output, automatic recovery							
过电压保护 Over voltage protection		CH1: 115 ~ 135% 关闭输出, 电源重启后可恢复输出 CH1: 115 ~ 135% shut down O/P voltage, re-power on to recover							
启动、上升、保持时间 Setup, rise, hold up time		200ms, 100ms, 30ms/230VAC 满负载 at full load							
耐压性 Withstand voltage		输入输出间: 1.5kV 输入与外壳间: 1.5kV 输出与外壳间: 0.5kV 一分钟 I/P-O/P: 1.5kV I/P-FG: 1.5kV O/P-FG: 0.5kV 1minute							
隔离电阻 Isolation resistance		输入输出间 输入与外壳间 输出与外壳间: 500VDC/100MΩ I/P-O/P I/P-FG O/P-FG: 500VDC/100MΩ							
工作温度 Working temperature		-10°C ~ +50°C							
尺寸 Dimension		159 x 98 x 38mm							
重量 Weight		0.55kg							
包装 Packing		34 x 32 x 24CM/30PCS/16.5kg							

外形尺寸 Overall dimension(mm)

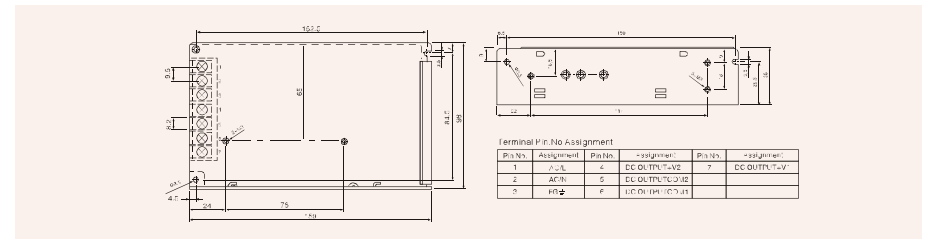

D-60W双组输出电源
D-60W Dual output power supply



概述 Summary

- > 双组输出; 功率60W
Dual output; power 60W
- > 输入电压: 85 ~ 264VAC 120 ~ 370VDC
Input voltage: 85 ~ 264VAC 120 ~ 370VDC

常见规格 General Specification

159 × 98 × 38mm

性能 Specification	型号 Model	D-60A		D-60B		D-60C		D-60F	
		CH1主回路	CH2次回路	CH1主回路	CH2次回路	CH1主回路	CH2次回路	CH1主回路	CH2次回路
直流输出电压、电流 DC output voltage, current		5V 0~4A	12V 0~3A	5V 0~3A	24V 0~1.8A	12V 1~2.5A	-12V 0.3~2.5A	12V 1~2A	24V 0.2~1.5A
纹波及噪音 Wave and noise		70mVp-p	150mVp-p	75mVp-p	150mVp-p	100mVp-p	100mVp-p	100mVp-p	120mVp-p
进线稳定度 Inlet wire stability		±0.5%	±1%	±0.5%	±0.5%	±1%	±1%	±1%	±1%
负载稳定度 Load stability		±0.5%	±4%	±0.5%	±4%	±5%	±5%	±0.5%	±8%
效率 Efficiency		73%		76%		73%		73%	
直流电压可调范围 Adjustable range for DC voltage		CH1: ±10%	CH2: ±5%	CH1: ±10%	CH2: ±5%	CH1: ±10%	CH2: ±5%	CH1: ±10%	CH2: ±5%
输入电压范围 Input voltage range		85 ~ 264VAC 120 ~ 370VDC 47 ~ 63Hz							
冲击电流 Impact current		冷启动电流 30A/115VAC 60A/230VAC							
过载保护 Overload protection		105% ~ 150% 切断输出, 自动恢复 105% ~ 150% cut off the output, automatic recovery							
过电压保护 Over voltage protection		CH1: 115 ~ 135% 关闭输出, 电源重启后可恢复输出 CH1: 115 ~ 135% shut down O/P voltage, re-power on to recover							
启动、上升、保持时间 Setup, rise, hold up time		300ms, 50ms, 80ms/230VAC 满载 at full load							
耐压性 Withstand voltage		输入输出间: 1.5kV 输入与外壳间: 1.5kV 输出与外壳间: 0.5kV 一分钟 I/P-O/P: 1.5kV I/P-FG: 1.5kV O/P-FG: 0.5kV 1minute							
隔离电阻 Isolation resistance		输入输出间 输入与外壳间 输出与外壳间: 500VDC/100MΩ I/P-O/P I/P-FG O/P-FG: 500VDC/100MΩ							
工作温度 Working temperature		-10°C ~ +50°C							
尺寸 Dimension		159 × 98 × 38mm							
重量 Weight		0.55kg							
包装 Packing		34 × 32 × 24CM/30PCS/16.5kg							

外形尺寸 Overall dimension(mm)

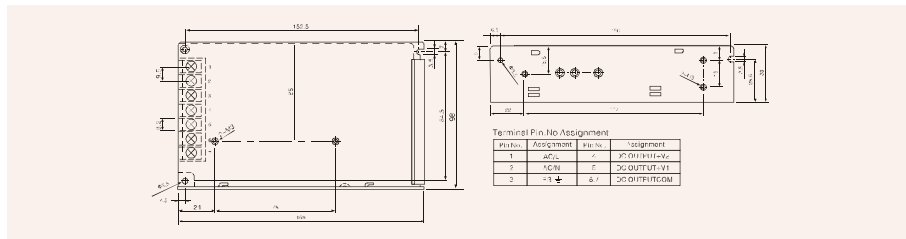

D-120W双组输出电源
D-120W Dual output power supply



概述 Summary

- > 双组输出; 功率120W
Dual output; power 120W
- > 输入电压: 90 ~ 132VAC/180 ~ 264VAC 由开关切换
Input voltage: 90 ~ 132VAC/180 ~ 264VAC by switch

常见规格 General Specification

199 × 110 × 50mm

性能 Specification	型号 Model	D-120A		D-120B		D-120C		D-120F	
		CH1主回路	CH2次回路	CH1主回路	CH2次回路	CH1主回路	CH2次回路	CH1主回路	CH2次回路
直流输出电压、电流 DC output voltage, current		5V 0~12A	12V 0~5A	5V 0~6A	24V 0~4A	12V 1~5A	-12V 0.5~5A	12V 1~5A	24V 0.4~2.5A
纹波及噪音 Wave and noise		60mVp-p	120mVp-p	60mVp-p	120mVp-p	120mVp-p	120mVp-p	120mVp-p	120mVp-p
进线稳定度 Inlet wire stability		±0.5%	±1%	±0.5%	±1%	±1%	±1%	±1%	±1%
负载稳定度 Load stability		±0.5%	±5%	±0.5%	±6%	±0.5%	±5%	±0.5%	±8%
效率 Efficiency		78%		76%		80%		80%	
直流电压可调范围 Adjustable range for DC voltage		CH1: ±10%	CH2: ±5%	CH1: ±10%	CH2: ±5%	CH1: ±10%	CH2: ±5%	CH1: ±10%	CH2: ±5%
输入电压范围 Input voltage range		90 ~ 132VAC/180 ~ 264VAC 由开关切换 254 ~ 370VDC 47 ~ 63Hz 90 ~ 132VAC/180 ~ 264VAC by switch 254 ~ 370VDC 47 ~ 63Hz							
冲击电流 Impact current		冷启动电流 30A/115VAC 60A/230VAC							
过载保护 Overload protection		105% ~ 135% 切断输出, 自动恢复 105% ~ 135% cut off the output, automatic recovery							
过电压保护 Over voltage protection		CH1: 115 ~ 135% 关闭输出, 电源重启后可恢复输出 CH1: 115 ~ 135% shut down O/P voltage, re-power on to recover							
启动、上升、保持时间 Setup, rise, hold up time		200ms, 50ms, 20ms/230VAC 满载 at full load							
耐压性 Withstand voltage		输入输出间: 1.5kV 输入与外壳间: 1.5kV 输出与外壳间: 0.5kV 一分钟 I/P-O/P: 1.5kV I/P-FG: 1.5kV O/P-FG: 0.5kV 1minute							
隔离电阻 Isolation resistance		输入输出间 输入与外壳间 输出与外壳间: 500VDC/100MΩ I/P-O/P I/P-FG O/P-FG: 500VDC/100MΩ							
工作温度 Working temperature		-10°C ~ +50°C							
尺寸 Dimension		199 × 110 × 50mm							
重量 Weight		0.9kg							
包装 Packing		42 × 31.5 × 26CM/20PCS/18kg							

外形尺寸 Overall dimension(mm)

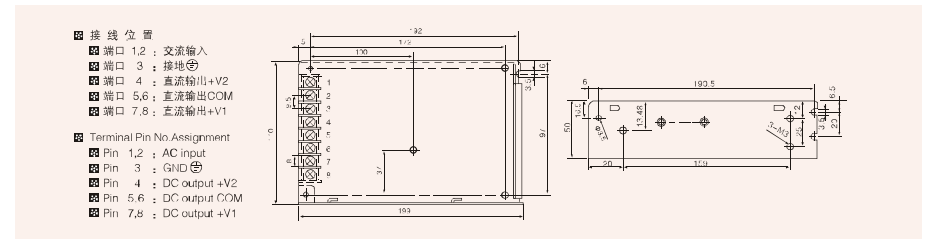

T-30W三组输出电源
T-30W Triple output power supply

概述 Summary

- > 三组输出，功率30W
Triple output: power 30W
- > 输入电压：90 ~ 132VAC/180 ~ 264VAC 由开关切换
Input voltage: 90 ~ 132VAC/180 ~ 264VAC by switch



常见规格 General Specification

129 × 98 × 38mm

性能 Specification	型号 Model	T-30A			T-30B			T-30C			T-30D		
		CH1主回路	CH2次回路	CH3次回路	CH1主回路	CH2次回路	CH3次回路	CH1主回路	CH2次回路	CH3次回路	CH1主回路	CH2次回路	CH3次回路
直流输出电压、电流 DC output voltage, current		5V 0~3A	12V 0~1A	-5V 0~0.5A	5V 0~3A	12V 0~1A	-12V 0~0.5A	5V 0.5~3A	-5 0.1~0.5A	-15 0.1~1.5A	5V 0.5~3A	12V 0.1~0.5A	24V 0.1~0.5A
纹波及噪音 Wave and noise		50mVp-p	100mVp-p	50mVp-p	50mVp-p	100mVp-p	100mVp-p	50mVp-p	100mVp-p	100mVp-p	50mVp-p	100mVp-p	15mVp-p
进线稳定度 Inlet wire stability		±0.5%	±1%	±1%	±0.5%	±1%	±1%	±0.5%	±1%	±1%	±0.5%	±1%	±1%
负载稳定度 Load stability		±0.5%	±5%	±5%	±0.5%	±5%	±5%	±1%	±4%	±4%	±1%	±4%	±4%
效率 Efficiency		70%			72%			72%			72%		
直流电压可调节范围 Adjustable range for DC voltage		CH1:±10%	CH2:±5%	CH3:±5%	CH1:±10%	CH2:±5%	CH3:±5%	CH1:±10%	CH2:±5%	CH3:±5%	CH1:±10%	CH2:±5%	CH3:±5%
输入电压范围 Input voltage range		90 ~ 132VAC/180 ~ 264VAC 由开关切换 254 ~ 370VDC 47 ~ 63Hz 90 ~ 132VAC/180 ~ 264VAC by switch 254 ~ 370VDC 47 ~ 63Hz											
冲击电流 Impact current		冷启动电流 18A/115VAC 36A/230VAC Cold start current											
过载保护 Overload protection		105% ~ 150% 切断输出，自动恢复 105% ~ 150% cut off the output, automatic recovery											
过电压保护 Over voltage protection		CH1:115 ~ 135% 关闭输出，电源重启后可恢复输出 CH1:115 ~ 135% shut down O/P voltage, re-power on to recover											
启动、上升、保持时间 Setup, rise, hold up time		200ms, 100ms, 30ms/230VAC 满负载 at full load											
耐压性 Withstand voltage		输入输出间：1.5kV 输入与外壳间：1.5kV 输出与外壳间：0.5kV 一分钟 I/P-O/P: 1.5kV I/P-FG: 1.5kV O/P-FG: 0.5kV 1minute											
隔离电阻 Isolation resistance		输入输出间 输入与外壳间 输出与外壳间：500VDC/100MΩ I/P-O/P I/P-FG O/P-FG: 500VDC/100MΩ											
工作温度 Working temperature		-10°C ~ +50°C											
尺寸 Dimension		129 × 98 × 38mm											
重量 Weight		0.4kg											
包装 Packing		43 × 32.5 × 24CM/45PCS/18kg											

外形尺寸 Overall dimension(mm)

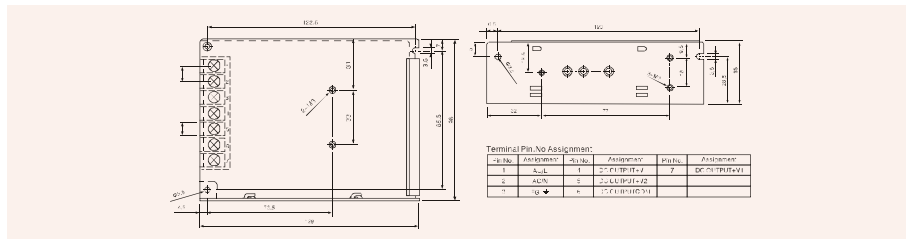

T-50W三组输出电源
T-50W Triple output power supply

概述 Summary

- > 三组输出，功率50W
Triple output: power 50W
- > 输入电压：90 ~ 132VAC/180 ~ 264VAC 由开关切换
Input voltage: 90 ~ 132VAC/180 ~ 264VAC by switch



常见规格 General Specification

159 × 98 × 38mm

性能 Specification	型号 Model	T-50A			T-50B			T-50C			T-50D		
		CH1主回路	CH2次回路	CH3次回路	CH1主回路	CH2次回路	CH3次回路	CH1主回路	CH2次回路	CH3次回路	CH1主回路	CH2次回路	CH3次回路
直流输出电压、电流 DC output voltage, current		5V 0~7A	12V 0~1A	-5V 0~1A	5V 0~5A	12V 0~1A	-12V 0~1A	5V 0~4A	15V 0~1A	-15V 0~1A	5V 0~3A	12V 0~1A	24V 0~1A
纹波及噪音 Wave and noise		100mVp-p	100mVp-p	100mVp-p	100mVp-p	100mVp-p	100mVp-p	100mVp-p	120mVp-p	120mVp-p	50mVp-p	120mVp-p	120mVp-p
进线稳定度 Inlet wire stability		±0.5%	±0.5%	±0.5%	±0.5%	±0.5%	±0.5%	±0.5%	±0.5%	±0.5%	±0.5%	±1%	±1%
负载稳定度 Load stability		±0.5%	±4%	±4%	±1%	±4%	±4%	±1%	±4%	±4%	±1%	±4%	±4%
效率 Efficiency		66%			69%			71%			72%		
直流电压可调节范围 Adjustable range for DC voltage		CH1:±10%	CH2:±5%	CH3:±5%	CH1:±10%	CH2:±5%	CH3:±5%	CH1:±10%	CH2:±5%	CH3:±5%	CH1:±10%	CH2:±5%	CH3:±5%
输入电压范围 Input voltage range		90 ~ 132VAC/180 ~ 264VAC 由开关切换 254 ~ 370VDC 47 ~ 63Hz 90 ~ 132VAC/180 ~ 264VAC by switch 254 ~ 370VDC 47 ~ 63Hz											
冲击电流 Impact current		冷启动电流 20A/115VAC 40A/230VAC Cold start current											
过载保护 Overload protection		105% ~ 150% 切断输出，自动恢复 105% ~ 150% cut off the output, automatic recovery											
过电压保护 Over voltage protection		CH1:115 ~ 135% 关闭输出，电源重启后可恢复输出 CH1:115 ~ 135% shut down O/P voltage, re-power on to recover											
启动、上升、保持时间 Setup, rise, hold up time		200ms, 50ms, 16ms/230VAC 满负载 at full load											
耐压性 Withstand voltage		输入输出间：1.5kV 输入与外壳间：1.5kV 输出与外壳间：0.5kV 一分钟 I/P-O/P: 1.5kV I/P-FG: 1.5kV O/P-FG: 0.5kV 1minute											
隔离电阻 Isolation resistance		输入输出间 输入与外壳间 输出与外壳间：500VDC/100MΩ I/P-O/P I/P-FG O/P-FG: 500VDC/100MΩ											
工作温度 Working temperature		-10°C ~ +50°C											
尺寸 Dimension		159 × 98 × 38mm											
重量 Weight		0.55kg											
包装 Packing		34 × 32 × 24CM/30PCS/16.5kg											

外形尺寸 Overall dimension(mm)

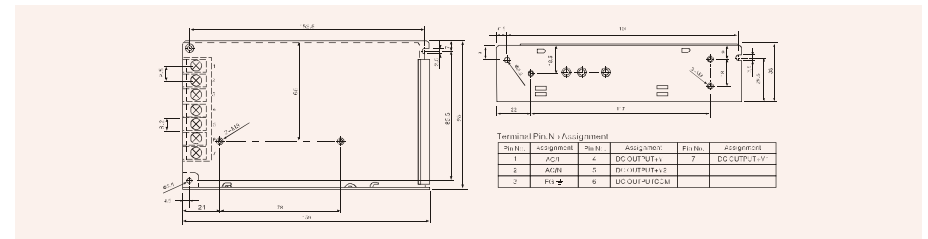

T-60W三组输出电源
T-60W Triple output power supply

概述 Summary

- > 三组输出; 功率60W
Triple output: power 60W
- > 输入电压: 85 ~ 264VAC 120 ~ 370VDC
Input voltage: 85 ~ 264VAC 120 ~ 370VDC



常见规格 General Specification

159 × 98 × 38mm

性能 Specification	T-60A			T-60B			T-60C			T-60D		
	CH1主回路	CH2次回路	CH3次回路	CH1主回路	CH2次回路	CH3次回路	CH1主回路	CH2次回路	CH3次回路	CH1主回路	CH2次回路	CH3次回路
直流输出电压、电流 DC output voltage, current	5V 0~5A	12V 0~2.5A	-5V 0~0.5A	5V 0~5A	12V 0~2.5A	-12V 0~0.5A	5V 0~5A	15V 0~2A	-15V 0~0.5A	5V 0.5~5A	12V 0.2~2.5A	24 0.2~0.5A
纹波及噪音 Wave and noise	50mVp-p	100mVp-p	100mVp-p	100mVp-p	120mVp-p	120mVp-p	100mVp-p	120mVp-p	120mVp-p	80mVp-p	100mVp-p	100mVp-p
进线稳定度 Inlet wire stability	±0.5%	±1%	±0.5%	±0.5%	±1%	±0.5%	±0.5%	±1%	±0.5%	±1%	±1%	±1%
负载稳定度 Load stability	±1%	±4%	±1%	±1%	±4%	±4%	±4%	±4%	±1%	±1%	±4%	±1%
效率 Efficiency	72%			72%			72%			72%		
直流电压可调节范围 Adjustable range for DC voltage	CH1: ±10%	CH2: ±5%	CH3: ±5%	CH1: ±10%	CH2: ±5%	CH3: ±5%	CH1: ±10%	CH2: ±5%	CH3: ±5%	CH1: ±10%	CH2: ±5%	CH3: ±5%
输入电压范围 Input voltage range	85 ~ 264VAC 120 ~ 370VDC 47 ~ 63Hz											
冲击电流 Impact current	冷启动电流 30A/115VAC 60A/230VAC											
过载保护 Overload protection	105% ~ 150% 切断输出, 自动恢复 105% ~ 150% cut off the output, automatic recovery											
过电压保护 Over voltage protection	CH1: 115 ~ 135% 关闭输出, 电源重启后可恢复输出 CH1: 115 ~ 135% shut down O/P voltage, re-power on to recover											
启动、上升、保持时间 Setup, rise, hold up time	300ms, 50ms, 80ms/230VAC 满载 at full load											
耐压性 Withstand voltage	输入输出间: 1.5kV 输入与外壳间: 1.5kV 输出与外壳间: 0.5kV 一分钟 I/P-O/P: 1.5kV I/P-FG: 1.5kV O/P-FG: 0.5kV 1minute											
隔离电阻 Isolation resistance	输入输出间 输入与外壳间 输出与外壳间: 500VDC/100MΩ I/P-O/P I/P-FG O/P-FG: 500VDC/100MΩ											
工作温度 Working temperature	-10°C ~ +50°C											
尺寸 Dimension	159 × 98 × 38mm											
重量 Weight	0.55kg											
包装 Packing	34 × 32 × 24CM/30PCS/16.5kg											

外形尺寸 Overall dimension(mm)

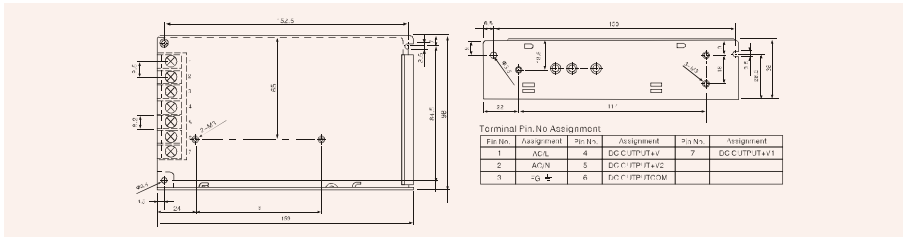

T-120W三组输出电源
T-120W Triple output power supply

概述 Summary

- > 三组输出; 功率120W
Triple output: power 120W
- > 输入电压: 90 ~ 132VAC/180 ~ 264VAC 由开关切换
Input voltage: 90 ~ 132VAC/180 ~ 264VAC by switch



常见规格 General Specification

199 × 110 × 50mm

性能 Specification	T-120A			T-120B			T-120C			T-120D		
	CH1主回路	CH2次回路	CH3次回路	CH1主回路	CH2次回路	CH3次回路	CH1主回路	CH2次回路	CH3次回路	CH1主回路	CH2次回路	CH3次回路
直流输出电压、电流 DC output voltage, current	5V 2~11A	12V 0.5~5A	-5V 0.2~1A	5V 2~11A	12V 0.5~5A	-12V 0.2~1A	5V 2~10A	15V 0.5~3.5A	-15V 0.1~1A	5V 2~12A	24V 0.2~0.5A	24V 0.2~0.5A
纹波及噪音 Wave and noise	80mVp-p	150mVp-p	150mVp-p	80mVp-p	150mVp-p	150mVp-p	80mVp-p	150mVp-p	150mVp-p	80mVp-p	120mVp-p	180mVp-p
进线稳定度 Inlet wire stability	±0.5%	±1%	±1%	±0.5%	±1%	±1%	±0.5%	±1%	±1%	±0.5%	±1%	±1%
负载稳定度 Load stability	±1%	±5%	±5%	±1%	±5%	±5%	±1%	±6%	±6%	±0.5%	±5%	±5%
效率 Efficiency	77%			77%			76%			80%		
直流电压可调节范围 Adjustable range for DC voltage	CH1: ±10%	CH2: ±5%	CH3: ±5%	CH1: ±10%	CH2: ±5%	CH3: ±5%	CH1: ±10%	CH2: ±5%	CH3: ±5%	CH1: ±10%	CH2: ±5%	CH3: ±5%
输入电压范围 Input voltage range	90 ~ 132VAC/180 ~ 264VAC 由开关切换 254 ~ 370VDC 47 ~ 63Hz 90 ~ 132VAC/180 ~ 264VAC by switch 254 ~ 370VDC 47 ~ 63Hz											
冲击电流 Impact current	冷启动电流 30A/115VAC 60A/230VAC											
过载保护 Overload protection	105% ~ 150% 切断输出, 自动恢复 105% ~ 150% cut off the output, automatic recovery											
过电压保护 Over voltage protection	CH1: 115 ~ 135% 关闭输出, 电源重启后可恢复输出 CH1: 115 ~ 135% shut down O/P voltage, re-power on to recover											
启动、上升、保持时间 Setup, rise, hold up time	200ms, 50ms, 16ms/230VAC 满载 at full load											
耐压性 Withstand voltage	输入输出间: 1.5kV 输入与外壳间: 1.5kV 输出与外壳间: 0.5kV 一分钟 I/P-O/P: 1.5kV I/P-FG: 1.5kV O/P-FG: 0.5kV 1minute											
隔离电阻 Isolation resistance	输入输出间 输入与外壳间 输出与外壳间: 500VDC/100MΩ I/P-O/P I/P-FG O/P-FG: 500VDC/100MΩ											
工作温度 Working temperature	-10°C ~ +50°C											
尺寸 Dimension	199 × 110 × 50mm											
重量 Weight	0.9kg											
包装 Packing	42 × 31.5 × 26CM/20PCS/18kg											

外形尺寸 Overall dimension(mm)

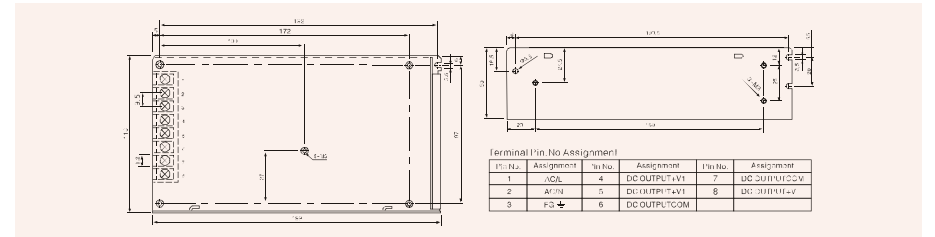

Q-60W四组输出电源
Q-60W Quad output power supply

概述 Summary

- > 四组输出，功率60W
Quad output: power 60W
- > 输入电压：85 ~ 264VAC 120 ~ 370VDC
Input voltage: 85 ~ 264VAC 120 ~ 370VDC



常见规格 General Specification

159 × 98 × 38mm

性能 Specification	型号 Model	Q-60B				Q-60C				Q-60D			
		CH1主回路	CH2次回路	CH3次回路	CH4次回路	CH1主回路	CH2次回路	CH3次回路	CH4次回路	CH1主回路	CH2次回路	CH3次回路	CH4次回路
直流输出电压、电流 DC output voltage, current		5V 0~5.5A	12V 0~2A	-5V (-1.5A)	-12V (-0.5A)	5V 0~5.5A	-5V (-1.5A)	-5V (-0.5A)	-5V (-0.5A)	5V 0~4A	12V 0~1A	24V 0~1A	-2V (-0.5A)
纹波及噪音 Wave and noise		100mVp-p	120mVp-p	100mVp-p	120mVp-p	100mVp-p	120mVp-p	100mVp-p	120mVp-p	100mVp-p	120mVp-p	150mVp-p	120mVp-p
进线稳定度 Inlet wire stability		±0.5%	±1%	±0.5%	±0.5%	±0.5%	±2%	±0.5%	±0.5%	±0.5%	±1%	±2%	±0.5%
负载稳定度 Load stability		±0.5%	±4%	±1%	±1%	±0.5%	±4%	±1%	±1%	±0.5%	±4%	±4%	±1%
效率 Efficiency		70%				72%				75%			
直流电压可调节范围 Adjustable range for DC voltage		CH1:4.75 ~ 5.5V				CH1:4.75 ~ 5.5V				CH1:4.75 ~ 5.5V			
输入电压范围 Input voltage range		85 ~ 264VAC 120 ~ 370VDC 47 ~ 63Hz											
冲击电流 Impact current		冷启动电流 15A/115VAC 30A/230VAC											
过载保护 Overload protection		105% ~ 150% 切断输出，自动恢复 105% ~ 150% cut off the output, automatic recovery											
过电压保护 Over voltage protection		CH1:115 ~ 135% 关闭输出，电源重启后可恢复输出 CH1:115 ~ 135% shut down O/P voltage, re-power on to recover											
启动、上升、保持时间 Setup, rise, hold up time		800s, 20ms, 60ms/230VAC 满载 at full load											
耐压性 Withstand voltage		输入输出间：1.5kV 输入与外壳间：1.5kV 输出与外壳间：0.5kV 一分钟 I/P-O/P: 1.5kV I/P-FG: 1.5kV O/P-FG: 0.5kV 1minute											
隔离电阻 Isolation resistance		输入输出间 输入与外壳间 输出与外壳间：500VDC/100MΩ I/P-O/P I/P-FG O/P-FG: 500VDC/100MΩ											
工作温度 Working temperature		-10°C ~ +60°C											
尺寸 Dimension		159 × 98 × 38mm											
重量 Weight		0.55kg											
包装 Packing		34 × 32 × 24CM/30PCS/16.5kg											

外形尺寸 Overall dimension(mm)

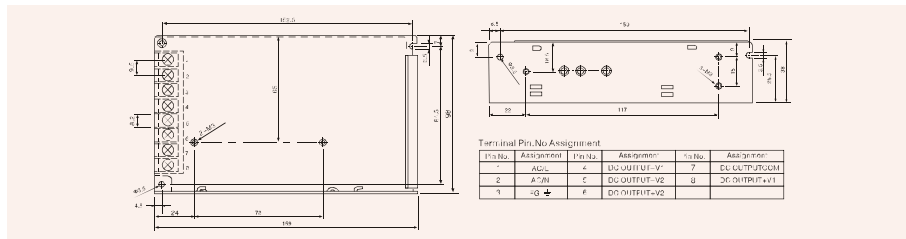

Q-120W四组输出电源
Q-120W Quad output power supply

概述 Summary

- > 四组输出，功率120W
Quad output: power 120W
- > 输入电压：90 ~ 132VAC/180 ~ 264VAC 由开关切换
Input voltage: 90 ~ 132VAC/180 ~ 264VAC by switch



常见规格 General Specification

199 × 110 × 50mm

性能 Specification	型号 Model	Q-120B				Q-120C				Q-120D			
		CH1主回路	CH2次回路	CH3次回路	CH4次回路	CH1主回路	CH2次回路	CH3次回路	CH4次回路	CH1主回路	CH2次回路	CH3次回路	CH4次回路
直流输出电压、电流 DC output voltage, current		5V 0~11A	12V 0~4A	-5V (-1A)	-12V (-1A)	5V 0~10A	15V 0~3.5A	-5V (-1A)	-15V (-1A)	5V 0~8A	12V 0~2A	24V 0~2A	-12V (-1A)
纹波及噪音 Wave and noise		80mVp-p	120mVp-p	80mVp-p	120mVp-p	80mVp-p	150mVp-p	80mVp-p	150mVp-p	80mVp-p	120mVp-p	180mVp-p	120mVp-p
进线稳定度 Inlet wire stability		±0.5%	±1%	±1%	±1%	±0.5%	±1%	±1%	±1%	±0.5%	±1%	±1%	±1%
负载稳定度 Load stability		±0.5%	±5%	±5%	±5%	±0.5%	±6%	±5%	±6%	±0.5%	±5%	±5%	±5%
效率 Efficiency		77%				76%				80%			
直流电压可调节范围 Adjustable range for DC voltage		CH1:±10%	CH2:±5%	CH3:±5%	CH4:±5%	CH1:±10%	CH2:±5%	CH3:±5%	CH4:±5%	CH1:±10%	CH2:±5%	CH3:±5%	CH4:±5%
输入电压范围 Input voltage range		90 ~ 132VAC/180 ~ 264VAC 由开关切换 254 ~ 370VDC 47 ~ 63Hz 90 ~ 132VAC/180 ~ 264VAC by switch 254 ~ 370VDC 47 ~ 63Hz											
冲击电流 Impact current		冷启动电流 35A/230VAC											
过载保护 Overload protection		105% ~ 150% 切断输出，自动恢复 105% ~ 150% cut off the output, automatic recovery											
过电压保护 Over voltage protection		CH1:115 ~ 135% 关闭输出，电源重启后可恢复输出 CH1:115 ~ 135% shut down O/P voltage, re-power on to recover											
启动、上升、保持时间 Setup, rise, hold up time		200ms, 50ms, 20ms/230VAC 满载 at full load											
耐压性 Withstand voltage		输入输出间：1.5kV 输入与外壳间：1.5kV 输出与外壳间：0.5kV 一分钟 I/P-O/P: 1.5kV I/P-FG: 1.5kV O/P-FG: 0.5kV 1minute											
隔离电阻 Isolation resistance		输入输出间 输入与外壳间 输出与外壳间：500VDC/100MΩ I/P-O/P I/P-FG O/P-FG: 500VDC/100MΩ											
工作温度 Working temperature		-10°C ~ +50°C											
尺寸 Dimension		199 × 110 × 50mm											
重量 Weight		0.9kg											
包装 Packing		42 × 31.5 × 26CM/20PCS/18kg											

外形尺寸 Overall dimension(mm)

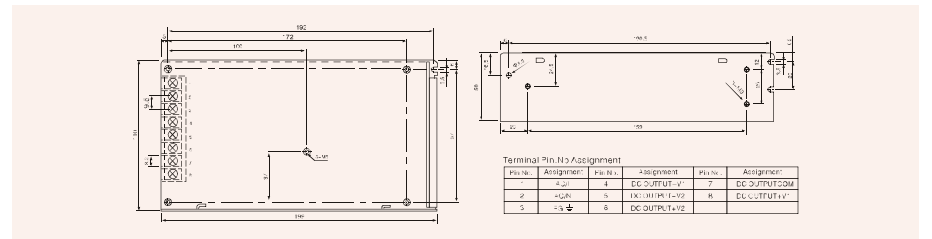

NES-15W单组输出电源
NES-15W Single output power supply

概述 Summary

- > 单组输出; 功率15W
Single output: power 15W
- > 输入电压: 85 ~ 264VAC 120 ~ 370VDC
Input voltage: 85 ~ 264VAC 120 ~ 370VDC



常见规格 General Specification

78 × 51 × 28mm

性能 Specification	型号 Model	NES-15-5	NES-15-12	NES-15-15	NES-15-24	NES-15-48
直流输出电压、电流 DC output voltage, current		5V 0~3A	12V 0~1.3A	15V 0~1A	24V 0~0.7A	48V 0~0.35A
纹波及噪音 Wave and noise		150mVp-p	150mVp-p	150mVp-p	200mVp-p	240mVp-p
进线稳定度 Inlet wire stability		± 0.5%	± 0.5%	± 0.5%	± 0.5%	± 0.5%
负载稳定度 Load stability		± 1%	± 0.5%	± 0.5%	± 0.5%	± 0.5%
效率 Efficiency		79%	81%	81%	85%	82%
直流电压可调范围 Adjustable range for DC voltage		± 10%	± 10%	± 10%	± 10%	± 10%
输入电压范围 Input voltage range		85 ~ 264VAC 120 ~ 370VDC 47 ~ 63Hz				
冲击电流 Impact current		冷启动电流 Cold start current 45A/230VAC				
过载保护 Overload protection		105% ~ 160%切断输出, 自动恢复 105% ~ 160% cut off the output, automatic recovery				
过电压保护 Over voltage protection		115% ~ 135%关闭输出, 电源重启后可恢复输出 115% ~ 135% shut down O/P voltage, re-power on to recover				
启动、上升、保持时间 Setup, rise, hold up time		800ms, 60ms, 50ms/230VAC 满负载 at full load				
耐压性 Withstand voltage		输入输出间: 1.5kV 输入与外壳间: 1.5kV 输出与外壳间: 0.5kV 一分钟 I/P-O/P: 1.5kV I/P-FG: 1.5kV O/P-FG: 0.5kV 1minute				
隔离电阻 Isolation resistance		输入输出间 输入与外壳间 输出与外壳间: 500VDC/100MΩ I/P-O/P I/P-FG O/P-FG: 500VDC/100MΩ				
工作温度 Working temperature		-10°C ~ +50°C				
尺寸 Dimension		78 × 51 × 28mm				
重量 Weight		0.18kg				
包装 Packing		35.5 × 21.3 × 35.6CM/120PCS/21.6kg				

外形尺寸 Overall dimension(mm)

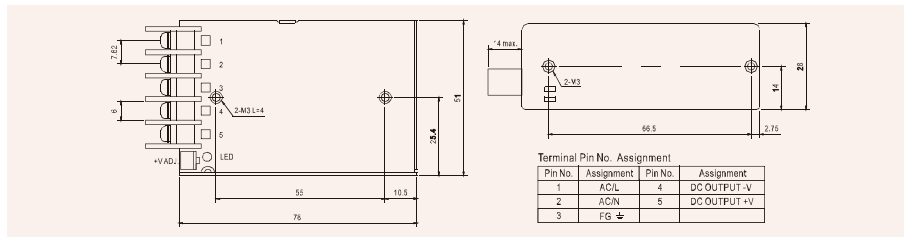

NES-25W单组输出电源
NES-25W Single output power supply

概述 Summary

- > 单组输出; 功率25W
Single output: power 25W
- > 输入电压: 85 ~ 264VAC 120 ~ 370VDC
Input voltage: 85 ~ 264VAC 120 ~ 370VDC



常见规格 General Specification

98 × 82 × 35mm

性能 Specification	型号 Model	NES-25-5	NES-25-12	NES-25-15	NES-25-24	NES-25-48
直流输出电压、电流 DC output voltage, current		5V 0~5A	12V 0~2.1A	15V 0~1.7A	24V 0~1.1A	48V 0~0.57A
纹波及噪音 Wave and noise		80mVp-p	120mVp-p	150mVp-p	200mVp-p	240mVp-p
进线稳定度 Inlet wire stability		± 0.5%	± 0.5%	± 0.5%	± 0.5%	± 0.5%
负载稳定度 Load stability		± 1%	± 0.5%	± 0.5%	± 0.5%	± 0.5%
效率 Efficiency		78%	83%	84%	86%	86%
直流电压可调范围 Adjustable range for DC voltage		± 10%	± 10%	± 10%	± 10%	± 10%
输入电压范围 Input voltage range		85 ~ 264VAC 120 ~ 370VDC 47 ~ 63Hz				
冲击电流 Impact current		冷启动电流 Cold start current 45A/230VAC				
过载保护 Overload protection		105% ~ 160%切断输出, 自动恢复 105% ~ 160% cut off the output, automatic recovery				
过电压保护 Over voltage protection		115% ~ 135%关闭输出, 电源重启后可恢复输出 115% ~ 135% shut down O/P voltage, re-power on to recover				
启动、上升、保持时间 Setup, rise, hold up time		800ms, 60ms, 50ms/230VAC 满负载 at full load				
耐压性 Withstand voltage		输入输出间: 1.5kV 输入与外壳间: 1.5kV 输出与外壳间: 0.5kV 一分钟 I/P-O/P: 1.5kV I/P-FG: 1.5kV O/P-FG: 0.5kV 1minute				
隔离电阻 Isolation resistance		输入输出间 输入与外壳间 输出与外壳间: 500VDC/100MΩ I/P-O/P I/P-FG O/P-FG: 500VDC/100MΩ				
工作温度 Working temperature		-10°C ~ +50°C				
尺寸 Dimension		98 × 82 × 35mm				
重量 Weight		0.3kg				
包装 Packing		41.5 × 22.7 × 27.8CM/60PCS/18kg				

外形尺寸 Overall dimension(mm)

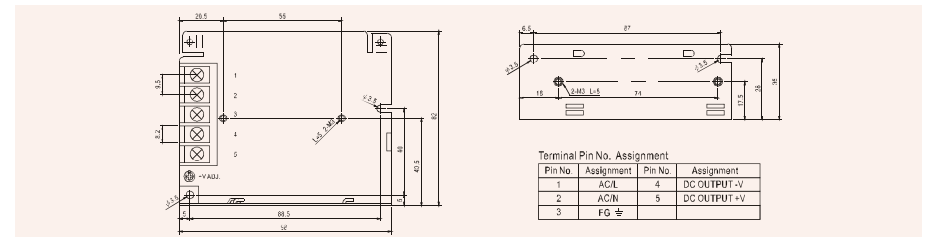

NES-35W单组输出电源
NES-35W Single output power supply

概述 Summary

- > 单组输出，功率35W
Single output: power 35W
- > 输入电压：85 ~ 264VAC 120 ~ 370VDC
Input voltage: 85 ~ 264VAC 120 ~ 370VDC



常见规格 General Specification

98 × 97 × 35mm

性能 Specification	型号 Model	NES-35-5	NES-35-12	NES-35-15	NES-35-24	NES-35-48
直流输出电压、电流 DC output voltage, current		5V 0~7A	12V 0~3A	15V 0~2.4A	24V 0~1.5A	48V 0~0.8A
纹波及噪音 Wave and noise		80mVp-p	120mVp-p	150mVp-p	200mVp-p	240mVp-p
进线稳定度 Inlet wire stability		± 0.5%	± 0.5%	± 0.5%	± 0.5%	± 0.5%
负载稳定度 Load stability		± 1%	± 0.5%	± 0.5%	± 0.5%	± 0.5%
效率 Efficiency		78%	81%	83%	85%	86%
直流电压可调范围 Adjustable range for DC voltage		± 10%	± 10%	± 10%	± 10%	± 10%
输入电压范围 Input voltage range		85 ~ 264VAC 120 ~ 370VDC 47 ~ 63Hz				
冲击电流 Impact current		冷启动电流 Cold start current 45A/230VAC				
过载保护 Overload protection		105% ~ 160% 切断输出, 自动恢复 105% ~ 160% cut off the output, automatic recovery				
过电压保护 Over voltage protection		115% ~ 135% 关闭输出, 电源重启后可恢复输出 115% ~ 135% shut down O/P voltage, re-power on to recover				
启动、上升、保持时间 Setup, rise, hold up time		800ms, 60ms, 50ms/230VAC 满负载 at full load				
耐压性 Withstand voltage		输入输出间: 1.5kV 输入与外壳间: 1.5kV 输出与外壳间: 0.5kV 一分钟 I/P-O/P: 1.5kV I/P-FG: 1.5kV O/P-FG: 0.5kV 1minute				
隔离电阻 Isolation resistance		输入输出间 输入与外壳间 输出与外壳间: 500VDC/100MΩ I/P-O/P I/P-FG O/P-FG: 500VDC/100MΩ				
工作温度 Working temperature		-10°C ~ +50°C				
尺寸 Dimension		98 × 97 × 35mm				
重量 Weight		0.36kg				
包装 Packing		43 × 32.5 × 24CM/60PCS/21.6kg				

外形尺寸 Overall dimension(mm)

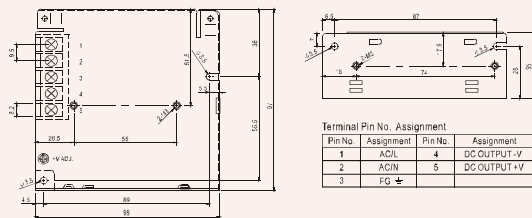

NES-50W单组输出电源
NES-50W Single output power supply

概述 Summary

- > 单组输出，功率50W
Single output: power 50W
- > 输入电压：85 ~ 264VAC 120 ~ 370VDC
Input voltage: 85 ~ 264VAC 120 ~ 370VDC



常见规格 General Specification

129 × 98 × 38mm

性能 Specification	型号 Model	NES-50-5	NES-50-12	NES-50-15	NES-50-24	NES-50-48
直流输出电压、电流 DC output voltage, current		5V 0~10A	12V 0~4.2A	15V 0~3.4A	24V 0~2.2A	48V 0~1.1A
纹波及噪音 Wave and noise		80mVp-p	120mVp-p	150mVp-p	200mVp-p	240mVp-p
进线稳定度 Inlet wire stability		± 0.5%	± 0.5%	± 0.5%	± 0.5%	± 0.5%
负载稳定度 Load stability		± 1%	± 0.5%	± 0.5%	± 0.5%	± 0.5%
效率 Efficiency		79%	82%	83%	86%	87%
直流电压可调范围 Adjustable range for DC voltage		± 10%	± 10%	± 10%	± 10%	± 10%
输入电压范围 Input voltage range		85 ~ 264VAC 120 ~ 370VDC 47 ~ 63Hz				
冲击电流 Impact current		冷启动电流 Cold start current 45A/230VAC				
过载保护 Overload protection		105% ~ 160% 切断输出, 自动恢复 105% ~ 160% cut off the output, automatic recovery				
过电压保护 Over voltage protection		115% ~ 135% 关闭输出, 电源重启后可恢复输出 115% ~ 135% shut down O/P voltage, re-power on to recover				
启动、上升、保持时间 Setup, rise, hold up time		800ms, 60ms, 50ms/230VAC 满负载 at full load				
耐压性 Withstand voltage		输入输出间: 1.5kV 输入与外壳间: 1.5kV 输出与外壳间: 0.5kV 一分钟 I/P-O/P: 1.5kV I/P-FG: 1.5kV O/P-FG: 0.5kV 1minute				
隔离电阻 Isolation resistance		输入输出间 输入与外壳间 输出与外壳间: 500VDC/100MΩ I/P-O/P I/P-FG O/P-FG: 500VDC/100MΩ				
工作温度 Working temperature		-10°C ~ +50°C				
尺寸 Dimension		129 × 98 × 38mm				
重量 Weight		0.41kg				
包装 Packing		43 × 32.5 × 24CM/45PCS/18.5kg				

外形尺寸 Overall dimension(mm)

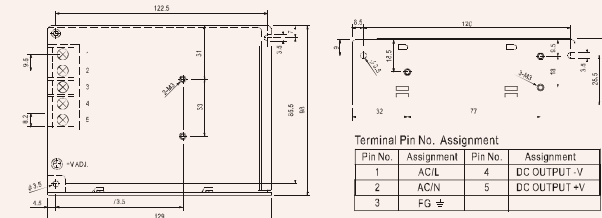

NES-75W单组输出电源
NES-75W Single output power supply

概述 Summary

- > 单组输出，功率75W
Single output: power 75W
- > 输入电压：85 ~ 264VAC 120 ~ 370VDC
Input voltage: 85 ~ 264VAC 120 ~ 370VDC



常见规格 General Specification

159 × 98 × 38mm

性能 Specification	型号 Model	NES-75-5	NES-75-12	NES-75-15	NES-75-24	NES-75-48
直流输出电压、电流 DC output voltage, current		5V 0~14A	12V 0~6.2A	15V 0~5A	24V 0~3.2A	48V 0~1.6A
纹波及噪音 Wave and noise		80mVp-p	120mVp-p	150mVp-p	200mVp-p	240mVp-p
进线稳定度 Inlet wire stability		± 0.5%	± 0.5%	± 0.5%	± 0.5%	± 0.5%
负载稳定度 Load stability		± 1%	± 0.5%	± 0.5%	± 0.5%	± 0.5%
效率 Efficiency		77%	82%	83%	86%	87%
直流电压可调范围 Adjustable range for DC voltage		± 10%	± 10%	± 10%	± 10%	± 10%
输入电压范围 Input voltage range		85 ~ 264VAC 120 ~ 370VDC 47 ~ 63Hz				
冲击电流 Impact current		冷启动电流 45A/230VAC Cold start current				
过载保护 Overload protection		105% ~ 160%切断输出, 自动恢复 105% ~ 160% cut off the output, automatic recovery				
过电压保护 Over voltage protection		115% ~ 135%关闭输出, 电源重启后可恢复输出 115% ~ 135% shut down O/P voltage, re-power on to recover				
启动、上升、保持时间 Setup, rise, hold up time		800ms, 60ms, 50ms/230VAC 满载 at full load				
耐压性 Withstand voltage		输入输出间: 1.5kV 输入与外壳间: 1.5kV 输出与外壳间: 0.5kV 一分钟 I/P-O/P: 1.5kV I/P-FG: 1.5kV O/P-FG: 0.5kV 1minute				
隔离电阻 Isolation resistance		输入输出间 输入与外壳间 输出与外壳间: 500VDC/100MΩ I/P-O/P I/P-FG O/P-FG: 500VDC/100MΩ				
工作温度 Working temperature		-10°C ~ +50°C				
尺寸 Dimension		159 × 98 × 38mm				
重量 Weight		0.52kg				
包装 Packing		34 × 32 × 24CM/30PCS/16kg				

外形尺寸 Overall dimension(mm)

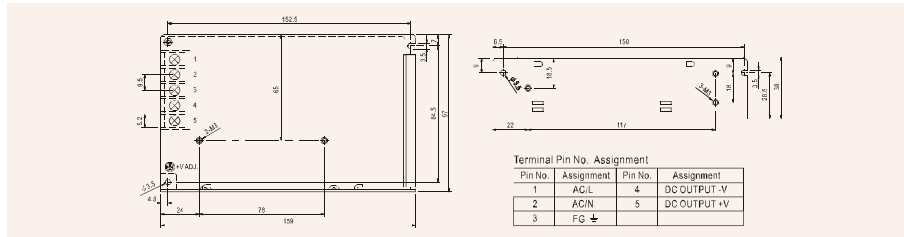

NES-100W单组输出电源
NES-100W Single output power supply

概述 Summary

- > 单组输出，功率100W
Single output: power 100W
- > 输入电压：90 ~ 132VAC/180 ~ 264VAC 由开关切换
Input voltage: 90 ~ 132VAC/180 ~ 264VAC by switch



常见规格 General Specification

159 × 98 × 38mm

性能 Specification	型号 Model	NES-100-5	NES-100-12	NES-100-15	NES-100-24	NES-100-48
直流输出电压、电流 DC output voltage, current		5V 0~20A	12V 0~8.5A	15V 0~7A	24V 0~4.5A	48V 0~2.3A
纹波及噪音 Wave and noise		80mVp-p	120mVp-p	120mVp-p	120mVp-p	150mVp-p
进线稳定度 Inlet wire stability		± 0.5%	± 0.5%	± 0.5%	± 0.5%	± 0.5%
负载稳定度 Load stability		± 1%	± 0.5%	± 0.5%	± 0.5%	± 0.5%
效率 Efficiency		80%	83%	84%	86%	86%
直流电压可调范围 Adjustable range for DC voltage		± 10%				
输入电压范围 Input voltage range		90 ~ 132VAC/180 ~ 264VAC 由开关切换 254 ~ 370VDC 47 ~ 63Hz 90 ~ 132VAC/180 ~ 264VAC by switch 254 ~ 370VDC 47 ~ 63Hz				
冲击电流 Impact current		冷启动电流 45A/230VAC Cold start current				
过载保护 Overload protection		105% ~ 160%切断输出, 自动恢复 105% ~ 160% cut off the output, automatic recovery				
过电压保护 Over voltage protection		115% ~ 135%关闭输出, 电源重启后可恢复输出 115% ~ 135% shut down O/P voltage, re-power on to recover				
启动、上升、保持时间 Setup, rise, hold up time		800ms, 60ms, 50ms/230VAC 满载 at full load				
耐压性 Withstand voltage		输入输出间: 1.5kV 输入与外壳间: 1.5kV 输出与外壳间: 0.5kV 一分钟 I/P-O/P: 1.5kV I/P-FG: 1.5kV O/P-FG: 0.5kV 1minute				
隔离电阻 Isolation resistance		输入输出间 输入与外壳间 输出与外壳间: 500VDC/100MΩ I/P-O/P I/P-FG O/P-FG: 500VDC/100MΩ				
工作温度 Working temperature		-10°C ~ +50°C				
尺寸 Dimension		159 × 98 × 38mm				
重量 Weight		0.55kg				
包装 Packing		34 × 32 × 24CM/30PCS/16.5kg				

外形尺寸 Overall dimension(mm)

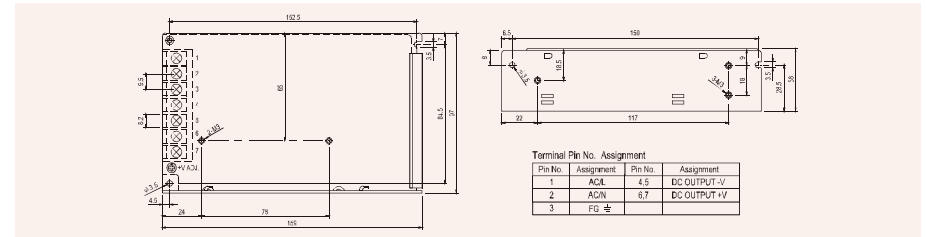

NES-150W单组输出电源
NES-150W Single output power supply

概述 Summary

- > 单组输出：功率150W
Single output: power 150W
- > 输入电压：90 ~ 132VAC/180 ~ 264VAC 由开关切换
Input voltage: 90 ~ 132VAC/180 ~ 264VAC by switch



常见规格 General Specification

199 × 98 × 38mm

性能 Specification	型号 Model	NES-150-5	NES-150-12	NES-150-15	NES-150-24	NES-150-48
直流输出电压、电流 DC output voltage, current		5V 0~30A	12V 0~12.5A	15V 0~10A	24V 0~6.5A	48V 0~3.3A
纹波及噪音 Wave and noise		80mVp-p	120mVp-p	120mVp-p	120mVp-p	150mVp-p
进线稳定度 Inlet wire stability		± 0.5%	± 0.5%	± 0.5%	± 0.5%	± 0.5%
负载稳定度 Load stability		± 1%	± 0.5%	± 0.5%	± 0.5%	± 0.5%
效率 Efficiency		78%	83%	84%	86%	86%
直流电压可调范围 Adjustable range for DC voltage		± 10%	± 10%	± 10%	± 10%	± 10%
输入电压范围 Input voltage range		90 ~ 132VAC/180 ~ 264VAC 由开关切换 254 ~ 370VDC 47 ~ 63Hz 90 ~ 132VAC/180 ~ 264VAC by switch 254 ~ 370VDC 47 ~ 63Hz				
冲击电流 Impact current	冷启动电流 Cold start current	45A/230VAC				
过载保护 Overload protection	105% ~ 160% 切断输出, 自动恢复 105% ~ 160% cut off the output, automatic recovery					
过电压保护 Over voltage protection	115% ~ 135% 关闭输出, 电源重启后可恢复输出 115% ~ 135% shut down O/P voltage, re-power on to recover					
启动、上升、保持时间 Setup, rise, hold up time	800ms, 60ms, 50ms/230VAC 满负载 at full load					
耐压性 Withstand voltage	输入输出间: 1.5kV 输入与外壳间: 1.5kV 输出与外壳间: 0.5kV 一分钟 I/P-O/P: 1.5kV I/P-FG: 1.5kV O/P-FG: 0.5kV 1minute					
隔离电阻 Isolation resistance	输入输出间 输入与外壳间 输出与外壳间: 500VDC/100MΩ I/P-O/P I/P-FG O/P-FG: 500VDC/100MΩ					
工作温度 Working temperature	-10°C ~ +50°C					
尺寸 Dimension	199 × 98 × 38mm					
重量 Weight	0.7kg					
包装 Packing	43 × 32.5 × 24CM/30PCS/21kg					

外形尺寸 Overall dimension(mm)

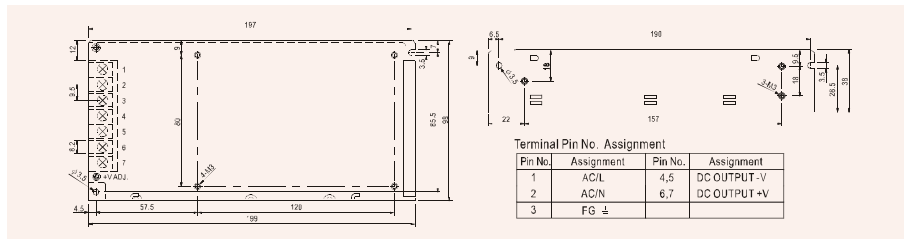

NES-200W单组输出电源
NES-200W Single output power supply

概述 Summary

- > 单组输出：功率200W
Single output: power 200W
- > 输入电压：90 ~ 132VAC/180 ~ 264VAC 由开关切换
Input voltage: 90 ~ 132VAC/180 ~ 264VAC by switch



常见规格 General Specification

215 × 115 × 50mm

性能 Specification	型号 Model	NES-200-5	NES-200-12	NES-200-15	NES-200-24	NES-200-27	NES-200-36	NES-200-48
直流输出电压、电流 DC output voltage, current		5V 0~40A	12V 0~17A	15V 0~14A	24V 0~8.8A	27V 0~7.8A	36V 0~5.9A	48V 0~4.4A
纹波及噪音 Wave and noise		150mVp-p	150mVp-p	150mVp-p	150mVp-p	200mVp-p	240mVp-p	240mVp-p
进线稳定度 Inlet wire stability		± 0.5%	± 0.5%	± 0.5%	± 0.5%	± 0.5%	± 0.5%	± 0.5%
负载稳定度 Load stability		± 1%	± 0.5%	± 0.5%	± 0.5%	± 0.5%	± 0.5%	± 0.5%
效率 Efficiency		78%	83%	84%	86%	86%	86%	86%
直流电压可调范围 Adjustable range for DC voltage		± 10%	± 10%	± 10%	± 10%	± 10%	± 10%	± 10%
输入电压范围 Input voltage range		90 ~ 132VAC/180 ~ 264VAC 由开关切换 254 ~ 370VDC 47 ~ 63Hz 90 ~ 132VAC/180 ~ 264VAC by switch 254 ~ 370VDC 47 ~ 63Hz						
冲击电流 Impact current	冷启动电流 Cold start current	40A/115VAC 55A/230VAC						
过载保护 Overload protection	105% ~ 160% 切断输出, 自动恢复 105% ~ 160% cut off the output, automatic recovery							
过电压保护 Over voltage protection	115% ~ 135% 关闭输出, 电源重启后可恢复输出 115% ~ 135% shut down O/P voltage, re-power on to recover							
启动、上升、保持时间 Setup, rise, hold up time	800ms, 60ms, 50ms/230VAC 满负载 at full load							
耐压性 Withstand voltage	输入输出间: 1.5kV 输入与外壳间: 1.5kV 输出与外壳间: 0.5kV 一分钟 I/P-O/P: 1.5kV I/P-FG: 1.5kV O/P-FG: 0.5kV 1minute							
隔离电阻 Isolation resistance	输入输出间 输入与外壳间 输出与外壳间: 500VDC/100MΩ I/P-O/P I/P-FG O/P-FG: 500VDC/100MΩ							
工作温度 Working temperature	-10°C ~ +50°C							
尺寸 Dimension	215 × 115 × 50mm							
重量 Weight	0.93kg							
包装 Packing	48 × 31.5 × 26CM/20PCS/19kg							

外形尺寸 Overall dimension(mm)

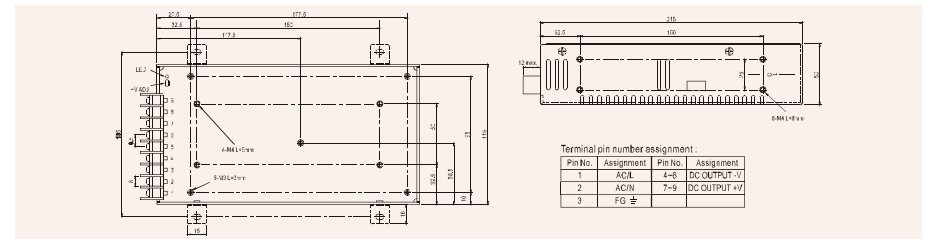

概述 Summary

- > 单组输出，功率350W
Single output: power 350W
- > 输入电压：90 ~ 132VAC/160 ~ 264VAC 由开关切换
Input voltage: 90 ~ 132VAC/160 ~ 264VAC by switch



常见规格 General Specification

215 x 115 x 50mm

性能 Specification	型号 Model	NES-350-5	NES-350-12	NES-350-15	NES-350-24	NES-350-27	NES-350-36	NES-350-48	NES-350-60	NES-350-70	NES-350-110
直流输出电压、电流 DC output voltage, current		5V 0~60A	12V 0~29A	15V 0~23.2A	24V 0~14.6A	27V 0~13A	36V 0~9.7A	48V 0~7.3A	60V 0~5.83A	70V 0~5A	110V 0~318A
纹波及噪音 Wave and noise		150mVp-p	150mVp-p	150mVp-p	150mVp-p	200mVp-p	240mVp-p	240mVp-p	240mVp-p	240mVp-p	240mVp-p
进线稳定度 Inlet wire stability		±0.5%	±0.5%	±0.5%	±0.5%	±0.5%	±0.5%	±0.5%	±0.5%	±0.5%	±0.5%
负载稳定度 Load stability		±1%	±0.5%	±0.5%	±0.5%	±0.5%	±0.5%	±0.5%	±0.5%	±0.5%	±0.5%
效率 Efficiency		78%	83%	84%	87%	87%	87%	87%	87%	87%	87%
直流电压可调范围 Adjustable range for DC voltage		±10%	±10%	±10%	±10%	±10%	±10%	±10%	±10%	±10%	±10%
输入电压范围 Input voltage range		90 ~ 132VAC/160 ~ 264VAC 由开关切换 254 ~ 370VDC 47 ~ 63Hz 90 ~ 132VAC/160 ~ 264VAC by switch 254 ~ 370VDC 47 ~ 63Hz									
冲击电流 Impact current		冷启动电流 Cold start current 40A/115VAC 60A/230VAC									
过载保护 Overload protection		105% ~ 160% 切断输出，自动恢复 105% ~ 160% cut off the output, automatic recovery									
过电压保护 Over voltage protection		115% ~ 135% 关闭输出，电源重启后可恢复输出 115% ~ 135% shut down O/P voltage, re-power on to recover									
启动、上升、保持时间 Setup, rise, hold up time		800ms, 60ms, 50ms/230VAC 满载 at full load									
耐压性 Withstand voltage		输入输出间: 1.5kV 输入与外壳间: 1.5kV 输出与外壳间: 0.5kV 一分钟 I/P-O/P: 1.5kV I/P-FG: 1.5kV O/P-FG: 0.5kV 1minute									
隔离电阻 Isolation resistance		输入输出间 输入与外壳间 输出与外壳间: 500VDC/100MΩ I/P-O/P I/P-FG O/P-FG: 500VDC/100MΩ									
工作温度 Working temperature		-10°C ~ +50°C									
尺寸 Dimension		215 x 115 x 50mm									
重量 Weight		1kg									
包装 Packing		48 x 31.5 x 26CM/20PCS/20kg									

外形尺寸 Overall dimension(mm)

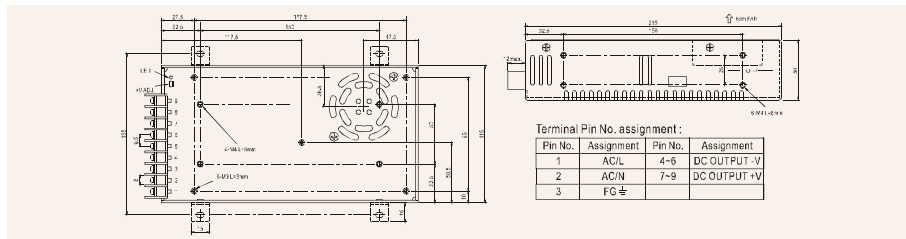

单组输出		双组输出		三组输出		四组输出	
输出电压	输出电流范围	输出电压	输出电流范围	输出电压	输出功率范围	输出电压	输出功率范围
3V	1A ~ 60A	±3V	1A ~ 15A	5V, ±12V	20W ~ 150W	±5V, ±12V	60W ~ 150W
5V	1A ~ 60A	±5V	1A ~ 15A	5V, ±15V	20W ~ 150W	±5V, ±15V	60W ~ 150W
7.5V	0.5A ~ 60A	±7.5V	0.5A ~ 20A	5V, ±24V	20W ~ 150W	±5V, ±24V	60W ~ 150W
9V	0.5A ~ 60A	±12V	0.4A ~ 15A	5V, ±36V	20W ~ 150W	±5V, ±36V	60W ~ 150W
12V	0.5A ~ 60A	±15V	0.6A ~ 12A	5V, ±48V	20W ~ 150W	±5V, ±48V	60W ~ 150W
13.5V	0.5A ~ 60A	±24V	0.5A ~ 7A	5V, 12V, 24V	20W ~ 150W	5V, ±12V, 15V	60W ~ 150W
15V	0.5A ~ 60A	±36V	0.3A ~ 5A	5V, 12V, 15V	20W ~ 150W	5V, ±12V, 24V	60W ~ 150W
18V	0.5A ~ 60A	±48V	0.2A ~ 4A	±5V, 12V	20W ~ 150W	5V, ±15V, 12V	60W ~ 150W
24V	0.4A ~ 50A	±110V	0.1A ~ 1.5A	±5V, 15V	20W ~ 150W	5V, ±15V, 24V	60W ~ 150W
27V	0.4A ~ 45A	5V, 12V	15W ~ 150W	±5V, 24V	20W ~ 150W		
36V	0.4A ~ 35A	5V, 15V	15W ~ 150W	5V, 15V, 24V	20W ~ 150W	5V, 12V, ±15V	60W ~ 150W
48V	0.2A ~ 35A	5V, 24V	15W ~ 150W	其它电压定制	20W ~ 150W	5V, 12V, ±24V	60W ~ 150W
110V	0.1A ~ 10A	5V, 48V	15W ~ 150W			5V, 15V, ±24V	60W ~ 150W
220V	0.1A ~ 5A	12V, 24V	15W ~ 150W			12V, ±24V	60W ~ 150W
其它电压定制		12V, 36V	15W ~ 150W				

- 如需其他电压或参数，请来电咨询
- 本手册所有内容如有改动，恕不另行通知
- 本手册所有内容解释权属伟豪公司所有

- > 10W ~ 1500W 功率
- > 数百种产品可供选择
- > AC/DC, DC/DC
- > 5V, 12V, 24V 输出备有大量现货供应
- > 特规产品 1-2 天交货。

- > 专注于以下行业的配套
- > LED 显示屏
- > 工控自动化
- > 仪表及通信
- > 智能楼宇